

NOTE:
 RATING
 *VOLTAGE RATING: 30V AC (Rms)
 *CURRENT RATING: 1.5A MAX
 ELECTRICAL CHARACTERISTICS
 *CONTACT RESISTANCE: 30mΩ MAX
 *INSULATION RESISTANCE: 1000MΩ MIN
 *DIELECTRIC WITHSTANDING VOLTAGE: 500V AC AT 1minute

MATERIALS
 *TERMINAL: Brass Plating Nickel before Plating Gold Tin.
 *HOUSING: PBT.
 *SHELL: Brass & SPCC Plating Nickel.
 *TERMINALS: Gold Plating : G/F 3U" 5U" 10" 15U" 30U" 50U"
 *PART MUST COMPLY ZYZ ROHS SPECIFICATION.

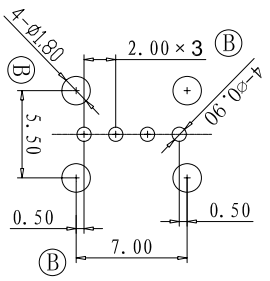

SUGGESTED PCB LAYOUT
 GENERAL TOLERANCE: ± 0.05

D		修改外壳侧面弹片	2012. 05. 19
C		修改外壳脚尺寸	2011. 11. 20
B		修改PCB LAYOUT尺寸	2011. 07. 26
REV.	ECN NO.	LOCATION	DATE

品名ARTICLE: USB-A 母 90° 侧立直插式(新) 料号P/N:			
设计DES: D:	日期DATE	单位UNIT: MM	版本REV: D
审核CHK: D:	日期DATE	英码SHEET: 1/1	比例SCALE: N/A
批准APPV: D:	日期DATE	材质MATERIAL:	
		表面处理FINISHING:	
		图号MODEL:	