

NOTES:
 Housing: Thermoplastics, UL94V-0
 Contact: Copper Alloy
 Shell: Copper Alloy/Steel
 Voltage Current Rating: 1.5 AMP, 30V AC
 Insulation Resistance: 1000MΩ Min.
 Contact Resistance: 30 MΩ Max.
 Dielectric Withstanding Voltage: 500W AC
 Temperature Range: -55° C to +85° C
 Insulator color: Black/White
 Plastic material: PBT/LCP
 Shell finish: Nickel plated/Tin-Lead plated
 Contact finish:
 01: Selective Gold Flash
 02: Selective Gold 3U"
 03: Selective Gold 5U"
 04: Selective Gold 15U"
 05: Selective Gold 30U"

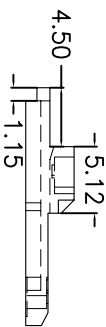
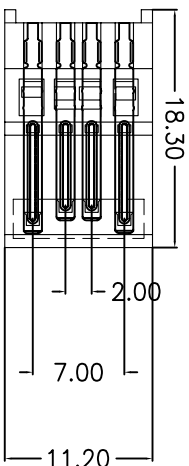
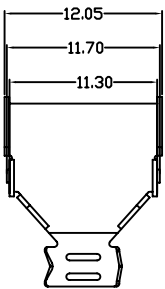
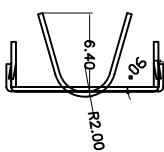
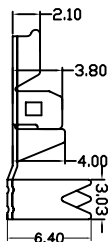
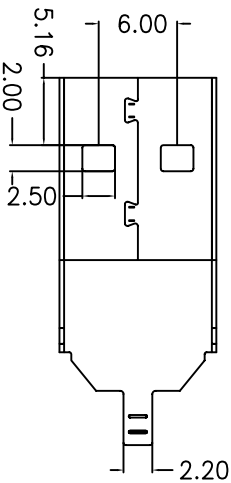
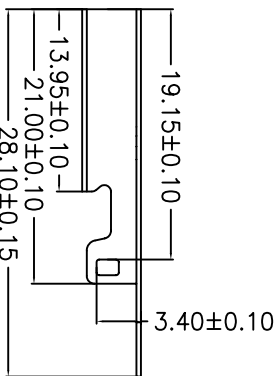
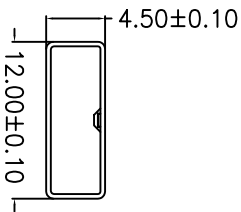

目錄 MAPX	變更內容 MODIFICATION	日期 DATE
A0	NEW	09-10-20

产品图

PRODUCT CHART DWG

公差一览表 TOLERANCE UNLESS OTHERWISE		单位 UNITS	制图 DRAWING	产品料号 PRODUCT PART NO.
X	±0.15	MM	黄陈平	USB AM短体28MM三件套0D4.0
X	±0.10	MM	审核 CHKD	
XX	±0.05	MM	核准 APPD	
XXX	±0.03	MM		

比例 SCALE	日期 DATE	核准 APPD	角法 VIEW	版本 VER
1:1	2009/10/20			A0