

MAPX	MODIFICATION	DATE
------	--------------	------

NOTES:

1. HOUSING: SEE NOTES.
 TERMINAL: SEE NOTES.
 SELL: SEE NOTES.

SPECIFICATION:

- ELECTRICAL CHARACTERISTIC:
 CONTACT RESISTANCE: 30MΩ MAX
 DIELECTRIC WITHSTANDING VOLTAGE: 500V AC FOR 1MIN
 INSULATION RESISTANCE: 1000MΩ MIN
- MECHANICAL CHARACTERISTIC:
 INSERTION FORCE: 35N(3.57KGF) MAX
 EXTRACTION FORCE: 10*35N(1.02*3.57KGF) MIN
 DURABILITY: 1500 CYCLES EXTRACTION FORCE: 10*35N
 3000 CYCLES MIN
 5000 CYCLES EXTRACTION FORCE: 3*35N
- ENVIRONMENTAL:
 OPERATING TEMPERATURE: -55°C~85°C
- Contact finish:
 01: Selective Gold Flash
 02: Selective Gold 30"
 03: Selective Gold 50"
 04: Selective Gold 150"
 05: Selective Gold 300"

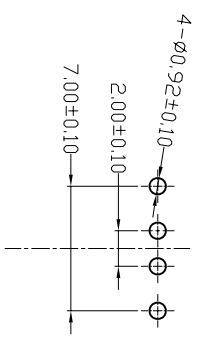
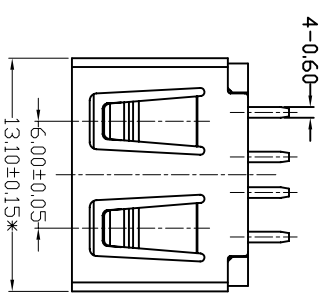

FRONT EDGE OF CONNECTOR
PCB LAYOUT

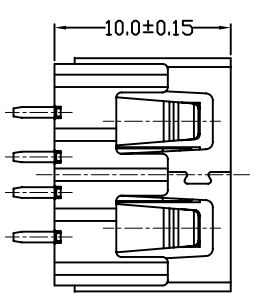
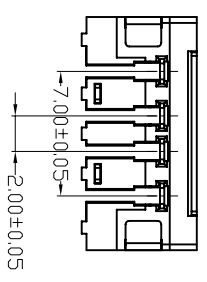
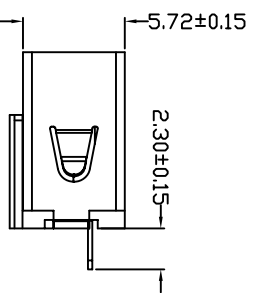
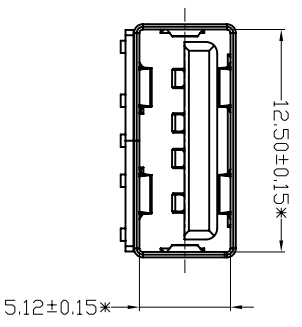
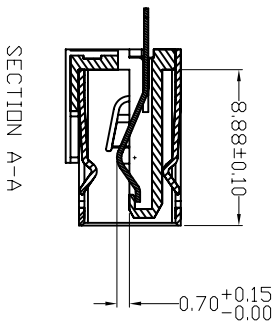

产品图
公差一览表

TOLERANCE UNLESS OTHERWISE	单位	制图	制图料号
X: ±0.25	MM	审核	PRODUCT PART NO.
X: ±0.20	1:1	审核	产品名称
XX: ±0.15		核准	PRODUCT NO.
XXX: ±0.10			角法
			VER
			版本
			AD

DATE	2012.06.15	DATE	
SCALE	1:1	SCALE	
UNITS	MM	UNITS	

