

| | | |
|------|--------------|------|
| MAPX | MODIFICATION | DATE |
| | | |

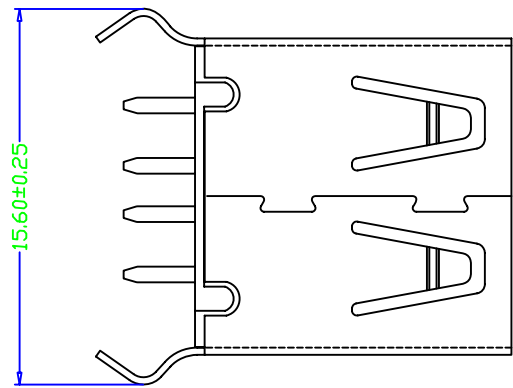
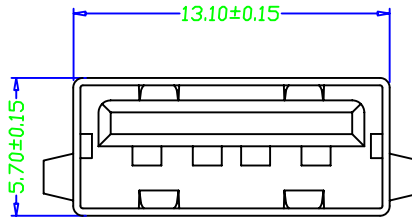
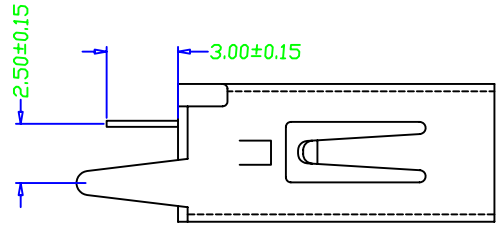
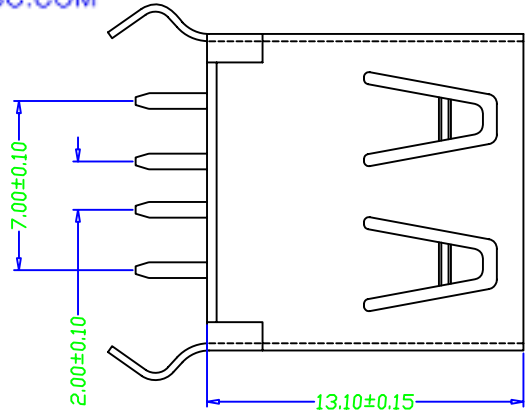

NOTES:

- 1. HOUSING: SEE NOTES, UL94V-0 .
- TERMINAL: SEE NOTES.
- SHELL: SEE NOTES.

SPECIFICATION:

- 1. ELECTRICAL CHARACTERISTIC:
 - CONTACT RESISTANCE: 30MΩ MAX
 - DIELECTRIC WITHSTANDING VOLTAGE: 500V AC FOR 1MIN
 - INSULATION RESISTANCE: 1000MΩ MIN
- 2. MECHANICAL CHARACTERISTIC:
 - INSERTION FORCE: 35N(3.57KGF) MAX
 - EXTRACTION FORCE: 10~35N(1.02~3.57KGF)MIN
 - DURABILITY: 1500 CYCLES EXTRACTION FORCE:10~35N
5000 CYCLES MIN
5000 CYCLES EXTRACTION FORCE:3~35N

3. ENVIRONMENTAL:

OPERATING TEMPERATURE: -55°C+85°C

4. Contact finish:

- 01:Selective Gold Flash
- 02:Selective Gold 3U"
- 03:Selective Gold 5U"
- 04:Selective Gold 15U"
- 05:Selective Gold 30U"

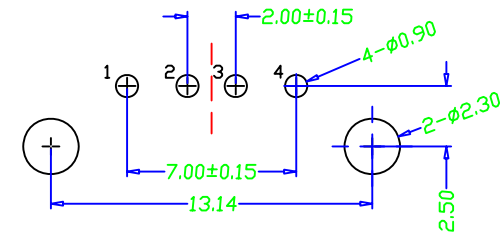

PCB LAYOUT

| | | | | | | | | | | |
|-------------------------------------|-------|------|--------|-------|------------|---------|-------|------------------|--------------------------|----|
| 产品图 PRODUCT CHART DWG | | | | | | | | | | |
| 公差一览表 TOLERANCE UNLESS OTHERWISE | | | | 单位 | MM | 制图 | Z-Y-B | 制图料号 | | |
| X. | ±0.25 | X. | ±5.° | UNITS | | DRAWING | | PRODUCT PART NO. | | |
| .X | ±0.20 | .X | ±2.° | 比例 | 1:1 | 审核 | | 产品名称 | USB A/F 180度插板式无边 (13.1) | |
| .XX | ±0.15 | .XX | ±1.° | SCALE | | CHKD | | PRODUCT NO. | | |
| .XXX | ±0.10 | .XXX | ±0.5.° | 日期 | 2014.07.24 | 核准 | | 角法 | 版本 | AD |
| | | | | DATE | | APPD | | VIEW | VER | |