

Data Sheet

360271

Page 1/4

P/N

360271

2014/12/12

Illustration

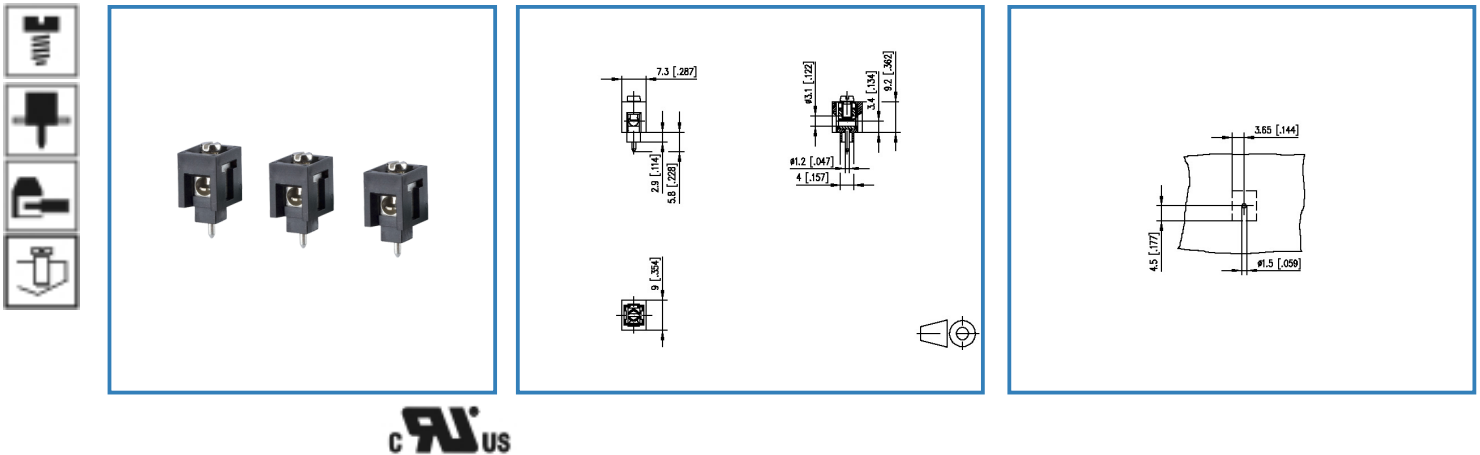

see enlarged drawing at the end of the document

Product specification

- screw type terminal block, solderable
- direction of connection 90°
- wire protector
- color black
- with molded housing, single solder pin, screw brought down by hand (transport safety)
- Connection data

RIA US V / A / AWG 50 / 15 / 24 - 14

Data Sheet

360271

Page 2/4

P/N

360271

2014/12/12

Technical Data

General Data

| | | | |
|---------------------------|---------|------|--------|
| Tightening torque SEV | 0.5 Nm | | |
| Tightening torque UL | 7 lb-in | | |
| Solder pin length | 2.9 mm | | |
| min. number of poles | 1 | | |
| max. number of poles | 1 | | |
| Insulating material class | CTI 600 | | |
| Overvoltage category | III | III | II |
| Pollution degree | 3 | 2 | 2 |
| Rated test voltage | 0.8 kV | 4 kV | 2.5 kV |

Connection data

| | |
|---|-------------------|
|  V / A / AWG | 50 / 15 / 24 - 14 |
|---|-------------------|

Material

| | |
|-------------------------|---------------------|
| terminal body material | CuZn |
| terminal body surface | Ni + Sn |
| screw surface | Zn Cr(VI)-frei/free |
| wire protector material | CuNi18 |
| screw thread | M3 |

Climatic properties

| | |
|-------------------------|--------|
| upper limit temperature | 105 °C |
| lower limit temperature | -40 °C |

General

| | |
|---------------|-------------------------------------|
| solderability | Acc. to JEDEC JESD22-B102E 245°C/5s |
| Tolerance | ISO 2768 -mH |

Data Sheet

360271

Page 3/4

P/N

360271

2014/12/12

Illustration

Drawing

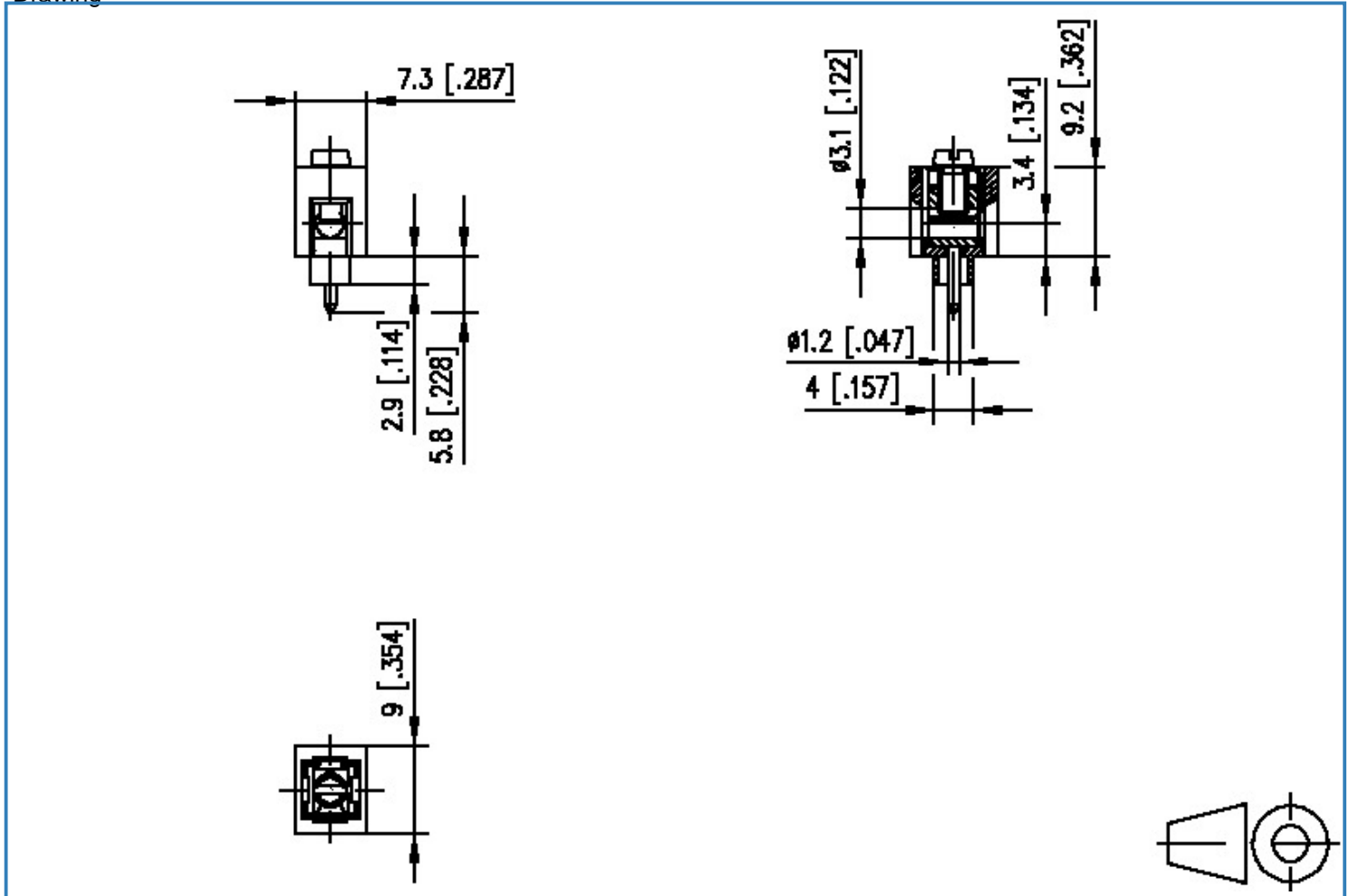

Data Sheet

360271

Page 4/4

P/N

360271

2014/12/12

PCB Layout

