

- NOTE:
- 1.Rating: 24V 25mA DC
  2. Insulation Resistance:  $\geq 100 \text{ M}\Omega$
  3. Withstand voltage: AC 500V 1Minute
  4. Operating Force Range: 400gf Max
  5. Mechanical Life: 3,000 Cycles
  6. Operating Temperature range  $-20^{\circ}\sim+70^{\circ}\text{C}$
  7. Ambient Humidity used:  $\leq 85\% \text{RH}$

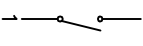

Circuit Diagram

PCB Layout(Pattern Side)

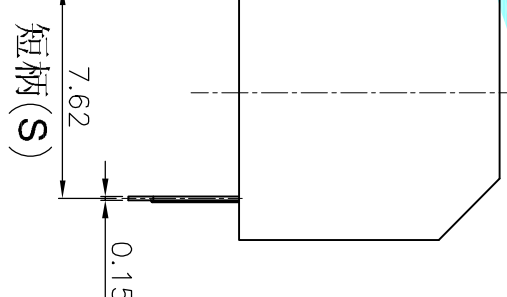
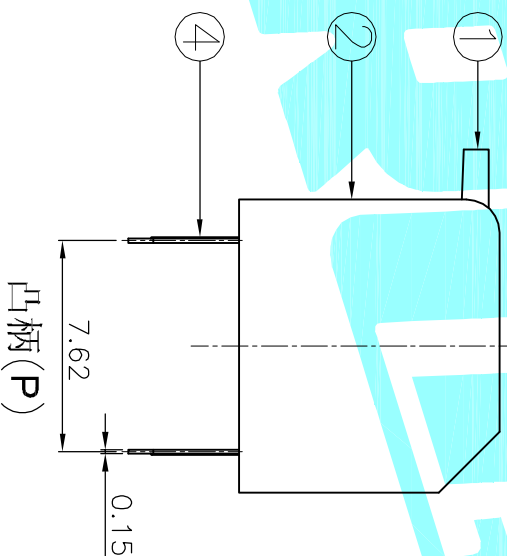
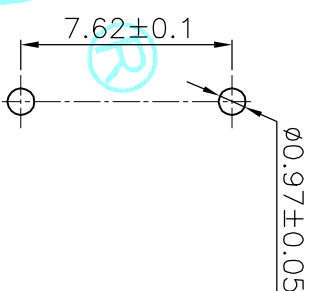

Position(位数)		1P
PART NO:	凸柄(P)	DP-01RP
盖子/红色(R)	短柄(S)	DP-01RS
PART NO:	凸柄(P)	DP-01BP
盖子/蓝色(B)	短柄(S)	DP-01BS

ITEM	PART NAME	TER'NO.	QTY.	MATERIAL	FINISHING	REMARK
⑤	Gum Water	—	—	Epicote	Black	—
④	Terminal	—	2	Phosphor bronze	Au Plating	—
③	Base	—	1	PBT	Black	—
②	Cover	—	1	PBT	Red/Blue	—
①	Keystroke	—	1	PBT	White	—

APPROVALS		DATE
DRAWN	J.X.Zhang	2013/11/8

CHECKED		TITLE:	MULTIFUNCTIONAL SWITCHES	
APPROVALS		PART NO.	DP-01□□	
TOLERANCES ARE	30 $\mu$ m以上 10 $\sim$ 30 5 $\sim$ 10 ~5	±0.30 ±0.20 ±0.15 ±0.10	ANGLE	±2°
		UNIT: mm	SCALE: 1:1	PROJ:
		DRAWING NO.		SHEET 1 OF 1

ECN NO.	REV.	DATE.	DESCRIPTION.	CHANGE.	CHECK.	APPRO.
	A		NEW			

**HRP**  
ELECTRONICS CO.,LTD