

Surface Mount Schottky Barrier rectifiers

Using the Schottky Barrier principle with a Molybdenum barrier meta. These state-of-the-art geometry features epitaxial construction with oxide passivation and metal overlay contact. Ideally suited for low voltage, high frequency rectification, or as free wheeling and polarity protection diodes, in surface mount applications where compact size and weight are critical to the system.

- * Low Forward Voltage.
- * Low Switching noise.
- * High Current Capacity
- * Guarantee Reverse Avalanche.
- * Guard-Ring for Stress Protection.
- * Low Power Loss & High efficiency.
- * 150 Operating Junction Temperature
- * Low Stored Charge Majority Carrier Conduction.
- * Plastic Material used Carries Underwriters Laboratory Flammability Classification 94V-O
- * Moisture Sensitivity Level: MSL-1
- * ESD: 4KV(Min.) Human-Body Model
- * *In compliance with EU RoHs 2002/95/EC directives*



SCHOTTKY BARRIER RECTIFIERS

**5.0 AMPERES
70-100 VOLTS**



DO-214AA(SMB)

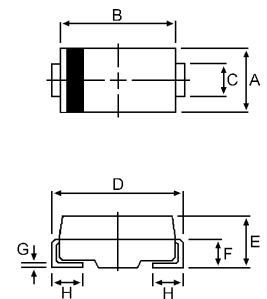

DIM	MILLIMETERS	
	MIN	MAX
A	3.30	3.90
B	4.20	4.60
C	1.80	2.20
D	5.10	5.60
E	1.90	2.50
F		1.30
G		0.22
H	0.95	1.35

MAXIMUM RATINGS

Characteristic	Symbol	SR57	SR58	SR59	SR510	Unit
Peak Repetitive Reverse Voltage	V_{RRM}					
Working Peak Reverse Voltage	V_{RWM}	70	80	90	100	V
DC Blocking Voltage	V_R					
RMS Reverse Voltage	$V_{R(RMS)}$	49	56	63	70	V
Average Rectifier Forward Current	I_O	5				A
Non-Repetitive Peak Surge Current (Surge applied at rate load conditions half-wave, single phase,60Hz)	I_{FSM}	100				A
Operating and Storage Junction Temperature Range	T_J, T_{STG}	-65 to +150				

ELECTRIAL CHARACTERISTICS

Characteristic	Symbol	SR57	SR58	SR59	SR510	Unit
Maximum Instantaneous Forward Voltage ($I_F = 5.0$ Amp)	V_F	0.75		0.85		V
Maximum Instantaneous Reverse Current (Rated DC Voltage, $T_C = 25$) (Rated DC Voltage, $T_C = 125$)	I_R	0.5		20		mA
Maximum Thermal Resistance Junction to Case	$R_{\theta Jc}$	30				$^{\circ}C/W$
Typical Junction Capacitance (Reverse Voltage of 4 volts & $f=1$ MHz)	C_P	300		275		pF

CASE---
Transfer molded
plastic

POLARITY---
Cathode indicated
polarity band

SR57 thru SR510

FIG-1 FORWARD CURRENT DERATING CURVE

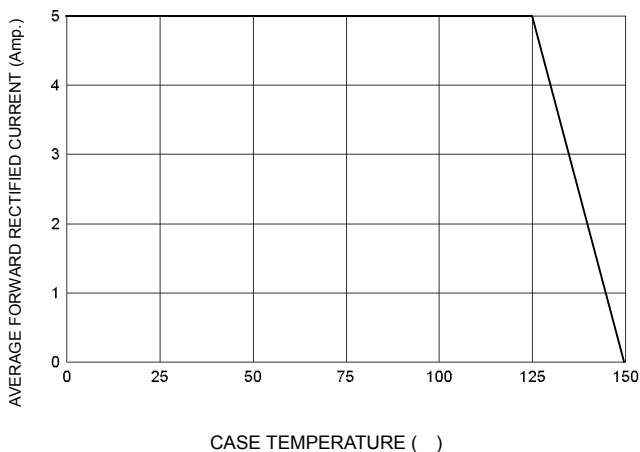

FIG-2 TYPICAL FORWARD CHARACTERISTICS

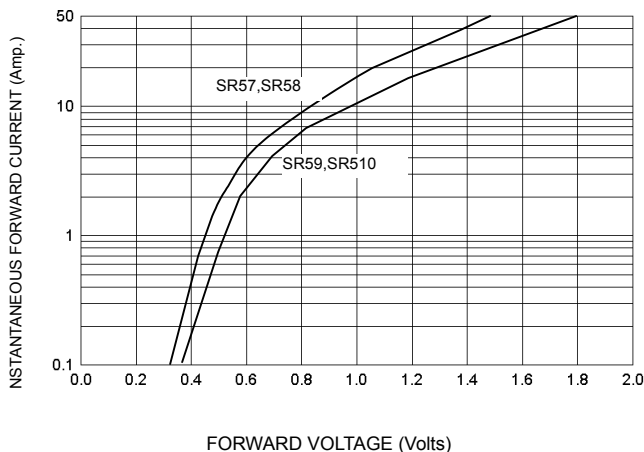

FIG-3 TYPICAL REVERSE CHARACTERISTICS

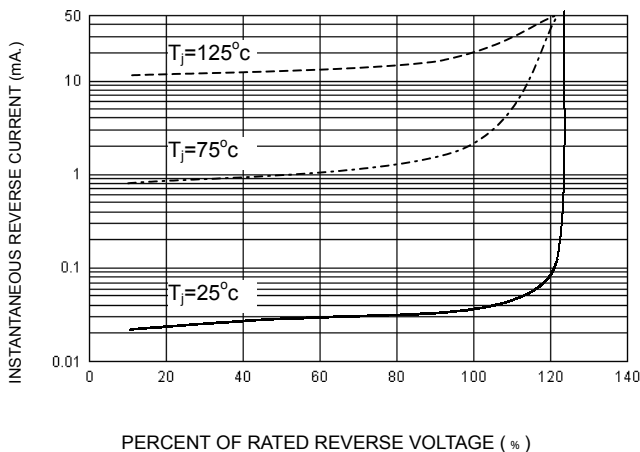

FIG-4 TYPICAL JUNCTION CAPACITANCE

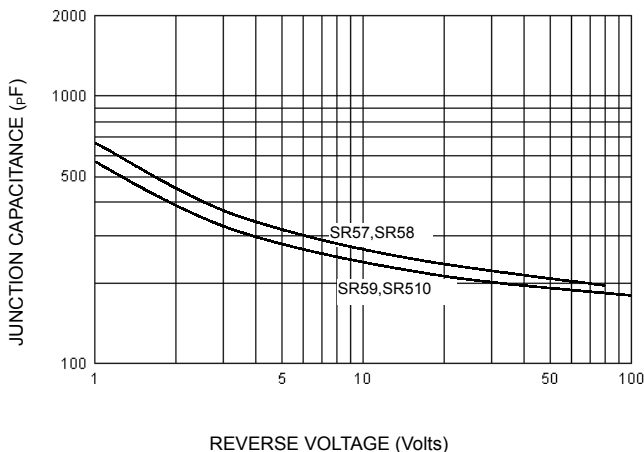

FIG-5 PEAK FORWARD SURGE CURRENT

