

Circuit Diagram

NOTE: Operating force: 160±50gf

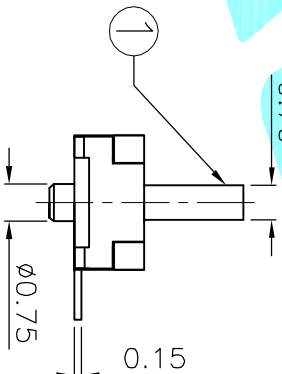
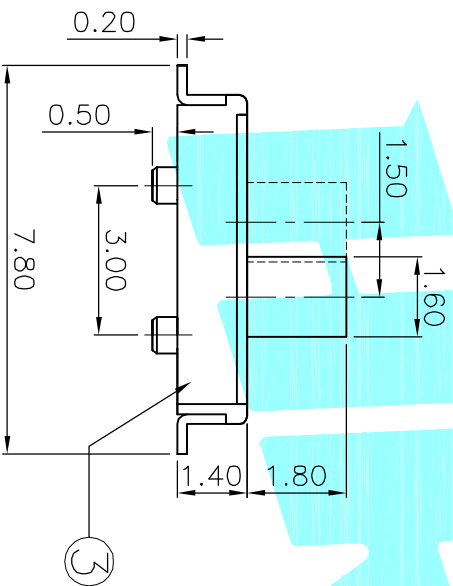

ITEM	PART NAME	TER'NO.	QTY.	MATERIAL	FINISHING	REMARK
⑥	Spring Plate	—	1	SUS	Natural	—
⑤	Contact Spring	—	1	Beryllium copper	Ag Plated	—
④	Terminal	—	3	Phosphor bronze	Ag Plated	—
③	Base	—	1	LCP	Black	—
②	Cover	—	1	Brass	Ag Plated	—
①	Knob	—	1	NYLON	White	—

APPROVALS		DATE
DRAWN	J.X.Zhang	2013/9/24

CHECKED		TITLE:	
APPROVALS		TOGGLE SWITCHES	
TOLERANCES ARE		PART NO.	K3-1292S-P2
30~0.125	±0.30	SCALE:	1:1
10~0.30	±0.20	DRAWING NO.	—
5~10	±0.15	PROJ:	—
~5	±0.10	SHEET	1 OF 1

ECN NO.	REV.	DATE.	DESCRIPTION.	CHANGE.	CHECK.	APPRO.
—	A	—	NEW	—	—	—



ELECTRONICS CO.,LTD