

| | | |
|------|--------------|------|
| MAPX | MODIFICATION | DATE |
| | | |

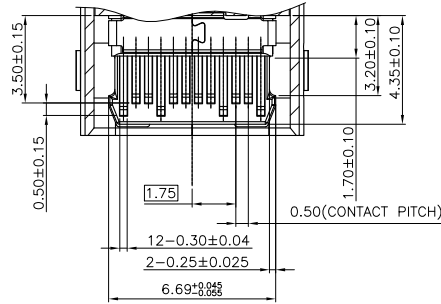

- NOTES:
- MATERIAL:
 - MOLDING: LCP UL94 V-0
 - CONTACT: COPPER ALLOY.
 - GOLD PLATED Min ON CONTACT AREA, 100u" Min TIN (LEAD FREE) ON SOLDER AREA,
 - SHELL: SUS304-H, T=0.30±0.03mm
 - 50u" NICKEL PLATING OVER ALL.
 - SHILD: SUS304-H, T=0.12±0.03mm
 - MECHANICAL:
 - INSERTION: 5~20N.
 - EXTRACTION: 8~20N AFTER TEST.
 - DURABILITY: 10000 CYCLES
 - ELECTRICAL:
 - CURRENT: 5A FOR VBUS; 1.25A FOR GND PIN. 0.25A FOR OTHER.
 - VOLTAGE: 20 V MAX
 - WITHSTANDING VOLTAGE: 100V AC R.M.S.
 - CONTACT RESISTANCE: 40mΩ MAX.
 - INSULATION RESISTANCE: 100MΩ MIN.
 - ENVIRONMENTAL:
 - TEMPERATURE RANGE -25°C ~ +85°C

SECTION B-B

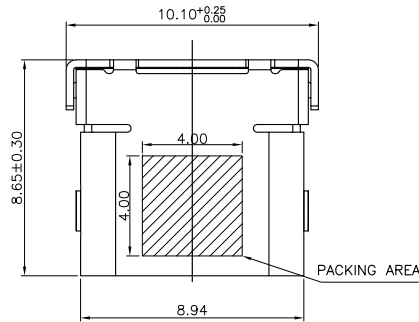
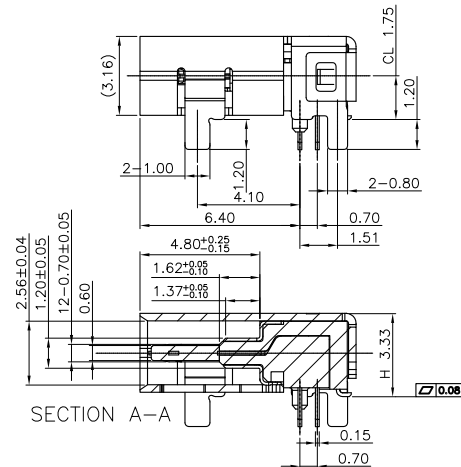
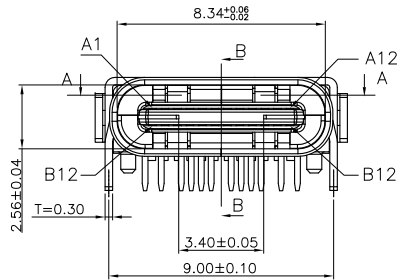

SECTION A-A

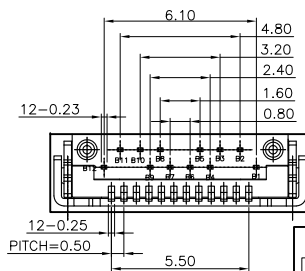
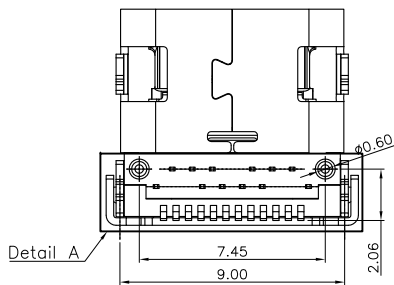

USCX-24FX-XXRX-06

- 1-G.P
- 2-RoHS
- 3-REACH
- 4-HF/无卤
- 1-卷带包装
- 2-PVC盒
- N-可焊接
- S-锡锡
- T-亮锡
- A-金
- B-半金劈锡 1u"
- D-半金劈锡 5u"
- F-半金劈锡 15u"
- H-半金劈锡 30u"
- K-黑色
- N-本色

Detail 产品图
PRODUCT CHART DWG

公差一览表
TOLERANCE UNLESS OTHERWISE

| | | | |
|------|-------|------|-------|
| X. | ±0.25 | X. | ±5.° |
| .X | ±0.20 | .X | ±2.° |
| .XX | ±0.15 | .XX | ±1.° |
| .XXX | ±0.05 | .XXX | ±0.5° |

深圳市精拓金电子有限公司

| | | | | | |
|-------------|------------|---------------|-----|--------------------------|---|
| 单位 UNITS | MM | 制图 DRAWING | 邱建辉 | 制图料号 PRODUCT PART NO. | |
| 比例 SCALE | 1:1 | 审核 CHKD | 郭治富 | 产品名称 PRODUCT NO. | USB 3.1 C TYPE DIP+SMT 母座 四脚插板 8.65L |
| 日期 DATE | 2011.09.02 | 核准 APPD | 黄国荣 | 角法 VIEW | 版本 VER |
| | | | | | A0 |

| | | |
|------|--------------|------|
| MAPX | MODIFICATION | DATE |
| | | |

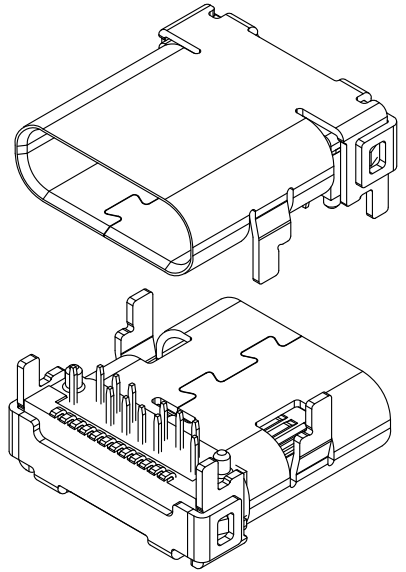

USB TYPE-C FULL-FEATURED RECEPTACLE INTERFACE PIN ASSIGNMENTS

| PIN | Signal Name | Description | PIN | Signal Name | Description |
|-----|-------------|---|-----|-------------|---|
| A1 | GND | Ground return | B12 | GND | Ground return |
| A2 | SSTXp1 | Positive half of first SuperSpeed TX differential pair | B11 | SSRXp1 | Positive half of first SuperSpeed RX differential pair |
| A3 | SSTXn1 | Negative half of first SuperSpeed TX differential pair | B10 | SSRXn1 | Negative half of first SuperSpeed RX differential pair |
| A4 | Vbus | Bus Power | B9 | Vbus | Bus Power |
| A5 | CC1 | Configuration Channel | B8 | SBU2 | Sideband Use (SBU) |
| A6 | Dp1 | Positive half of the USB 2.0 differential pair-Position 1 | B7 | Dn2 | Negative half of the USB 2.0 differential pair-Position 2 |
| A7 | Dn1 | Negative half of the USB 2.0 differential pair-Position 1 | B6 | Dp2 | Positive half of the USB 2.0 differential pair-Position 2 |
| A8 | SBU1 | Sideband Use (SBU) | B5 | CC2 | Configuration Channel |
| A9 | Vbus | Bus Power | B4 | Vbus | Bus Power |
| A10 | SSRXn2 | Negative half of second SuperSpeed RX differential pair | B3 | SSTXn2 | Negative half of second SuperSpeed TX differential pair |
| A11 | SSRXp2 | Positive half of second SuperSpeed RX differential pair | B2 | SSTXp2 | Positive half of second SuperSpeed TX differential pair |
| A12 | GND | Ground return | B1 | GND | Ground return |

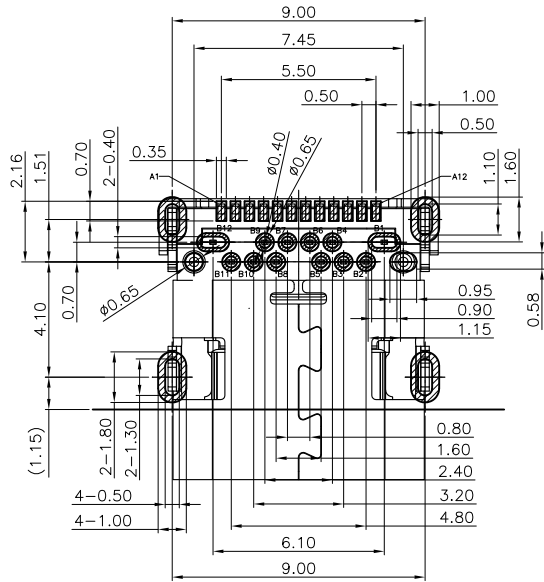

RECOMMEND P.C.B LAYOUT (COMPONENT SIDE)
 TOLERANCE FOR PCB LAYOUT IS ± 0.05
 KEEP OUT AREA

| | | | | | | | | | |
|-------------------------------------|-------|--------------|------|-------|------------|------|-----|-------------|------------------------|
| 产品图 PRODUCT CHART DWG | | 深圳市精拓金电子有限公司 | | | | | | | |
| 公差一览表 TOLERANCE UNLESS OTHERWISE | | 单位 | MM | 制图 | 邱建辉 | 制图料号 | | | |
| X. | ±0.25 | X. | ±5.° | 比例 | 1:1 | 审核 | 郭治富 | 产品名称 | USB 3.1 C TYPE R/A SMT |
| .XX | ±0.15 | .XX | ±2.° | SCALE | | 核淮 | | PRODUCT NO. | PCB LAYOUT |
| .XXX | ±0.05 | .XXX | ±1.° | 日期 | 2011.09.02 | 核淮 | 黄国荣 | 角法 | |
| | | DATE | | APPD | | 版本 | | VER | A0 |

由 Autodesk 教育版产品制作

由 Autodesk 教育版产品制作

| | | | |
|------|--------------|---|------|
| 7 | 8 | 9 | 10 |
| MAPX | MODIFICATION | | DATE |

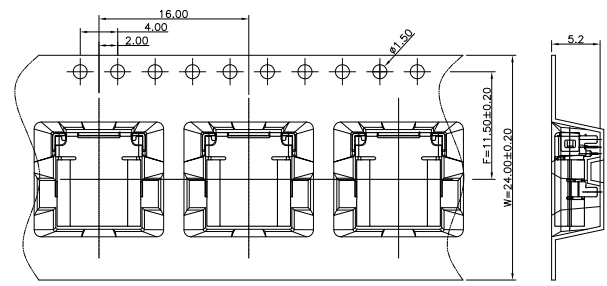

① 产品入载带示意图

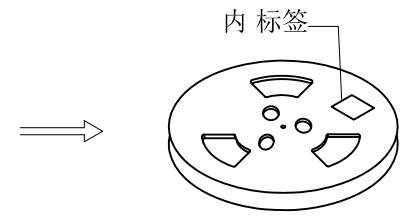

② 卷盘贴标签示意图

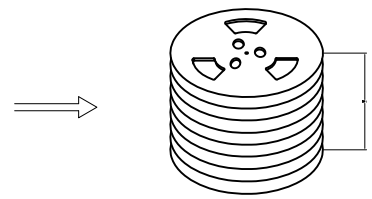

③ 8盘产品叠层示意图

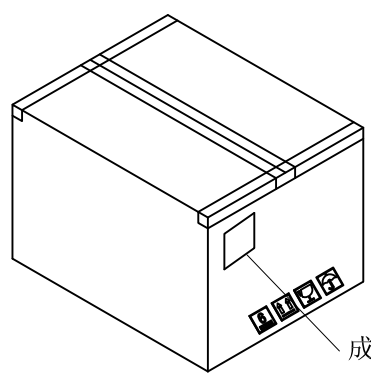

⑥ 外箱封箱示意图

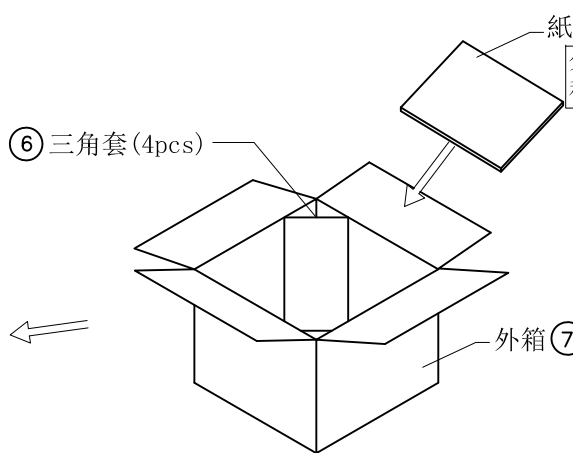

⑤ 产品入外箱示意图

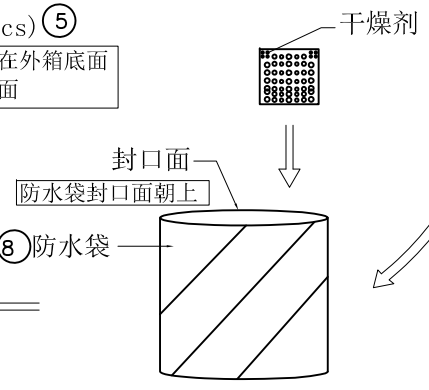

④ 10盘产品入防水袋示意图

图四

图三

包装说明:

1. 将检验好的成品;SMT朝下放入载带底部;每卷装700PCS产品;具体如图一所示
2. 将包装好的产品;每盘必需贴上内标签;具体如图二所示
3. 将贴好内标签的产品每8盘叠一层装入防水袋中并加一包干燥剂;装好后将防水袋封好;具体如图三图四所示
4. 先将1pcs平卡放入纸箱底部;然后将装好产品的防水袋装入纸箱中;防水袋热熔封口,封口面需朝上;并将4PCS三角套分别装入4个角;如图五所示
5. 装好后将1pcs平卡放入纸箱最上面并封好纸箱及贴好相关标签;具体如图六所示;(产品包装的标签,如客户有要求,请按客户要求包装出货)
6. 载带前面留30PCS空格,后面留20PCS空格
7. COVER与CARRY剥离力:50-125g,速度:300mm/分钟左右,剥离角度:165°-180°

| 产品图 PRODUCT CHART DWG | | | |
|-------------------------------------|-------|------|-------|
| 公差一览表 TOLERANCE UNLESS OTHERWISE | | | |
| X. | ±0.25 | X. | ±5.° |
| .X | ±0.20 | .X | ±2.° |
| .XX | ±0.15 | .XX | ±1.° |
| .XXX | ±0.05 | .XXX | ±0.5° |

深圳市精拓金电子有限公司

| | | | | | |
|-------------|------------|---------------|-----|--------------------------|--------------------|
| 单位 UNITS | MM | 制图 DRAWING | 邱建辉 | 制图料号 PRODUCT PART NO. | |
| 比例 SCALE | 1:1 | 审核 CHKD | 郭治富 | 产品名称 PRODUCT NO. | USB 3.1 C TYPE 卷装图 |
| 日期 DATE | 2011.09.02 | 核准 APPD | 黄国荣 | 角法 VIEW | 版本 VER |
| | | | | | A0 |

由 Autodesk 教育版产品制作

由 Autodesk 教育版产品制作