

## SMD Type Shielded Power Inductors

### ◆ Features

1. Magnetically shielded Version.
2. High inductance /High Power Inductor.
3. The products contain no lead and also support lead-free soldering.

### ◆ Applications

Excellent as VTR, OA equipment, LCD television sets, notebook PC, portable communication equipments, DC/DC converters, etc.

### ◆ Lead Free Part Numbering

**SLD 10D40 S 100 M T T**  
 (1) (2) (3) (4) (5) (6) (7)

- (1) Series Type
- (2) Dimension: A X C
- (3) Material Code
- (4) Inductance: 2R2=2.2 $\mu$ H ;  
 100=10 $\mu$ H; 101=100 $\mu$ H
- (5) Inductance Tolerance: M=±20%, Y=±30%
- (6) Company Code
- (7) Packaging : packed in embossed carrier

### ◆ Dimensions

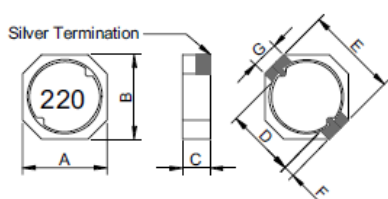

**SLD0420S/0530 Series**

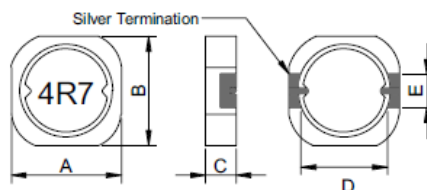

**SLD0620/0625/0630/0635 Series**

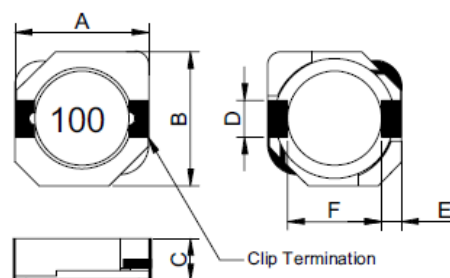

**SLD10D30/10D40/10D50 Series**

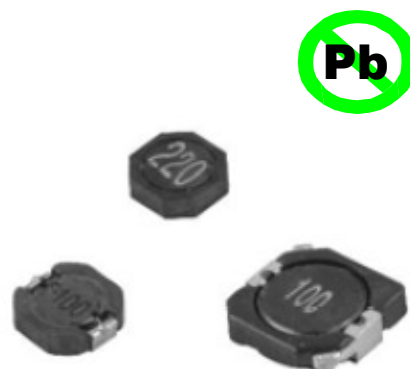

| Series   | A(mm)     | B(mm)     | C(mm)    | D(mm)    | E(mm)    | F(mm)    | G(mm)    |
|----------|-----------|-----------|----------|----------|----------|----------|----------|
| SLD0420  | 4.3 max.  | 4.3 max.  | 2.0 max. | 2.7 ref. | 4.4 ref. | 0.5 ref. | 2.0 ref. |
| SLD0530  | 5.3 max.  | 5.3 max.  | 3.0 max. | 4.2 ref. | 5.8 ref. | 0.6 ref. | 2.0 ref. |
| SLD0620  | 6.3 max.  | 6.3 max.  | 2.0 max. | 4.8 ref. | 2.0 ref. | -        | -        |
| SLD0625  | 6.3 max.  | 6.3 max.  | 2.5 max. | 4.8 ref. | 2.0 ref. | -        | -        |
| SLD0630  | 6.3 max.  | 6.3 max.  | 3.0 max. | 4.8 ref. | 2.0 ref. | -        | -        |
| SLD0635  | 6.3 max.  | 6.3 max.  | 3.5 max. | 4.8 ref. | 2.0 ref. | -        | -        |
| SLD10D30 | 10.5 max. | 10.3 max. | 3.0max.  | 3.0±0.1  | 1.2±0.15 | 7.7±0.3  | -        |
| SLD10D40 | 10.5 max. | 10.3 max. | 4.0max.  | 3.0±0.1  | 1.2±0.15 | 7.7±0.3  | -        |
| SLD10D50 | 10.5 max. | 10.3 max. | 5.0max.  | 3.0±0.1  | 1.2±0.15 | 7.7±0.3  | -        |

## ◆ Specification

| Part Number           | Inductance<br>( $\mu$ H) | Test Frequency<br>(Hz) | DCR<br>( $\Omega$ ) max. | IDC<br>(A) max. |
|-----------------------|--------------------------|------------------------|--------------------------|-----------------|
| <b>SLD0420 Series</b> |                          |                        |                          |                 |
| SLD0420S1R0MTT        | 1.0±20%                  | 1V/100K                | 0.028                    | 2.00            |
| SLD0420S1R2MTT        | 1.2±20%                  | 1V/100K                | 0.040                    | 1.70            |
| SLD0420S2R2MTT        | 2.2±20%                  | 1V/100K                | 0.073                    | 1.50            |
| SLD0420S3R5MTT        | 3.5±20%                  | 1V/100K                | 0.120                    | 1.30            |
| SLD0420S4R7MTT        | 4.7±20%                  | 1V/100K                | 0.160                    | 1.10            |
| SLD0420S6R8MTT        | 6.8±20%                  | 1V/100K                | 0.210                    | 0.90            |
| SLD0420S100MTT        | 10±20%                   | 1V/100K                | 0.450                    | 0.70            |
| SLD0420S150MTT        | 15±20%                   | 1V/100K                | 0.481                    | 0.61            |
| SLD0420S220MTT        | 22±20%                   | 1V/100K                | 0.720                    | 0.52            |
| SLD0420S330MTT        | 33±20%                   | 1V/100K                | 1.010                    | 0.43            |
| SLD0420S470MTT        | 47±20%                   | 1V/100K                | 1.780                    | 0.34            |
| SLD0420S680MTT        | 68±20%                   | 1V/100K                | 2.770                    | 0.25            |
| SLD0420S101MTT        | 100±20%                  | 1V/100K                | 3.440                    | 0.19            |

## ◆ Specification

| Part Number           | Inductance<br>( $\mu$ H) | Test Frequency<br>(Hz) | DCR<br>( $\Omega$ ) max. | IDC<br>(A) max. |
|-----------------------|--------------------------|------------------------|--------------------------|-----------------|
| <b>SLD0530 Series</b> |                          |                        |                          |                 |
| SLD0530S1R1MTT        | 1.1 $\pm$ 20%            | 1V/100K                | 0.020                    | 3.87            |
| SLD0530S2R0MTT        | 2.0 $\pm$ 20%            | 1V/100K                | 0.027                    | 2.92            |
| SLD0530S3R3MTT        | 3.3 $\pm$ 20%            | 1V/100K                | 0.034                    | 2.36            |
| SLD0530S4R7MTT        | 4.7 $\pm$ 20%            | 1V/100K                | 0.045                    | 1.87            |
| SLD0530S6R8MTT        | 6.8 $\pm$ 20%            | 1V/100K                | 0.068                    | 1.51            |
| SLD0530S100MTT        | 10 $\pm$ 20%             | 1V/100K                | 0.090                    | 1.33            |
| SLD0530S150MTT        | 15 $\pm$ 20%             | 1V/100K                | 0.142                    | 1.05            |
| SLD0530S220MTT        | 22 $\pm$ 20%             | 1V/100K                | 0.208                    | 0.86            |
| SLD0530S330MTT        | 33 $\pm$ 20%             | 1V/100K                | 0.257                    | 0.72            |
| SLD0530S470MTT        | 47 $\pm$ 20%             | 1V/100K                | 0.352                    | 0.62            |
| SLD0530S680MTT        | 68 $\pm$ 20%             | 1V/100K                | 0.525                    | 0.51            |
| SLD0530S101MTT        | 100 $\pm$ 20%            | 1V/100K                | 0.801                    | 0.43            |

## ◆ Specification

| Part Number           | Inductance<br>( $\mu$ H) | Test Frequency<br>(Hz) | DCR<br>( $\Omega$ ) max. | IDC<br>(A) max. |
|-----------------------|--------------------------|------------------------|--------------------------|-----------------|
| <b>SLD0620 Series</b> |                          |                        |                          |                 |
| SLD0620S1R0MTT        | 1.0 $\pm$ 20%            | 1V/100K                | 0.016                    | 3.50            |
| SLD0620S1R5MTT        | 1.5 $\pm$ 20%            | 1V/100K                | 0.021                    | 2.94            |
| SLD0620S2R0MTT        | 2.0 $\pm$ 20%            | 1V/100K                | 0.028                    | 2.47            |
| SLD0620S3R3MTT        | 3.3 $\pm$ 20%            | 1V/100K                | 0.047                    | 1.99            |
| SLD0620S4R7MTT        | 4.7 $\pm$ 20%            | 1V/100K                | 0.065                    | 1.59            |
| SLD0620S6R2MTT        | 6.2 $\pm$ 20%            | 1V/100K                | 0.074                    | 1.49            |
| SLD0620S8R2MTT        | 8.2 $\pm$ 20%            | 1V/100K                | 0.102                    | 1.25            |
| SLD0620S100MTT        | 10 $\pm$ 20%             | 1V/100K                | 0.118                    | 1.22            |
| SLD0620S120MTT        | 12 $\pm$ 20%             | 1V/100K                | 0.153                    | 0.99            |
| SLD0620S150MTT        | 15 $\pm$ 20%             | 1V/100K                | 0.197                    | 0.94            |
| SLD0620S180MTT        | 18 $\pm$ 20%             | 1V/100K                | 0.207                    | 0.83            |
| SLD0620S220MTT        | 22 $\pm$ 20%             | 1V/100K                | 0.253                    | 0.80            |
| SLD0620S270MTT        | 27 $\pm$ 20%             | 1V/100K                | 0.33                     | 0.65            |
| SLD0620S330MTT        | 33 $\pm$ 20%             | 1V/100K                | 0.368                    | 0.63            |
| SLD0620S390MTT        | 39 $\pm$ 20%             | 1V/100K                | 0.473                    | 0.55            |
| SLD0620S470MTT        | 47 $\pm$ 20%             | 1V/100K                | 0.542                    | 0.50            |

## ◆ Specification

| Part Number           | Inductance<br>( $\mu$ H) | Test Frequency<br>(Hz) | DCR<br>( $\Omega$ ) max. | IDC<br>(A) max. |
|-----------------------|--------------------------|------------------------|--------------------------|-----------------|
| <b>SLD0625 Series</b> |                          |                        |                          |                 |
| SLD0625S1R0MTT        | 1.0 $\pm$ 20%            | 1V/100K                | 0.014                    | 3.48            |
| SLD0625S1R5MTT        | 1.5 $\pm$ 20%            | 1V/100K                | 0.018                    | 2.83            |
| SLD0625S2R0MTT        | 2.0 $\pm$ 20%            | 1V/100K                | 0.020                    | 2.44            |
| SLD0625S3R3MTT        | 3.3 $\pm$ 20%            | 1V/100K                | 0.030                    | 1.89            |
| SLD0625S4R3MTT        | 4.3 $\pm$ 20%            | 1V/100K                | 0.039                    | 1.65            |
| SLD0625S6R2MTT        | 6.2 $\pm$ 20%            | 1V/100K                | 0.054                    | 1.37            |
| SLD0625S100MTT        | 10 $\pm$ 20%             | 1V/100K                | 0.080                    | 1.07            |
| SLD0625S120MTT        | 12 $\pm$ 20%             | 1V/100K                | 0.094                    | 0.97            |
| SLD0625S150MTT        | 15 $\pm$ 20%             | 1V/100K                | 0.109                    | 0.87            |
| SLD0625S180MTT        | 18 $\pm$ 20%             | 1V/100K                | 0.138                    | 0.79            |
| SLD0625S220MTT        | 22 $\pm$ 20%             | 1V/100K                | 0.163                    | 0.71            |
| SLD0625S270MTT        | 27 $\pm$ 20%             | 1V/100K                | 0.212                    | 0.64            |
| SLD0625S330MTT        | 33 $\pm$ 20%             | 1V/100K                | 0.244                    | 0.58            |
| SLD0625S390MTT        | 39 $\pm$ 20%             | 1V/100K                | 0.306                    | 0.53            |
| SLD0625S470MTT        | 47 $\pm$ 20%             | 1V/100K                | 0.363                    | 0.48            |
| SLD0625S560MTT        | 56 $\pm$ 20%             | 1V/100K                | 0.431                    | 0.44            |
| SLD0625S680MTT        | 68 $\pm$ 20%             | 1V/100K                | 0.500                    | 0.40            |
| SLD0625S820MTT        | 82 $\pm$ 20%             | 1V/100K                | 0.580                    | 0.36            |
| SLD0625S101MTT        | 100 $\pm$ 20%            | 1V/100K                | 0.820                    | 0.33            |

## ◆ Specification

| Part Number           | Inductance<br>( $\mu$ H) | Test Frequency<br>(Hz) | DCR<br>( $\Omega$ ) max. | IDC<br>(A) max. |
|-----------------------|--------------------------|------------------------|--------------------------|-----------------|
| <b>SLD0630 Series</b> |                          |                        |                          |                 |
| SLD0630S1R0MTT        | 1.0 $\pm$ 20%            | 1V/100K                | 0.014                    | 3.59            |
| SLD0630S1R5MTT        | 1.5 $\pm$ 20%            | 1V/100K                | 0.016                    | 2.93            |
| SLD0630S2R2MTT        | 2.2 $\pm$ 20%            | 1V/100K                | 0.020                    | 2.42            |
| SLD0630S3R6MTT        | 3.6 $\pm$ 20%            | 1V/100K                | 0.026                    | 1.89            |
| SLD0630S4R7MTT        | 4.7 $\pm$ 20%            | 1V/100K                | 0.034                    | 1.66            |
| SLD0630S6R2MTT        | 6.2 $\pm$ 20%            | 1V/100K                | 0.040                    | 1.45            |
| SLD0630S100MTT        | 10 $\pm$ 20%             | 1V/100K                | 0.061                    | 1.14            |
| SLD0630S120MTT        | 12 $\pm$ 20%             | 1V/100K                | 0.065                    | 1.04            |
| SLD0630S150MTT        | 15 $\pm$ 20%             | 1V/100K                | 0.078                    | 0.93            |
| SLD0630S180MTT        | 18 $\pm$ 20%             | 1V/100K                | 0.093                    | 0.85            |
| SLD0630S220MTT        | 22 $\pm$ 20%             | 1V/100K                | 0.119                    | 0.77            |
| SLD0630S270MTT        | 27 $\pm$ 20%             | 1V/100K                | 0.150                    | 0.70            |
| SLD0630S330MTT        | 33 $\pm$ 20%             | 1V/100K                | 0.175                    | 0.63            |
| SLD0630S390MTT        | 39 $\pm$ 20%             | 1V/100K                | 0.188                    | 0.58            |
| SLD0630S470MTT        | 47 $\pm$ 20%             | 1V/100K                | 0.231                    | 0.53            |
| SLD0630S560MTT        | 56 $\pm$ 20%             | 1V/100K                | 0.275                    | 0.48            |
| SLD0630S680MTT        | 68 $\pm$ 20%             | 1V/100K                | 0.338                    | 0.44            |
| SLD0630S820MTT        | 82 $\pm$ 20%             | 1V/100K                | 0.413                    | 0.40            |
| SLD0630S101MTT        | 100 $\pm$ 20%            | 1V/100K                | 0.519                    | 0.36            |
| SLD0630S151MTT        | 150 $\pm$ 20%            | 1V/100K                | 0.769                    | 0.31            |

## ◆ Specification

| Part Number           | Inductance<br>( $\mu$ H) | Test Frequency<br>(Hz) | DCR<br>( $\Omega$ ) max. | IDC<br>(A) max. |
|-----------------------|--------------------------|------------------------|--------------------------|-----------------|
| <b>SLD0635 Series</b> |                          |                        |                          |                 |
| SLD0635S2R0MTT        | 2.0 $\pm$ 20%            | 1V/100K                | 0.020                    | 2.997           |
| SLD0635S2R7MTT        | 2.7 $\pm$ 20%            | 1V/100K                | 0.023                    | 2.691           |
| SLD0635S3R3MTT        | 3.3 $\pm$ 20%            | 1V/100K                | 0.027                    | 2.573           |
| SLD0635S4R7MTT        | 4.7 $\pm$ 20%            | 1V/100K                | 0.033                    | 2.084           |
| SLD0635S6R2MTT        | 6.2 $\pm$ 20%            | 1V/100K                | 0.036                    | 1.835           |
| SLD0635S8R2MTT        | 8.2 $\pm$ 20%            | 1V/100K                | 0.045                    | 1.542           |
| SLD0635S100MTT        | 10 $\pm$ 20%             | 1V/100K                | 0.052                    | 1.491           |
| SLD0635S120MTT        | 12 $\pm$ 20%             | 1V/100K                | 0.065                    | 1.282           |
| SLD0635S150MTT        | 15 $\pm$ 20%             | 1V/100K                | 0.080                    | 1.103           |
| SLD0635S180MTT        | 18 $\pm$ 20%             | 1V/100K                | 0.085                    | 1.046           |
| SLD0635S220MTT        | 22 $\pm$ 20%             | 1V/100K                | 0.111                    | 0.968           |
| SLD0635S270MTT        | 27 $\pm$ 20%             | 1V/100K                | 0.146                    | 0.821           |
| SLD0635S330MTT        | 33 $\pm$ 20%             | 1V/100K                | 0.169                    | 0.755           |
| SLD0635S390MTT        | 39 $\pm$ 20%             | 1V/100K                | 0.199                    | 0.700           |
| SLD0635S470MTT        | 47 $\pm$ 20%             | 1V/100K                | 0.218                    | 0.677           |
| SLD0635S560MTT        | 56 $\pm$ 20%             | 1V/100K                | 0.268                    | 0.602           |
| SLD0635S680MTT        | 68 $\pm$ 20%             | 1V/100K                | 0.333                    | 0.556           |
| SLD0635S820MTT        | 82 $\pm$ 20%             | 1V/100K                | 0.436                    | 0.468           |
| SLD0635S101MTT        | 100 $\pm$ 20%            | 1V/100K                | 0.496                    | 0.449           |
| SLD0635S151MTT        | 150 $\pm$ 20%            | 1V/100K                | 0.691                    | 0.367           |

## ◆ Specification

| Part Number            | Inductance<br>( $\mu$ H) | Test Frequency<br>(Hz) | DCR<br>(m $\Omega$ ) max. | IDC<br>(A) max. |
|------------------------|--------------------------|------------------------|---------------------------|-----------------|
| <b>SLD10D30 Series</b> |                          |                        |                           |                 |
| SLD10D30SR80YTT        | 0.8 $\pm$ 30%            | 0.1V/100K              | 5.7                       | 11.20           |
| SLD10D30S1R5YTT        | 1.5 $\pm$ 30%            | 0.1V/100K              | 11                        | 8.00            |
| SLD10D30S2R2YTT        | 2.2 $\pm$ 30%            | 0.1V/100K              | 16.9                      | 6.70            |
| SLD10D30S3R3YTT        | 3.3 $\pm$ 30%            | 0.1V/100K              | 21                        | 5.56            |
| SLD10D30S4R7YTT        | 4.7 $\pm$ 30%            | 0.1V/100K              | 30                        | 4.65            |
| SLD10D30S6R8YTT        | 6.8 $\pm$ 30%            | 0.1V/100K              | 35                        | 3.84            |
| SLD10D30S8R2YTT        | 8.2 $\pm$ 30%            | 0.1V/100K              | 50                        | 3.54            |
| SLD10D30S100MTT        | 10 $\pm$ 20%             | 0.1V/100K              | 59                        | 3.18            |
| SLD10D30S150MTT        | 15 $\pm$ 20%             | 0.1V/100K              | 91                        | 2.60            |
| SLD10D30S220MTT        | 22 $\pm$ 20%             | 0.1V/100K              | 143                       | 2.16            |
| SLD10D30S330MTT        | 33 $\pm$ 20%             | 0.1V/100K              | 202                       | 1.74            |
| SLD10D30S470MTT        | 47 $\pm$ 20%             | 0.1V/100K              | 299                       | 1.43            |
| SLD10D30S560MTT        | 56 $\pm$ 20%             | 0.1V/100K              | 325                       | 1.36            |
| SLD10D30S680MTT        | 68 $\pm$ 20%             | 0.1V/100K              | 429                       | 1.22            |
| SLD10D30S820MTT        | 82 $\pm$ 20%             | 0.1V/100K              | 494                       | 1.14            |
| SLD10D30S101MTT        | 100 $\pm$ 20%            | 0.1V/100K              | 683                       | 1.02            |
| SLD10D30S121MTT        | 120 $\pm$ 20%            | 0.1V/100K              | 754                       | 0.89            |
| SLD10D30S151MTT        | 150 $\pm$ 20%            | 0.1V/100K              | 871                       | 0.84            |

◆ Specification

| Part Number            | Inductance<br>( $\mu$ H) | Test Frequency<br>(Hz) | DCR<br>(m $\Omega$ ) max. | IDC<br>(A) max. |
|------------------------|--------------------------|------------------------|---------------------------|-----------------|
| <b>SLD10D40 Series</b> |                          |                        |                           |                 |
| SLD10D40S1R5YTT        | 1.50 $\pm$ 30%           | 0.1V/100K              | 8.1                       | 10.00           |
| SLD10D40S2R5YTT        | 2.50 $\pm$ 30%           | 0.1V/100K              | 10.5                      | 7.50            |
| SLD10D40S3R8YTT        | 3.80 $\pm$ 30%           | 0.1V/100K              | 13                        | 6.00            |
| SLD10D40S5R2YTT        | 5.20 $\pm$ 30%           | 0.1V/100K              | 22                        | 5.50            |
| SLD10D40S7R0YTT        | 7.00 $\pm$ 30%           | 0.1V/100K              | 27                        | 4.80            |
| SLD10D40S100MTT        | 10.0 $\pm$ 20%           | 0.1V/100K              | 35                        | 4.40            |
| SLD10D40S150MTT        | 15.0 $\pm$ 20%           | 0.1V/100K              | 50                        | 3.60            |
| SLD10D40S220MTT        | 22.0 $\pm$ 20%           | 0.1V/100K              | 73                        | 2.90            |
| SLD10D40S330MTT        | 33.0 $\pm$ 20%           | 0.1V/100K              | 93                        | 2.30            |
| SLD10D40S470MTT        | 47.0 $\pm$ 20%           | 0.1V/100K              | 128                       | 2.10            |
| SLD10D40S680MTT        | 68.0 $\pm$ 20%           | 0.1V/100K              | 213                       | 1.50            |
| SLD10D40S101MTT        | 100.0 $\pm$ 20%          | 0.1V/100K              | 304                       | 1.35            |
| SLD10D40S151MTT        | 150.0 $\pm$ 20%          | 0.1V/100K              | 506                       | 1.15            |
| SLD10D40S221MTT        | 220.0 $\pm$ 20%          | 0.1V/100K              | 756                       | 0.92            |
| SLD10D40S331MTT        | 330.0 $\pm$ 20%          | 0.1V/100K              | 1090                      | 0.70            |

## ◆ Specification

| Part Number            | Inductance<br>( $\mu$ H) | Test Frequency<br>(Hz) | DCR<br>(m $\Omega$ ) max. | IDC<br>(A) max. |
|------------------------|--------------------------|------------------------|---------------------------|-----------------|
| <b>SLD10D50 Series</b> |                          |                        |                           |                 |
| SLD10D50SR80YTT        | 0.8 $\pm$ 30%            | 0.1V/100K              | 4.3                       | 9.50            |
| SLD10D50S1R5YTT        | 1.5 $\pm$ 30%            | 0.1V/100K              | 5.8                       | 8.30            |
| SLD10D50S2R2YTT        | 2.2 $\pm$ 30%            | 0.1V/100K              | 7.2                       | 7.50            |
| SLD10D50S3R3YTT        | 3.3 $\pm$ 30%            | 0.1V/100K              | 10.4                      | 6.50            |
| SLD10D50S4R7YTT        | 4.7 $\pm$ 30%            | 0.1V/100K              | 12.3                      | 6.10            |
| SLD10D50S6R8YTT        | 6.8 $\pm$ 30%            | 0.1V/100K              | 18                        | 5.40            |
| SLD10D50S8R2YTT        | 8.2 $\pm$ 30%            | 0.1V/100K              | 20                        | 5.00            |
| SLD10D50S100MTT        | 10 $\pm$ 20%             | 0.1V/100K              | 26                        | 4.50            |
| SLD10D50S120MTT        | 12 $\pm$ 20%             | 0.1V/100K              | 33                        | 3.80            |
| SLD10D50S150MTT        | 15 $\pm$ 20%             | 0.1V/100K              | 41                        | 3.40            |
| SLD10D50S180MTT        | 18 $\pm$ 20%             | 0.1V/100K              | 46                        | 3.10            |
| SLD10D50S220MTT        | 22 $\pm$ 20%             | 0.1V/100K              | 61                        | 2.90            |
| SLD10D50S270MTT        | 27 $\pm$ 20%             | 0.1V/100K              | 69                        | 2.60            |
| SLD10D50S330MTT        | 33 $\pm$ 20%             | 0.1V/100K              | 84                        | 2.50            |
| SLD10D50S390MTT        | 39 $\pm$ 20%             | 0.1V/100K              | 106                       | 2.25            |
| SLD10D50S470MTT        | 47 $\pm$ 30%             | 0.1V/100K              | 130                       | 2.00            |
| SLD10D50S560MTT        | 56 $\pm$ 30%             | 0.1V/100K              | 149                       | 1.90            |
| SLD10D50S680MTT        | 68 $\pm$ 30%             | 0.1V/100K              | 201                       | 1.60            |
| SLD10D50S820MTT        | 82 $\pm$ 30%             | 0.1V/100K              | 227                       | 1.45            |
| SLD10D50S101MTT        | 100 $\pm$ 30%            | 0.1V/100K              | 253                       | 1.35            |
| SLD10D50S121MTT        | 120 $\pm$ 20%            | 0.1V/100K              | 303                       | 1.18            |
| SLD10D50S151MTT        | 150 $\pm$ 20%            | 0.1V/100K              | 370                       | 1.10            |
| SLD10D50S181MTT        | 180 $\pm$ 20%            | 0.1V/100K              | 419                       | 1.00            |
| SLD10D50S221MTT        | 220 $\pm$ 20%            | 0.1V/100K              | 500                       | 0.94            |
| SLD10D50S271MTT        | 270 $\pm$ 20%            | 0.1V/100K              | 672                       | 0.80            |
| SLD10D50S331MTT        | 330 $\pm$ 20%            | 0.1V/100K              | 812                       | 0.73            |
| SLD10D50S391MTT        | 390 $\pm$ 20%            | 0.1V/100K              | 953                       | 0.70            |
| SLD10D50S471MTT        | 470 $\pm$ 20%            | 0.1V/100K              | 1289                      | 0.54            |
| SLD10D50S561MTT        | 560 $\pm$ 20%            | 0.1V/100K              | 1430                      | 0.52            |
| SLD10D50S681MTT        | 680 $\pm$ 20%            | 0.1V/100K              | 1599                      | 0.51            |
| SLD10D50S821MTT        | 820 $\pm$ 20%            | 0.1V/100K              | 1768                      | 0.48            |
| SLD10D50S102MTT        | 1000 $\pm$ 20%           | 0.1V/100K              | 1989                      | 0.42            |

## ◆ Note

1. Inductance measured by LCR Meter HP 4284A or equivalent.
2. DCR measured by Milliohm meter HP 4338B or equivalent.
3. Rated current is measured by LCR-meter 3260B (WK) & DC Bias 3265B(WK).
4. Maximum allowable DC current is that which causes a 25% inductance reduction from the initial value, or coil temperature to rise by 40°C, whichever is smaller. (Reference ambient temperature 25°C).