

**Surface Mount Load Dump
Transient Voltage Suppressors**

REVERSE VOLTAGE - 36 Volts
PEAK PULSE POWER - 6600 Watt

FEATURES

- High current capability
- Low Forward Voltage Drop
- Low reverse current
- Low thermal resistance
- Excellent high temperature stability
- Low power loss and high efficiency
- High forward surge capability
- Meet ISO7637-2 and ISO16750-2 surge specification (varied by test condition)
- Meet MSL level 1, per J-STD-020, LF maximum peak of 260 °C
- AEC-Q101 qualified
- PPAP capable

APPLICATION

- High peak power
- High-temperature
- Clamping diode
- Load switching and lighting
- Use in sensitive electronics protection against voltage transients induced by inductive automotive ECU module, especially for automotive load dump protection application

MECHANICAL DATA

- **Case:** DO-218 outline plastic package
- **Terminals:** Matte tin plated, solderable per MIL-STD-750, Method 2026, J-STD-002 and JESD 22-B102
- Molding Compound Flammability Rating:UL94-0
- High temperature soldering guaranteed: 260°C/10second
- **Polarity:** Heatsink is anode
- Corresponds to taping packages. (700PCS/Reel)

DO-218

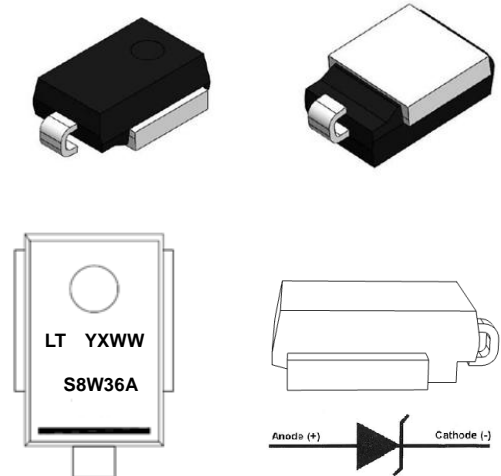

Primary Characteristics

VWM	36 V
VBR	44.2V
PPPM (10 x 1000 uS)	6600 W
PPPM (10 x 10 000 uS)	5200 W
IFSM	700 A
Polarity	Uni-directional
Diode variation	Single

Maximum Ratings (TA = 25 °C unless otherwise noted)				
Parameter		Symbol	Value	Units
Peak pulse power dissipation	10/1000 μ s waveform	PPPM	6600	W
	10/10000 μ s waveform		5200	
Peak forward surge current 8.3 ms single half sine-wave		IFSM	700	A
Operating junction and storage temperature range		TJ, TSTG	-55 to +175	°C

Electrical Characteristics (TA = 25 °C unless otherwise noted)								
Part Number	Breakdown Voltage V _{BR} (V)		Test Current I _T (mA)	Stand-OFF Voltage V _{WM} (V)	Maximum Reverse Leakage at V _{WM} I _D (uA)	Maximum Leakage at V _{WM} T _J = 175 °C I _D (uA)	Max. Peak Pulse Current at 10/1000 us Waveform (A)	Maximum Clamping Voltage at I _{PPM} V _C (V)
	Min.	Max.						
ALS8W36A	40.0	44.2	5.0	36.0	10	150	114	58.1

Note: V_F = 1.8 Vmax at I_F = 100 A measured on 8.3 ms single half sine-wave.

RATING AND CHARACTERISTIC CURVES ALS8W36A

FIG.1- Power Derating Curve

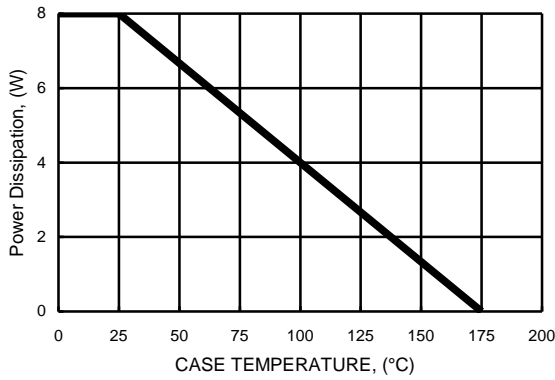

**FIG.2- Load Dump Power Characteristics
(10ms Exponential Waveform)**

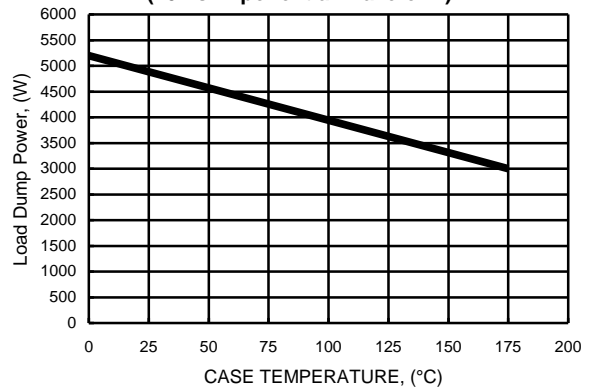

Fig.3 - Pulse Waveform

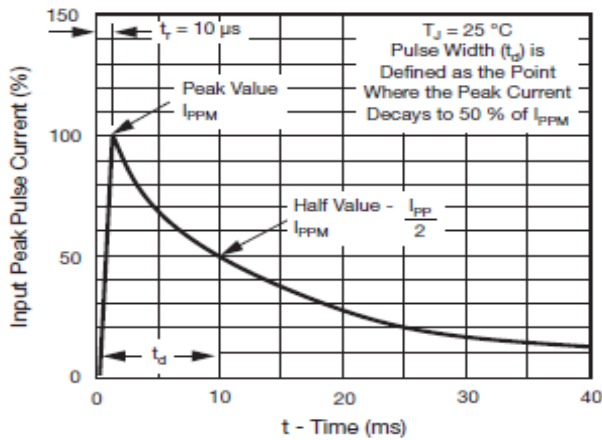

FIG.4- Reverse Power Capability

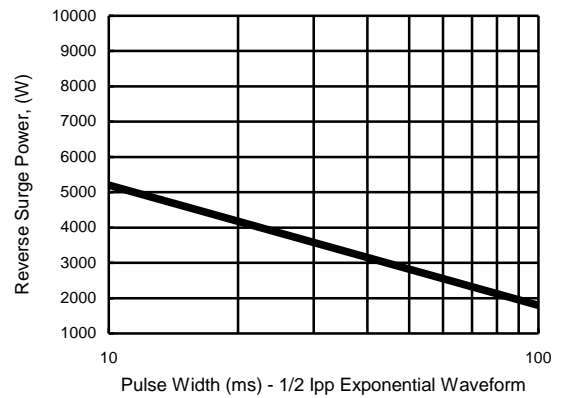

FIG.5- Typical Transient Thermal Impedance

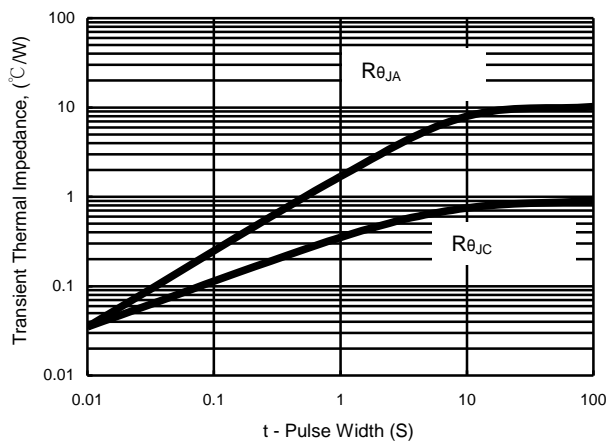
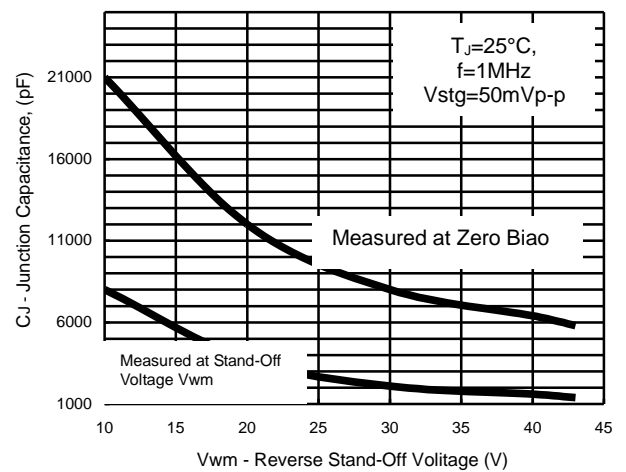
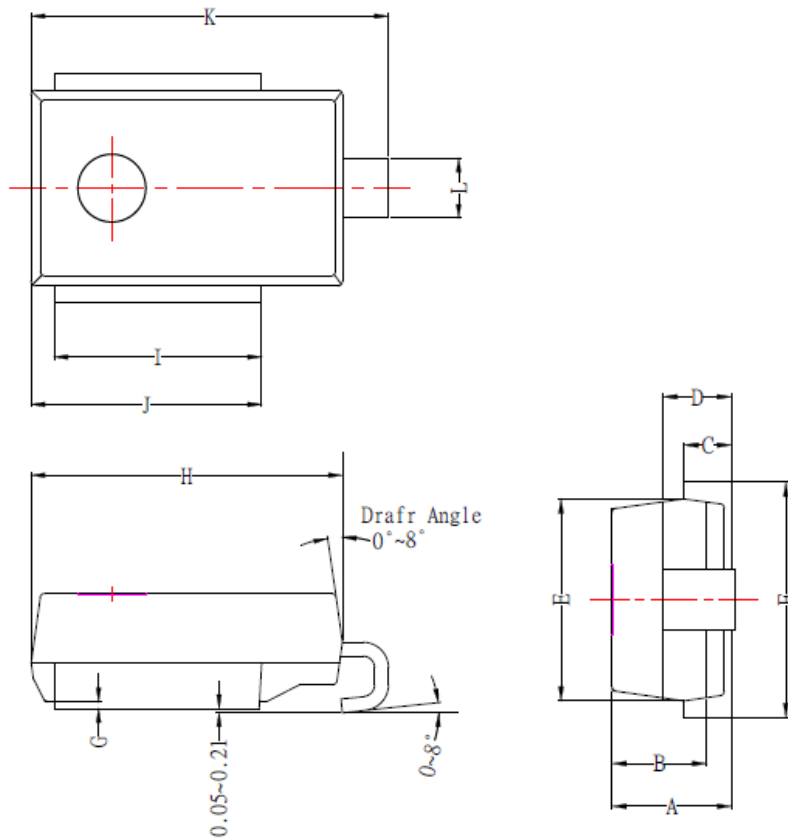

FIG.6- Typical Junction Capacitance



Package Dimension :



D0-218			
DIM.	MIN.	TYP.	MAX.
A	4.75	5.00	5.25
B	3.66	3.96	4.26
C	1.80	2.00	2.20
D	2.58	2.88	3.18
E	8.20	8.50	8.80
F	9.50	—	10.50
G	—	0.30	—
H	13.20	13.50	13.80
I	8.70	9.00	9.30
J	9.70	10.00	10.25
K	15.00	15.50	16.00
L	2.30	—	3.00
All Dimension in millimeter			

Soldering Pad Layout :

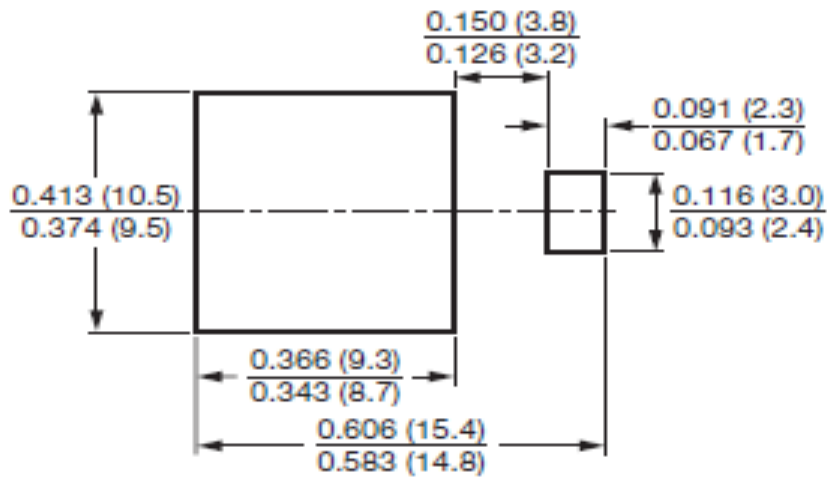

Marking Information :

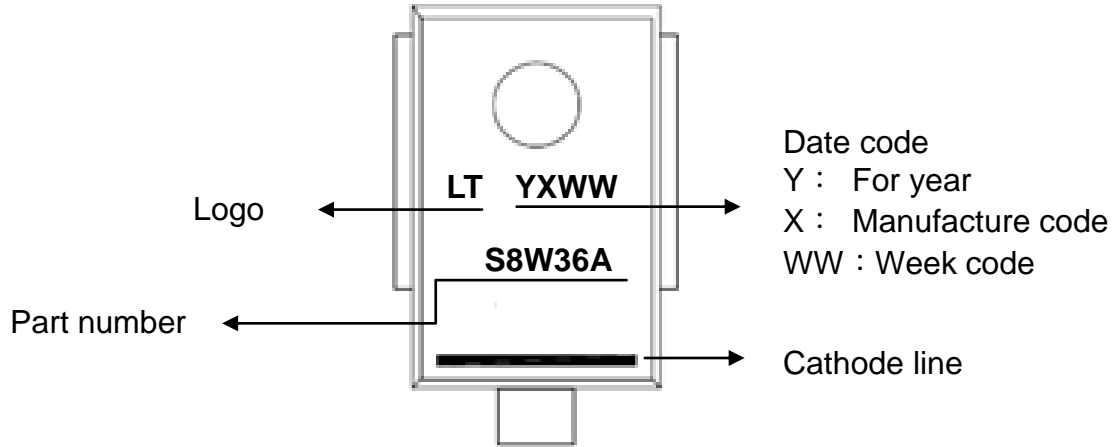

Packaging Information :

DEVICE	REEL DIA.	Q'TY/REEL	REEL/BOX	Q'TY/BOX	BOX/CORTON	Q'TY/CORTON	BOX SIZE	CARTON SIZE
	(INCH)	(PCS)	(REEL)	(PCS)	(BOX)	(PCS)	(mm)	(mm)
ALS8W36A	13	700	1	700	7	4900	345*355*43	355*346*376

Important Notice and Disclaimer

LSC reserves the right to make changes to this document and its products and specifications at any time without notice. Customers should obtain and confirm the latest product information and specifications before final design, purchase or use.

LSC makes no warranty, representation or guarantee regarding the suitability of its products for any particular purpose, nor does LSC assume any liability for application assistance or customer product design. LSC does not warrant or accept any liability with products which are purchased or used for any unintended or unauthorized application.

No license is granted by implication or otherwise under any intellectual property rights of LSC.

LSC products are not authorized for use as critical components in life support devices or systems without express written approval of LSC.