

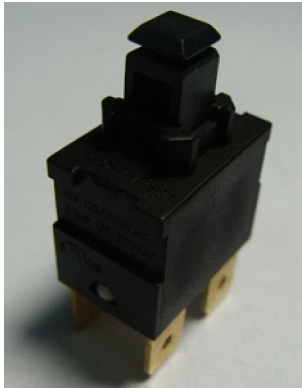

PUSH SWITCH

MPS21 SERIES



SPECIFICATION

Rating:16A 125/250VAC ,3/4HP 125/250VAC(CUL)
 16(4)A 250V~T125/55(ENEC17,NEMKO,CB,CQC)
 10(6)A 250V~T125/55(5E4)(ENEC17,NEMKO,CB,CQC)
 INITIAL CONTACT RESISTANCE:20mΩ Max
 OPERATION FORCE:300±200gf
 INSULATION RESISTANCE:100mΩ MIN 500VDC
 WITHSTAND VOLTAGE:1500VAC FOR 1MINUTE
 ENDURANCE:10,000CYCLES



TERMINAL TYPE	
Q	QUICK CONNECTOR Tab6.3X0.8

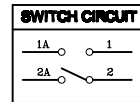
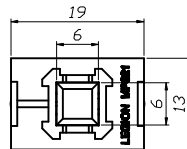

CURRENT CIRCUIT	
S	SINGLE POLE
D	DOUBLE POLE

WHEN THE SWITCH IS ON THE "ON" STATE, DIMENSION A IS 4mm, AND IF THE "OFF" STATE, DIMENSION A IS 7.2mm

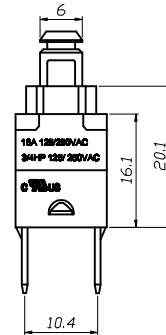
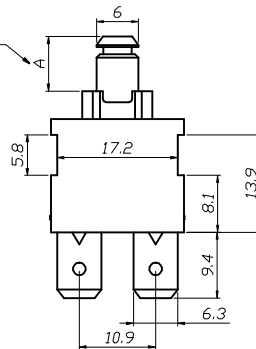

PANEL CUTOUT DIMENSION:

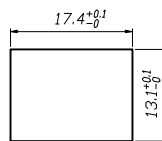

MPS21 SERIES ORDERING SYSTEM

