

# C303 SERIES



## SPECIFICATIONS

|                       |                         |
|-----------------------|-------------------------|
| Circuit               | OFF-(ON)/Momentary SPST |
| Current Rating        | :100mA                  |
| Voltage Rating        | :12VDC                  |
| Dielectric voltage    | :250VAC for 1 minute    |
| Contact Resistance    | :200mΩ Max . (intial)   |
| Insulation Resistance | :100MΩ Min .            |
| Operating Force       | :250±100gf              |
| Total Travel          | 4.5±0.2mm               |
| Operating Force       | :1,000,000 Cycles Min   |
| Solder Specifications | :260°C for 5 Seconds    |
| Operating Temperature | :-20°C~ +70°C           |



C3032 SERIES

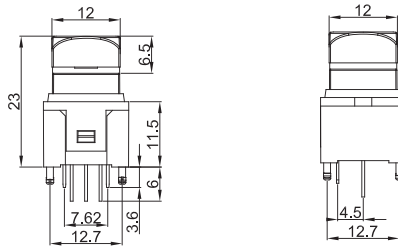
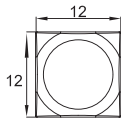

C3035 SERIES

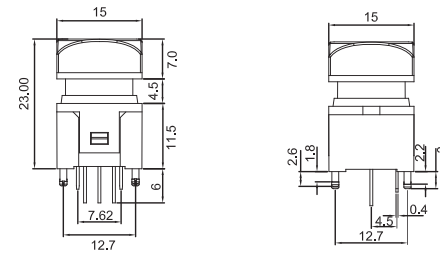
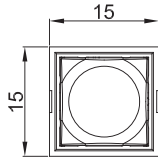

C3037 SERIES

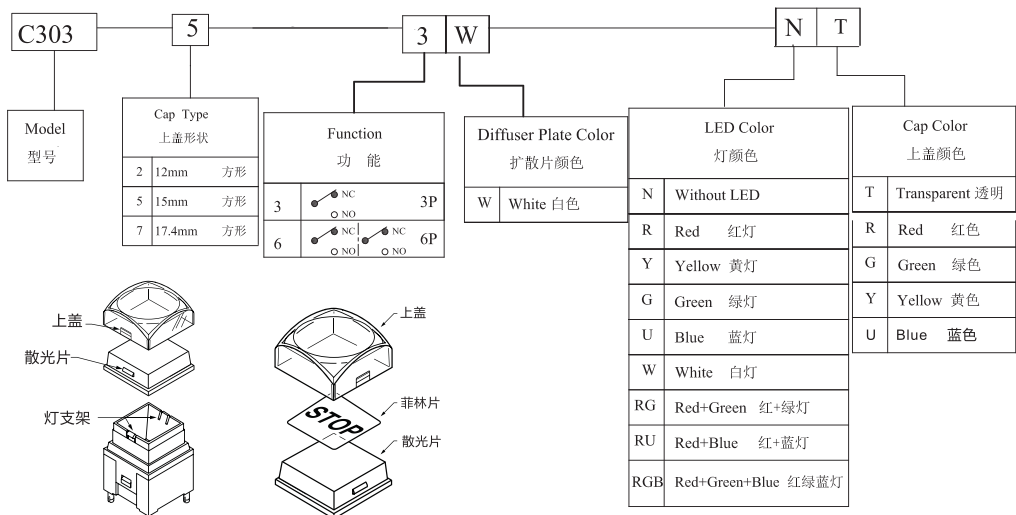
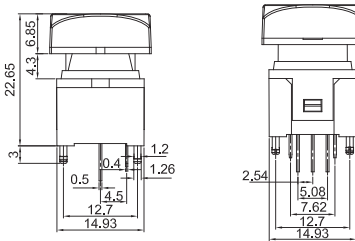
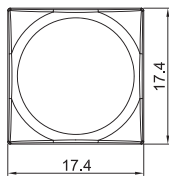

DIP  
TACT  
LED TACT  
PUSH BUTTON  
TOGGLE  
SLIDE  
ROCKER  
MICRO / POWER