

REV.	ECN. NO.	APPD.
A		

NOTES:  
 Rated Current:2.0AMP.  
 Contact Resistance:20mΩ Max.  
 Withstand Voltage:500V AC/DC  
 Insulation Resistance:1000MΩ Min.  
 Operation Temperature:-40°C to +105°C

Contact Material:Brass  
 Contact Plating:Au or Sn Over Ni  
 Insulator Material:PA9T+30%G.F UL94V-0 BK

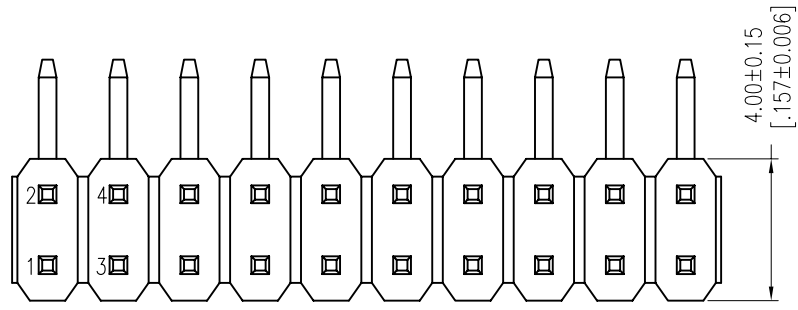

Recommended P.C.B Layout (Top Side)  
 (PCB BOARD TOLERANCE±0.05)

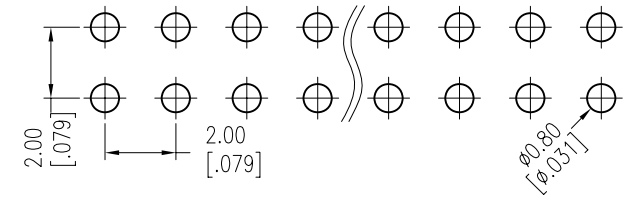

## Ordering Information

MTP220-12XXR1

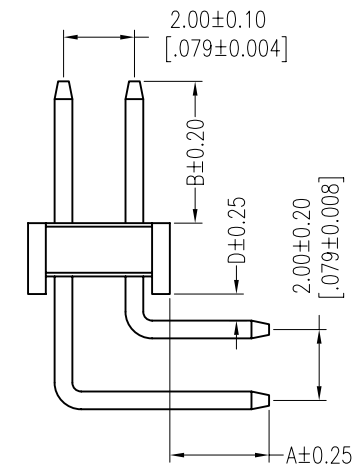
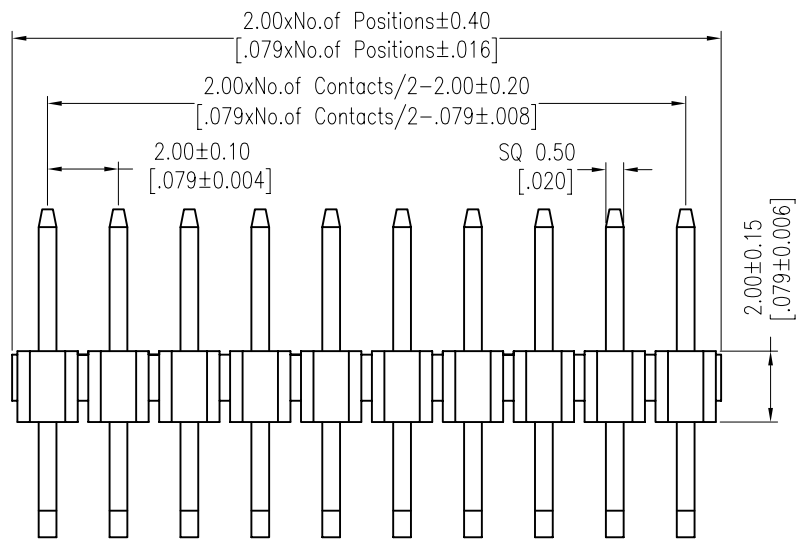

Item	Pin Length	A	D	B	Mating
Standard	10.50	2.80	0.75	4.00	2240 2243 2263 2272
Alternate					

X. ± 0.30	X.° ± 5°	UNITS mm	NAME (INTENDED USE)	MINTRON CO.,LTD.		
.X ± 0.20	.X° ± 2°					
.XX ± 0.10	.XX° ± 1°	FINISH	PART NO. (INTENDED USE)	TITLE: MTP220-12XXR1		
.XXX ± 0.05	.XXX° ± 0.5°					
PIN HEADER CONNECTOR			APPD: SUNNY	DWG NO.:		
			CHKD: LISA			
			DR: ZOE 2006-11-28			
			SCALE 1/1			
			SHEET 1/1			
			REV. A			