

REV.	ECON. NO.	APPD.
A		

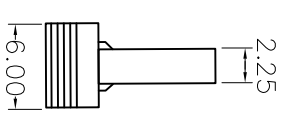

NOTES:
 Current Rating: 3AMP
 Contact Resistance: 20mΩ max
 Withstand Voltage: 1000V AC/DC
 Insulation Resistance: 1000MΩ Min
 Operation Temperature: -40°C to +105°C
 Contact Material: Brass
 Contact plating: Au Over Ni
 Insulator Material: PBT+30%GF (UL94V-0)
 Contact plated: Gold Flash

Ordering Information

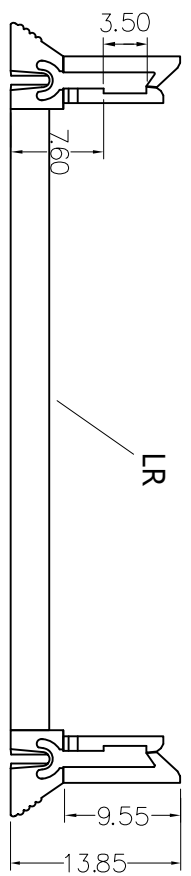
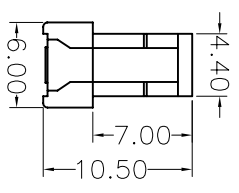
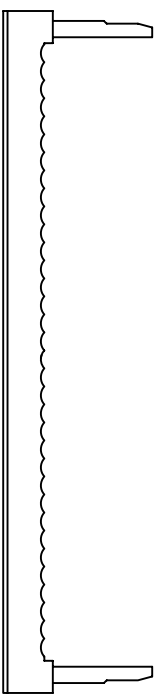
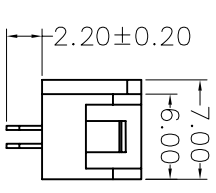
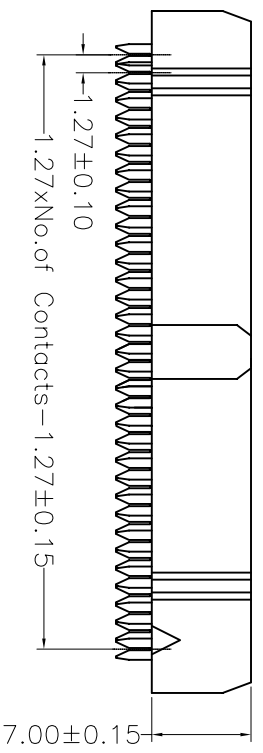
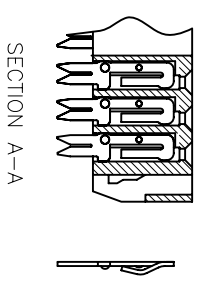
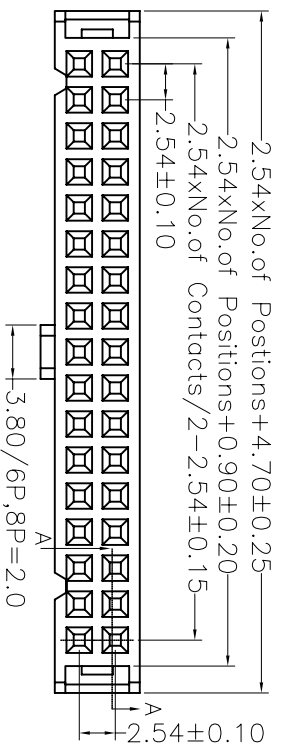

No. of Pins Marker
 06P 26P W=With LR
 08P 30P N=W/O LR
 10P 34P
 12P 36P
 14P 40P
 16P 44P
 18P 50P
 20P 60P
 22P 64P
 24P

X.	± 0.30	X.°	± 5°	UNITS	mm
X	± 0.20	X°	± 2°	MATL	
XX	± 0.10	XX°	± 1°	FINISH	
.XXX	± 0.05	.XXX°	± 0.5°	QTY	

NAME (INTENDED USE)	IDC SOCKET CONNECTOR
PART NO. (INTENDED USE)	
APPD.	SUNNY
CHKD.	USA
DR.	ZOE
	2006-11-28

MINTRON CO., LTD.	
TITLE: 2.54IDC SOCKET+(LR)ONE SIDE CONTACT	
DWG NO.:	MTFC-16-XXXX
SCALE	1/1
SHEET	1/1
REV.	A