

### Features

- Low on-resistance.
- ESD Protected Gate Up to 2KV HBM
- High-speed switching.
- Drive circuits can be simple.
- Parallel use is easy.



### Typical Applications

- N-channel enhancement mode effect transistor.
- Switching application.

### Mechanical Data

- Case: SOT-23, SOT-323, SOT-523, DFN1006-3.
- Molding Compound, UL Flammability Classification Rating 94V-0.
- Terminals: Matte Tin Plated Leads, Solderable Per MIL-STD-202, Method 208.

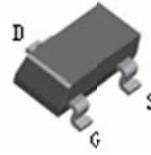

2N7002H  
SOT-23

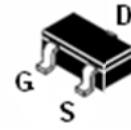

2N7002HW  
SOT-323



2N7002HT  
SOT-523



2N7002HL  
DFN1006-3

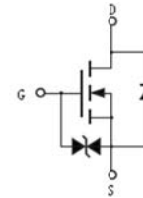

### Ordering Information

Part Number	Package	Shipping	Marking Code
2N7002H□	SOT-23	3000/Tape&Reel	7002K
2N7002HW□	SOT-323	3000/Tape&Reel	RKS
2N7002HT□	SOT-523	3000/Tape&Reel	7002K
2N7002HL□	DFN1006-3	10000/Tape&Reel	72

□: none is for Lead Free package;

“G” is for Halogen Free package.

### Maximum Ratings (@T<sub>A</sub>=25°C unless otherwise specified)

Parameter	Symbol	Value	Units
Drain-Source Voltage	V <sub>DSS</sub>	60	V
Gate -Source Voltage	V <sub>GSS</sub>	±20	V
Continuous Drain Current	I <sub>D</sub>	300	mA
Pulsed Drain Current <sup>(NOTE4)</sup>	I <sub>DM</sub>	800	mA
Power Dissipation	P <sub>D</sub>	SOT-23	0.35
		SOT-323	0.25
		SOT-523	0.15
		DFN1006-3	0.15

**Thermal Characteristics**

Parameter	Symbol	Limits	Unit
Thermal Resistance Junction to Ambient Air	$R_{\theta JA}$	357	°C/W
		500	
		833	
		833	
Operating Junction Temperature Range	$T_j$	150	°C
Storage Temperature Range	$T_{STG}$	-55 to +150	°C

**Electrical Characteristics (@ $T_A=25^\circ\text{C}$  unless otherwise specified)**

Symbol	Parameter	Test conditions	MIN	TYP	MAX	UNIT
<b>OFF Characteristics</b>						
$V_{DSS}$	Drain-Source Breakdown Voltage	$V_{GS}=0V, I_D=250\mu A$	60	-	-	V
$I_{DSS}$	Drain to Source Leakage Current	$V_{DS}=60V, V_{GS}=0V$	-	-	1	$\mu A$
$I_{GSS}$	Gate-body Leakage	$V_{GS}=\pm 20V, V_{DS}=0V$	-	-	$\pm 10$	$\mu A$
<b>ON Characteristics</b> <sup>(NOTE2)</sup>						
$R_{DS(ON)}$	Static Drain-Source On-resistance	$V_{GS}=5V, I_D=0.05A$	-	1.5	3	$\Omega$
		$V_{GS}=10V, I_D=0.5A$	-	1.45	2.5	
$V_{GS(TH)}$	Gate Threshold Voltage	$V_{DS}=V_{GS}, I_D=250\mu A$	1	1.5	2.5	V
<b>Dynamic Characteristics</b> <sup>(NOTE3)</sup>						
$C_{iss}$	Input Capacitance	$V_{GS}=0V$	-	41	-	pF
$C_{oss}$	Output Capacitance	$V_{DS}=20V$	-	15	-	
$C_{rss}$	Reverse Transfer Capacitance	$f=1.0MHz$	-	4	-	
<b>Switching Characteristics</b> <sup>(NOTE3)</sup>						
$t_{d(on)}$	Turn-on Delay Time	$V_{DD}=30V, I_D=0.2A$ $V_{GS}=10V, R_G=25\Omega$ $R_L=150\Omega$	-	6	-	nS
$t_r$	Turn-on Rise Time		-	5	-	
$t_{d(off)}$	Turn-Off Delay Time		-	25	-	
$t_f$	Turn-Off Fall Time		-	15	-	
<b>Source-Drain Diode Characteristics</b>						
$V_{SD}$	Diode Forward Voltage <sup>(NOTE1)</sup>	$I_S=0.3A, V_{GS}=0V$	-	0.85	1.2	V
$I_S$	Diode Continuous Forward Current	$T_C=25^\circ\text{C}$	-	-	0.3	A

NOTE:

- Surface Mounted on FR4 Board,  $t \leq 10$  sec
- Pulse Test: Pulse Width  $\leq 300\mu s$ , Duty Cycle  $\leq 2\%$ .
- Guaranteed by design, not subject to production.
- Pulse width limited by maximum junction temperature.

Ratings and Characteristic Curves ( $T_A=25^{\circ}\text{C}$  unless otherwise noted)

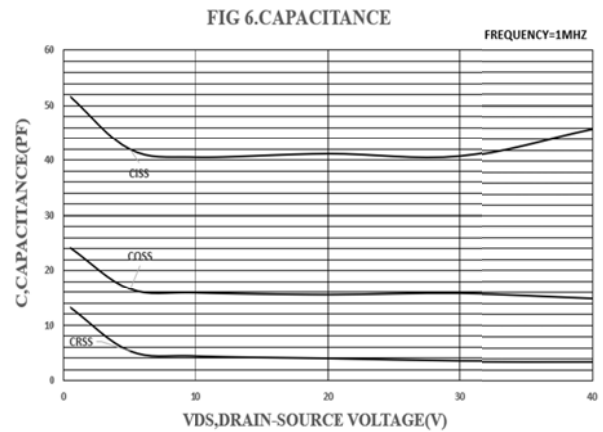
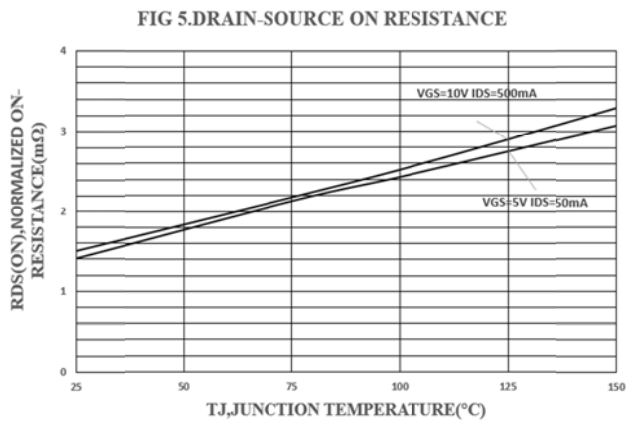
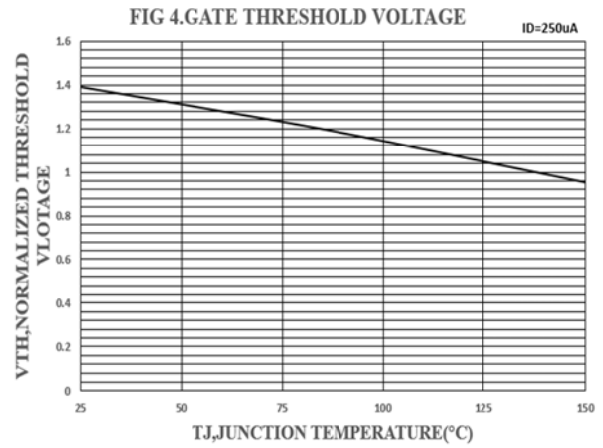
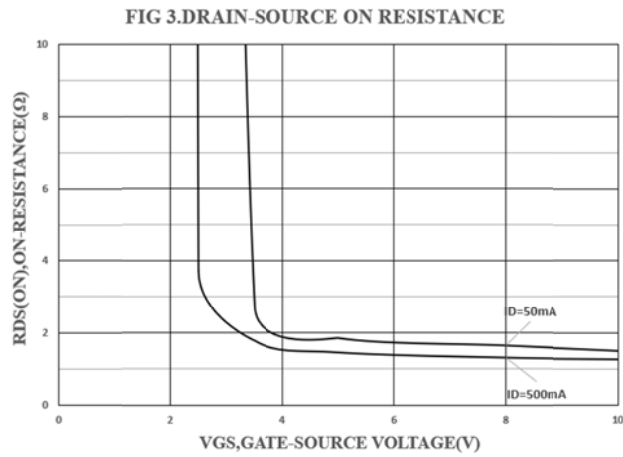
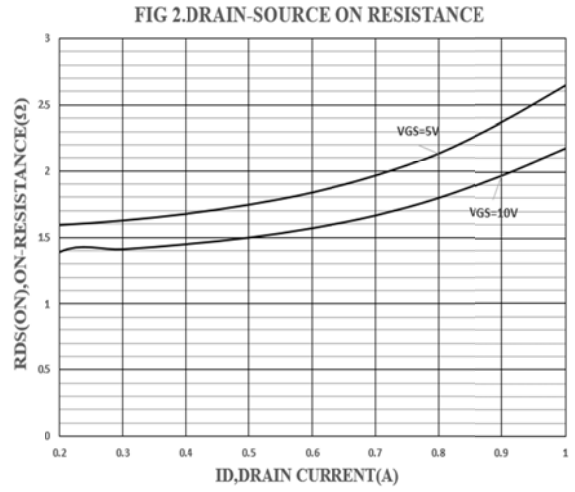
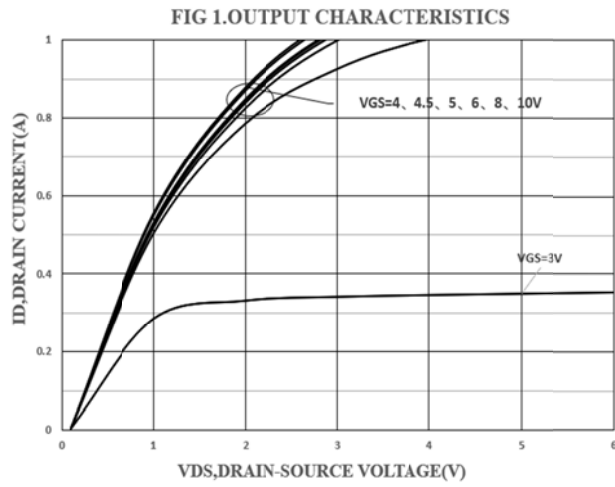

### Package Outline Dimensions (unit:mm)

#### SOT-23

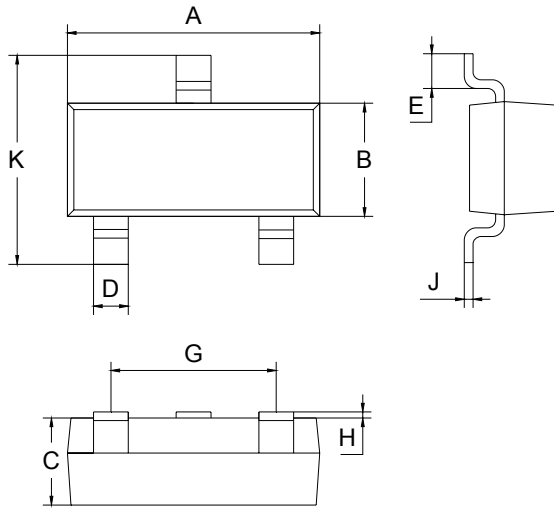

SOT-23		
Dim	Min	Max
A	2.70	3.10
B	1.10	1.50
C	0.90	1.10
D	0.30	0.50
E	0.35	0.48
G	1.80	2.00
H	0.02	0.10
J	0.05	0.15
K	2.20	2.60

#### SOT-323

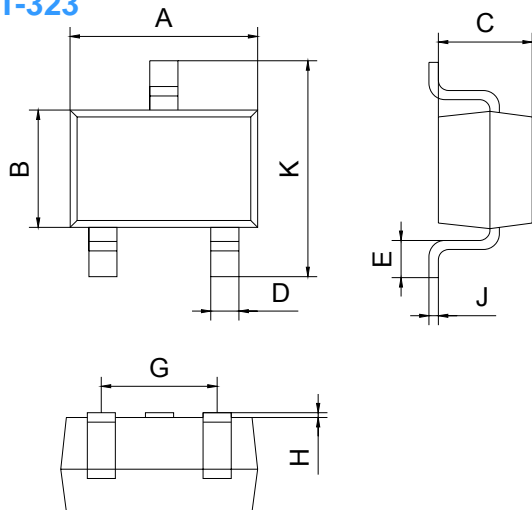

SOT-323		
Dim	Min	Max
A	2.00	2.20
B	1.15	1.35
C	0.90	1.10
D	0.15	0.35
E	0.25	0.40
G	1.20	1.40
H	0.02	0.10
J	0.05	0.15
K	2.20	2.40

#### SOT-523

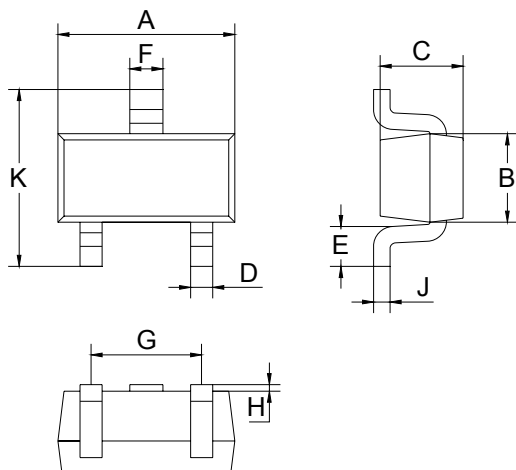

SOT-523		
Dim	Min	Max
A	1.50	1.70
B	0.75	0.85
C	0.60	0.80
D	0.15	0.30
E	0.30	0.40
F	0.25	0.40
G	0.90	1.10
H	0.02	0.10
J	0.08	0.18
K	1.45	1.75

DFN1006-3

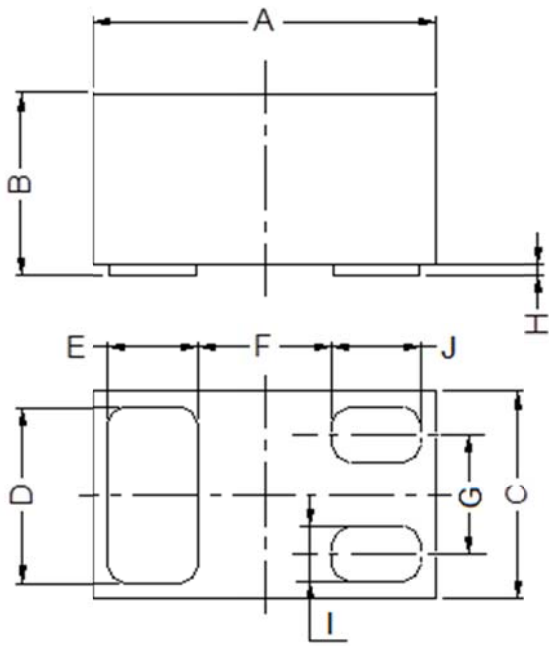

DFN1006-3			
Dim	Min	Typ	Max
A	0.95	1.00	1.075
B	0.47	0.50	0.53
C	0.55	0.60	0.675
D	0.45	0.50	0.55
E/J	0.20	0.25	0.30
F	-	0.40	-
G	-	0.35	-
H	0	0.03	0.05
I	0.10	0.15	0.20
All Dimensions in mm			

Mounting Pad Layout(unit:mm)

SOT-23

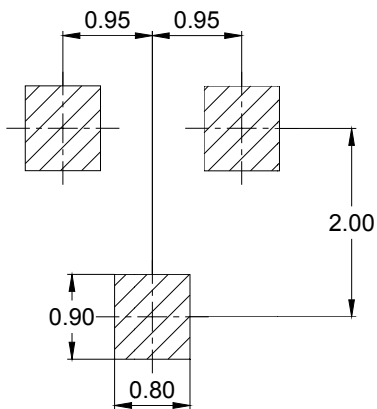

SOT-323

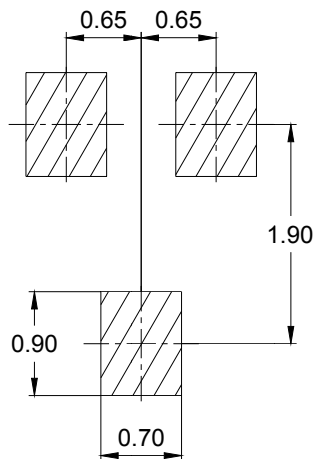

SOT-523

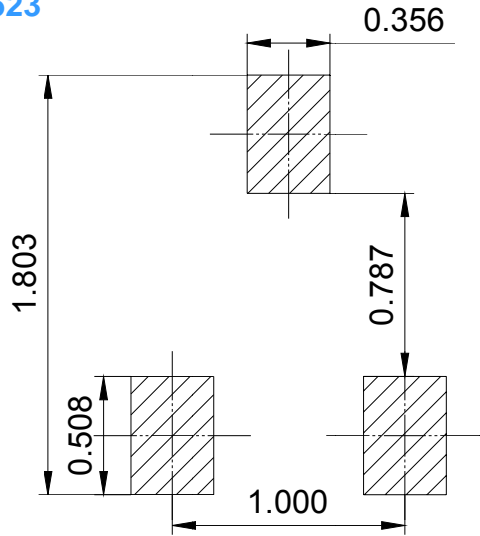

DFN1006-3

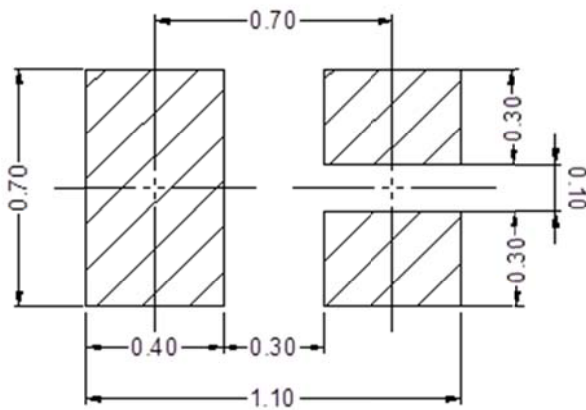

IMPORTANT NOTICE

Galaxy Microelectronics (GME) reserves the right to make changes without further notice to any product herein to make corrections, modifications, improvements, or other changes. GME does not assume any liability arising out of the application or use of any product described herein; neither does it convey any license under its patent rights, nor the rights of others.