

ABIDE BY ROHS

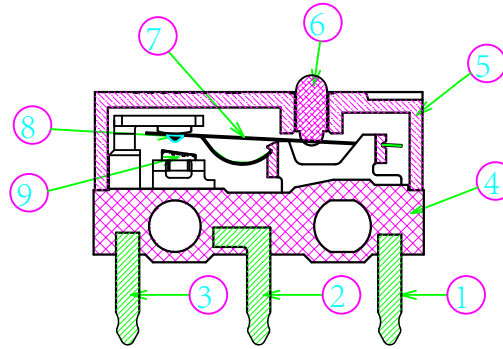

■ Specification :

- 1. Rating : DC30V 0.1A ; Circuit: COM-NO
- 2. Contact Resistance : 100mΩ Max
- 3. Insulation Resistance : 100MΩ Min(DC250V)
- 4. Withstand Voltage : AC500V(50-60Hz) for 1 minute
- 5. Operation Force : 65±15 gf
- 6. Releasing Force : 20gf (Min)
- 7. Operating Position : 6.90±0.2 mm
- 8. Mechanical Life : 30,000,000 Cycles(min)

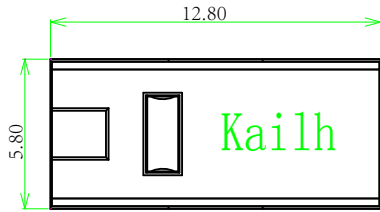
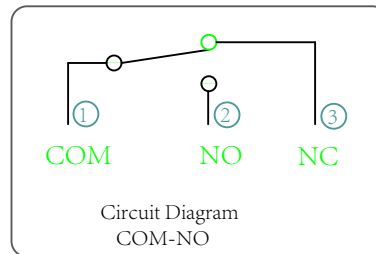
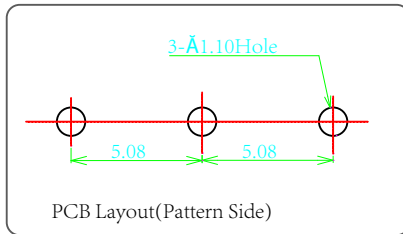
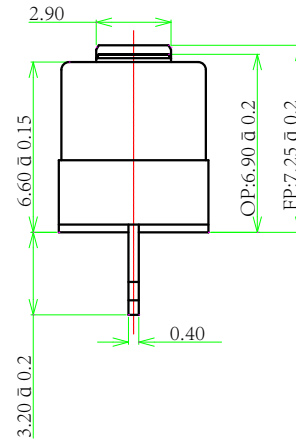
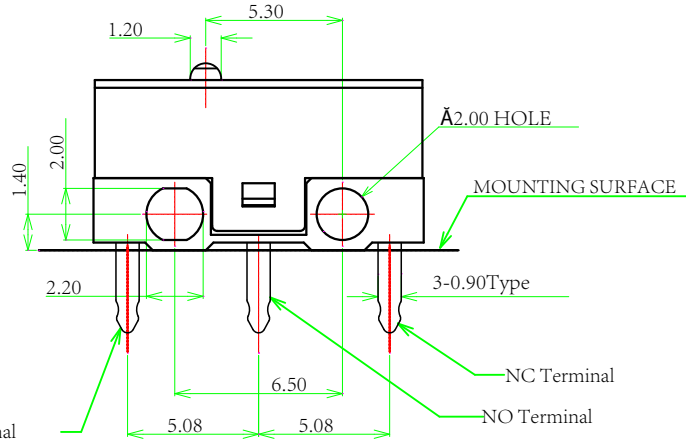

ITEM	PART NAME	TER.NO.	QTY.	MATERIAL	FINISHING	REMARK
⑨	Contact	1	1	Silver Alloy	Natural	
⑧	Contact	1	1	Composite gold	Natural	
⑦	Shrapnel	1	1	Copper Alloy	Natural	
⑥	Keystoke	1	1	POM	Blue	
⑤	Cover	1	1	PBT	Black	
④	Base	1	1	PBT	Black	
③	Nc Terminal	3	1	BRASS	Ag-Plated	
②	No Terminal	2	1	BRASS	Ag-Plated	
①	Com Terminal	1	1	BRASS	Ag-Plated	

APPROVALS		DATE	东莞市凯华电子有限公司 DONGGUAN CITY KAIHUA ELECTRONICS CO.,LTD			
DRAWN	Jerry.Ye	2015.04.25	Kailh			
CHECKED			TITLE: 30M Micro Switch			
APPROVALS			Customer No.			
			PART NO. CMI126603D09			
TOLERANCES ARE		±0.30	ANGLE	UNIT: mm	SCALE: 1:1	PROJ :
		±0.20				
		±0.15				
		±0.10	±2°	DRAWING NO.	KHA-MI1266-004EN	SHEET 1 OF 1

ECN NO.	REV.	DATE.	DESCRIPTION.	CHANGE.	CHECK.	APPRO.
	B	2016.04.25	UPDATED SWITCH STRUCTURE		L.Zhang	
	A	2015.09.02	NEW		L.Zhang	