

承 認 書

SPECIFICATION FOR APPROVAL

| | |
|--|-------------------|
| *客戶名稱 Customer name | : 立創 |
| *產品名稱 Product Description | : 微动开关 |
| *產品型號 Product part number | : RTM2-5C4S05A200 |
| *客戶料號 Customer's material number | : |
| *數量 Quantity | : 0 PCS |
| *日期 Date | : 2019-6-27 |

| 供應商負責人簽名 | | 客戶負責人確認簽回 | |
|----------|-----|-----------|--|
| 製作人 | 莫丽琴 | 承認人 | |
| 審核 | 李跃鑫 | 審核 | |
| 批准 | 王瑞宝 | 批准 | |

皓宇(香港)有限公司
HAOYU (HONG KONG) LIMITED
六均电子五金有限公司
LEGION ELECTRONIC&HARDWARE CO., LTD
富力隆电子(深圳)有限公司
ROCKTEK ELECTRONICS (SHENZHEN) CO. LTD
東莞市石碣鎮四村第一工業區
Sicun 1st Industrial park, Sicun,
Shijie Town, Dongguan

電 話 : (86) 769-82310511-2
Tel No

傳 真 : (86) 769-82310510
Fax No

郵 箱 : haoyu888@21cn.com
E - mail

核 准 :
Approved

1 2 3 4

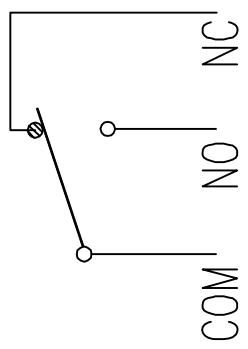

CIRCUIT OF SWITCH

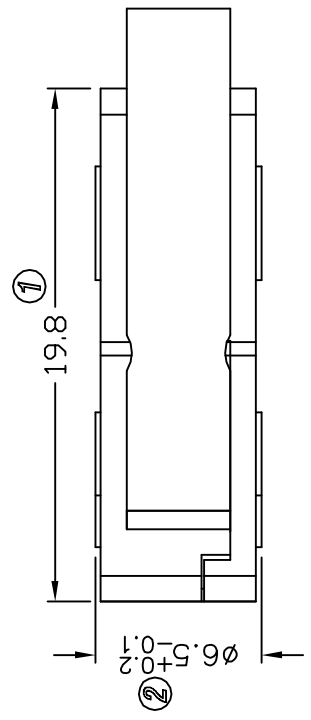

- NOTES:
- 1.RATING: 5A125/250VAC.
 - 2.OPERATING FORCE: 0~100gf
 - 3.CONTACT RESISTANCE: <math>< 50m\Omega</math>
 - 4.INSULATION RESISTANCE: >100M Ω (500VDC BETWEEN OPEN CONTACTS)
 - 5.DIELECTRIC STRENGTH: >1500Vac 0.5mA 1 MINUTE
 - 6.COLOR: BLACK
 - 7.COMPLY WITH THE REQUIREMENTS OF THE EU DIRECTION 2002/GS/EC ROHS AND SUBSEQUENT AMENDMENTS.
 - 8.UL FILE NO.: E300970.

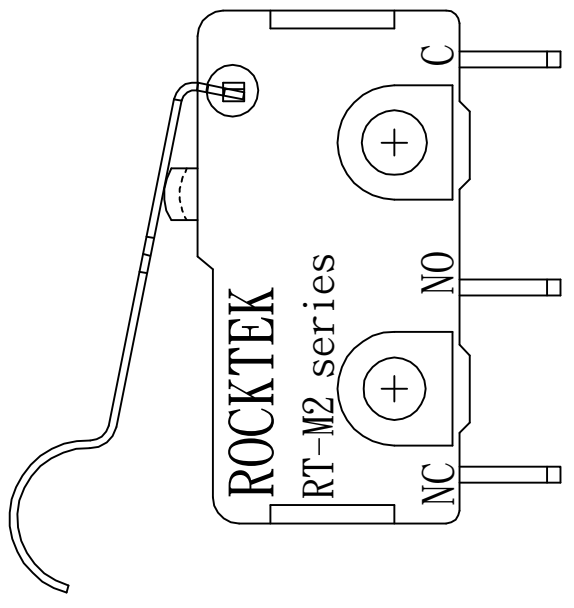
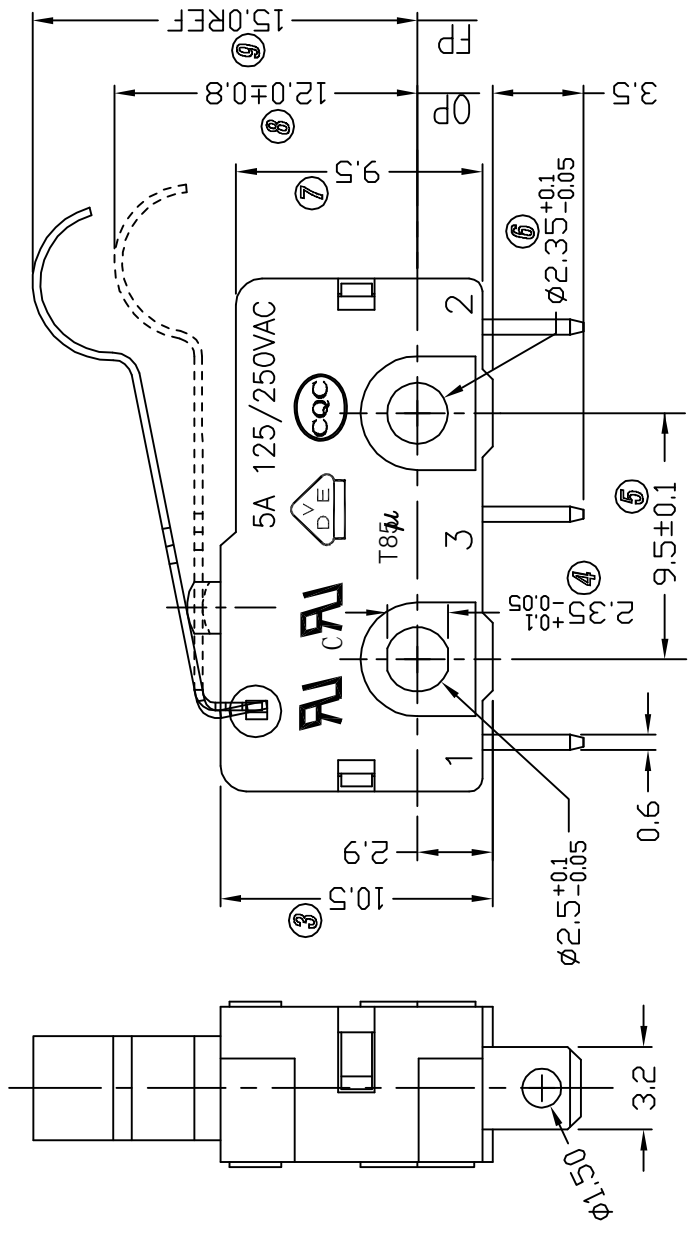

| NO | DESCRIPTION | DIMENSIONAL TOLERANCES | | | APPROVED | CHECKED | DESIGN | DRAWN | ALL SIZE ARE IN | | | | |
|----|-------------|------------------------|-----------|--------|----------|---------|--------|--|-----------------|--------------|-----------------|-----|-------|
| | | RANGE | TOLERANCE | ANGLES | | | | | MM | FIT | REV | | |
| 5 | → | | | | | | | SCALE | MAT'L | MATERIAL NO. | DRAWING NO. | REV | |
| 4 | → | X | ±0.4 | | | | LIUYU | *** | | | | A | |
| 3 | → | X.X | ±0.3 | | | | | | | | | | |
| 2 | → | X.XX | ±0.2 | | | | | | | | | | |
| 1 | → | | | | | | | | | | | | |
| NO | DESCRIPTION | | | | | | | | | | | | |
| | | | | | | | | ROCK TEK ELECTRICAL(SHENZHEN) CO.,LTD. | | | RTM2-5C4S05A200 | | ***** |
| | | | | | | | | LIUYU | | | RMT2-5C4S05A200 | | ***** |
| | | | | | | | | ROCKTEK | | | RT-M2 series | | |

1 2 3 4

Specification Of RT-M2 Micro Switch

page:1/2

1.Scope

This specification covers the requirements for RT-M2 micro switch.

2.Outline and dimensions

Outline and dimensions of the switch is shown on the following drawing.

3.Rating

5A 125/250VAC

4.Approval

UL,CUL,VDE,CQC.

5.Standard

UL1054,IEC60158,GB10592

6.Operation temperature range

This micro switch should be used T85.

Ambient Humidity: at 40°C,Max.85%R.H

7.Circuit arrangement:

Single pole single throw.(SPST)

8.Life

The mechanical life should be 1,000,000 cycles Min.

The electrical life should be 10,000 cycles Min 5A 125/250VAC.

9.Operating force range

The operating force(OF) rang:10~100gf

10.Operating characteristics

Free Position(FP): 15.0max

Operating position(OP): 12.0±0.8mm

Movement Differential(MD): Max.0.4mm

Pre Travel(PT): Max.1.1mm

11.Electrical

11.1.Contact resistance

Contact resistance should not exceed $50m\Omega$.

11.2.Dielectric strength

The switch should withstand a potential of direct current 1500V/minute.

11.3.Insulation resistance

Insulation resistance between pins should not be less than $100M\Omega$.

It is measured with 500VDC.

12.Soldering

The terminals shall be well soldered of dipped place of immersed place in the solder.

Dipped in molten solder of $260\pm 5^{\circ}C$ and the dwell time in solder is 3~5 seconds and

More than 75% of the dipped past shall be covered by solder.

13.Packing

100pcs/Plate. 5000pcs/CTN

| APPROVED | CHECK | DESCRIPTION |
|----------|----------------|-------------|
| | 刘美昌 2016.04.05 | Yale |



WOYR2.E300970 Switches, Appliance and Special Use - Component

For enhanced search functionality, please visit UL's [iQ™ Family of Databases](#).

Click on a product designation for complete information.

[Page Bottom](#)

Switches, Appliance and Special Use - Component

[See General Information for Switches, Appliance and Special Use - Component](#)

ROCK TEK ELECTRONICS INDUSTRY CORP

E300970

98 GUANGUANG RD

BAO'AN DISTRICT, GUANLAN TOWN

SHENZHEN, GUANGDONG 518110 CHINA

Investigated to ANSI/UL 1054

| Cat. No. | Amps | Volts | Hz | Load | Endurance | Temp C | POL/THR | Per Pole/Circuit Code | SPCOA |
|--|------|-------|-------|-------|-----------|--------|---------|-----------------------|----------|
| M1 | 7.5 | 125 | 60 | GP | 6K | 75 | 1/2 | -/A | - |
| | 5 | 250 | 60 | GP | 6K | | | | |
| RT-M2,f/b 0, 1, 2, 3, 4, 5 or 6 | | | | | | | | | |
| | 5 | 125 | 60 | GP | 6K | 85 | 1/2 | -/A | - |
| | 5 | 250 | 60 | GP | 6K | | | | |
| | 6 | 30 | DC | R | 6K | | | | |
| RT-P02 | 7 | 14 | DC | - | 6K | 65 | 1/2 | -/A | - |
| RT-P03 | 16 | 125 | 60 | GP | 6K | 85 | 1/1 | -/A | Note 2 |
| | 16 | 250 | 60 | GP | 6K | | | | |
| | - | 125 | 60 | 3/4hp | 6K | | | | |
| RT-P04 | 16 | 125 | 60 | GP | 6K | 95 | 1/1 | -/A | - |
| | - | 125 | 60 | 1/2hp | 6K | | | | |
| RT-P05 | 14 | 125 | 50/60 | GP | 6K | 65 | 2/1 | -/B | Note 11A |
| | 14 | 250 | 50/60 | GP | 6K | | | | |
| | - | 125 | 50/60 | 1/2hp | 6K | | | | |
| | - | 250 | 50/60 | 1hp | 6K | | | | |
| RT-S01 | 10 | 125 | 60 | GP | 6K | 85 | 1/1 | -/A | - |
| | 6 | 250 | 60 | GP | 6K | | | | |
| RT-S01A | 10 | 125 | 60 | GP | 6K | 85 | 1/1 | -/A | Note 2 |
| | 6 | 250 | 60 | GP | 6K | | | | |
| RT-S02 | 15 | 125 | 60 | GP | 6K | 85 | 1/1 | -/A | - |
| | 8 | 250 | 60 | GP | 6K | | | | |
| RT-S02A | 15 | 125 | 60 | GP | 6K | 85 | 1/1 | -/A | Note 2 |
| | 8 | 250 | 60 | GP | 6K | | | | |
| RT-S03 | 16 | 125 | 60 | GP | 6K | 105 | 2/1 | -/B | - |
| | 16 | 250 | 60 | GP | 6K | | | | |
| | - | 125 | 60 | 1/3hp | 6K | | | | |
| RT-S03A | 16 | 125 | 60 | GP | 6K | 105 | 2/1 | -/B | Note 2 |
| | 16 | 250 | 60 | GP | 6K | | | | |

| | | | | | | | | | |
|------------------------------|----|-----|----|-------|----|-----|-----|-----|--------|
| | - | 125 | 60 | 1/3hp | 6K | | | | |
| RT-S05 | 15 | 125 | 60 | GP | 6K | 125 | 2/2 | -/B | - |
| RT-S06 f/b A or Blank | 16 | 125 | 60 | GP | 6K | 85 | 1/1 | -/A | Note 2 |
| | 10 | 250 | 60 | GP | 6K | | | | |
| | - | 125 | 60 | 3/4hp | 6K | | | | |
| | - | 250 | 60 | 1hp | 6K | | | | |

Note 11A - Switch may be marked with the voltage rating single or double underlined for tested using 240 V or 250 V to ground.

Note 2 - These are lighted switches employing a lamp. The usable lamp life has not been evaluated.

Marking: Company name, catalog, model or part number, electrical ratings and the Recognized Component Mark,  on the product or on the smallest unit container in which the product is packaged.

Last Updated on 2016-07-19

[Questions?](#)

[Print this page](#)

[Terms of Use](#)

[Page Top](#)

◆ 2016 UL LLC

The appearance of a company's name or product in this database does not in itself assure that products so identified have been manufactured under UL's Follow-Up Service. Only those products bearing the UL Mark should be considered to be Certified and covered under UL's Follow-Up Service. Always look for the Mark on the product.

UL permits the reproduction of the material contained in the Online Certification Directory subject to the following conditions: 1. The Guide Information, Assemblies, Constructions, Designs, Systems, and/or Certifications (files) must be presented in their entirety and in a non-misleading manner, without any manipulation of the data (or drawings). 2. The statement "Reprinted from the Online Certifications Directory with permission from UL" must appear adjacent to the extracted material. In addition, the reprinted material must include a copyright notice in the following format: "© 2016 UL LLC".

**WOYR8.E300970****Switches, Appliance and Special Use Certified for Canada - Component**For enhanced search functionality, please visit UL's [iQ™ Family of Databases](#).

Click on a product designation for complete information.

[Page Bottom](#)**Switches, Appliance and Special Use Certified for Canada - Component**[See General Information for Switches, Appliance and Special Use Certified for Canada - Component](#)**ROCK TEK ELECTRONICS INDUSTRY CORP**

E300970

98 GUANGUANG RD

BAO'AN DISTRICT, GUANLAN TOWN

SHENZHEN, GUANGDONG 518110 CHINA

Investigated to CSA-C22.2 No. 55

| Cat. No. | Amps | Volts | Hz | Load | Endurance | Temp C | POL/THR | Per Pole/Circuit Code | SPCOA |
|--|------|-------|-------|-------|-----------|--------|---------|-----------------------|----------|
| M1 | 7.5 | 125 | 60 | GP | 6K | 75 | 1/2 | -/A | - |
| | 5 | 250 | 60 | GP | 6K | | | | |
| RT-M2,f/b 0, 1, 2, 3, 4, 5 or 6 | | | | | | | | | |
| | 5 | 125 | 60 | GP | 6K | 85 | 1/2 | -/A | - |
| | 5 | 250 | 60 | GP | 6K | | | | |
| | 6 | 30 | DC | R | 6K | | | | |
| RT-P02 | 7 | 14 | DC | - | 6K | 65 | 1/2 | -/A | - |
| RT-P03 | 16 | 125 | 60 | GP | 6K | 85 | 1/1 | -/A | Note 2 |
| | 16 | 250 | 60 | GP | 6K | | | | |
| | - | 125 | 60 | 3/4hp | 6K | | | | |
| RT-P04 | 16 | 125 | 60 | GP | 6K | 95 | 1/1 | -/A | - |
| | - | 125 | 60 | 1/2hp | 6K | | | | |
| RT-P05 | 14 | 125 | 50/60 | GP | 6K | 65 | 2/1 | -/B | Note 11A |
| | 14 | 250 | 50/60 | GP | 6K | | | | |
| | - | 125 | 50/60 | 1/2hp | 6K | | | | |
| | - | 250 | 50/60 | 1hp | 6K | | | | |
| RT-S01 | 10 | 125 | 60 | GP | 6K | 85 | 1/1 | -/A | - |
| | 6 | 250 | 60 | GP | 6K | | | | |
| RT-S01A | 10 | 125 | 60 | GP | 6K | 85 | 1/1 | -/A | Note 2 |
| | 6 | 250 | 60 | GP | 6K | | | | |
| RT-S02 | 15 | 125 | 60 | GP | 6K | 85 | 1/1 | -/A | - |
| | 8 | 250 | 60 | GP | 6K | | | | |
| RT-S02A | 15 | 125 | 60 | GP | 6K | 85 | 1/1 | -/A | Note 2 |
| | 8 | 250 | 60 | GP | 6K | | | | |
| RT-S03 | 16 | 125 | 60 | GP | 6K | 105 | 2/1 | -/B | - |
| | 16 | 250 | 60 | GP | 6K | | | | |
| | - | 125 | 60 | 1/3hp | 6K | | | | |
| RT-S03A | 16 | 125 | 60 | GP | 6K | 105 | 2/1 | -/B | Note 2 |
| | 16 | 250 | 60 | GP | 6K | | | | |

| | | | | | | | | | |
|------------------------------|----|-----|----|-------|----|-----|-----|-----|--------|
| | - | 125 | 60 | 1/3hp | 6K | | | | |
| RT-S05 | 15 | 125 | 60 | GP | 6K | 125 | 2/2 | -/B | - |
| RT-S06 f/b A or Blank | 16 | 125 | 60 | GP | 6K | 85 | 1/1 | -/A | Note 2 |
| | 10 | 250 | 60 | GP | 6K | | | | |
| | - | 125 | 60 | 3/4hp | 6K | | | | |
| | - | 250 | 60 | 1hp | 6K | | | | |

Note 11A - Switch may be marked with the voltage rating single or double underlined for tested using 240 V or 250 V to ground.

Note 2 - These are lighted switches employing a lamp. The usable lamp life has not been evaluated.

Marking: Company name, catalog, model or part number, electrical ratings and the Recognized Component Mark for Canada,  on the product or on the smallest unit container in which the product is packaged.

Last Updated on 2016-07-19

[Questions?](#)

[Print this page](#)

[Terms of Use](#)

[Page Top](#)

◆ 2016 UL LLC

The appearance of a company's name or product in this database does not in itself assure that products so identified have been manufactured under UL's Follow-Up Service. Only those products bearing the UL Mark should be considered to be Certified and covered under UL's Follow-Up Service. Always look for the Mark on the product.

UL permits the reproduction of the material contained in the Online Certification Directory subject to the following conditions: 1. The Guide Information, Assemblies, Constructions, Designs, Systems, and/or Certifications (files) must be presented in their entirety and in a non-misleading manner, without any manipulation of the data (or drawings). 2. The statement "Reprinted from the Online Certifications Directory with permission from UL" must appear adjacent to the extracted material. In addition, the reprinted material must include a copyright notice in the following format: "© 2016 UL LLC".

ZEICHENGENEHMIGUNG MARKS APPROVAL

Rock Tek Electronics
(Shenzhen) Co., Ltd.
No. 98 Guanguang Road
Guanlan Town
518110 BAOAN DISTRICT, SHENZHEN CITY
CHINA

ist berechtigt, für ihr Produkt /
is authorized to use for their product

Geräteschalter
Switch for appliances
RT-M2

die hier abgebildeten markenrechtlich geschützten Zeichen
für die ab Blatt 2 aufgeführten Typen zu benutzen /
the legally protected Marks as shown below for the types referred to on page 2 ff.



Geprüft und zertifiziert nach /
Tested and certified according to

DIN EN 61058-1 (VDE 0630-1):2008-09; EN 61058-1:2002 + A2:2008
IEC 61058-1(ed.3);am1;am2



Aktenzeichen: 5004990-4401-0001 / 219495

File ref.:

Ausweis-Nr. 40018193

Blatt 1

Certificate No.

Page

Weitere Bedingungen siehe Rückseite und Folgeblätter /
further conditions see overleaf and following pages

Offenbach, 2006-07-04

(letzte Änderung / updated 2015-12-17)

VDE Prüf- und Zertifizierungsinstitut GmbH
VDE Testing and Certification Institute
Zertifizierungsstelle / Certification

VDE Zertifikate sind nur gültig bei Veröffentlichung unter:
VDE certificates are valid only when published on:

<http://www.vde.com/zertifikat>
<http://www.vde.com/certificate>

Name und Sitz des Genehmigungs-Inhabers / Name and registered seat of the Certificate holder

Rock Tek Electronics (Shenzhen) Co., Ltd., No. 98 Guanguang Road, Guanlan Town, 518110 BAOAN
DISTRICT, SHENZHEN CITY, Guangdong, CHINA

Aktenzeichen / File ref.

5004990-4401-0001 / 219495 / CC1 / LF

letzte Änderung / updated

2015-12-17

Datum / Date

2006-07-04

Dieses Blatt gilt nur in Verbindung mit Blatt 1 des Zeichengenehmigungsausweises Nr. 40018193.

This supplement is only valid in conjunction with page 1 of the Certificate No. 40018193.

Geräteschalter Switch for appliances RT-M2

Typ(en) / Type(s)

RT-M2

| | |
|---|--|
| Bemessungsspannung, AC <i>Rated voltage, AC</i> | 250 V |
| Bemessungsstrom <i>Rated current</i> | 5 A |
| Art und Anschluss von Schaltern <i>Type and connection of switches</i> | Druckknopfschalter, Kode 2.3 <i>Pushbutton switch, Code 2.3</i> |
| Abschaltung <i>Disconnection</i> | Mikroabschaltung <i>Micro disconnection</i> |
| Schaltzyklen <i>Number of operating cycles</i> | 10E3 |
| Umgebungs-Lufttemperatur <i>Ambient air temperature</i> | T 85 |
| Art der Montage <i>Method of mounting</i> | Zum Einbau in Geräte der Schutzklasse I <i>Incorporation in class I equipment</i> |
| Art der Betätigung <i>Method of actuating</i> | Indirekte Betätigung <i>Indirect actuating</i> |
| Schutzgrad durch Gehäuse <i>Degree of protect. provided by enclosure</i> | IP20 nach entsprechendem Einbau <i>IP20 after appropriate incorporation</i> |
| Schalter der Kategorie <i>Switch category</i> | 3 |

Fortsetzung siehe Blatt 3 /
continued on page 3

Name und Sitz des Genehmigungs-Inhabers / Name and registered seat of the Certificate holder

Rock Tek Electronics (Shenzhen) Co., Ltd., No. 98 Guanguang Road, Guanlan Town, 518110 BAOAN DISTRICT, SHENZHEN CITY, Guangdong, CHINA

Aktenzeichen / File ref.

5004990-4401-0001 / 219495 / CC1 / LF

letzte Änderung / updated

2015-12-17

Datum / Date

2006-07-04

Dieses Blatt gilt nur in Verbindung mit Blatt 1 des Zeichengenehmigungsausweises Nr. 40018193.

This supplement is only valid in conjunction with page 1 of the Certificate No. 40018193.

Glühdrahtprüfung (GWT)
Glow-wire test (GWT)

850°C

Kriechstromfestigkeit
Tracking resistance

PTI 175

Anschluss
Type of terminal

Lötanschluß
Solder terminals

Überspannungskategorie
Overvoltage category

II

Verschmutzungsgrad
Degree of pollution

1

Werkstoffgruppe
Material group

IIIa

Weitere Angaben siehe Anlage
Further information see appendix

Nr. 1 vom 2015-12-17
No. 1 dated 2015-12-17

Anmerkung

Die Luft- und Kriechstrecken der Basis- und verstärkten Isolierung zwischen unter Spannung stehenden Teilen und der berührbaren Oberfläche und den Befestigungslöchern müssen durch den Einbau sichergestellt werden.

Remark

The clearance and creepage distances for the reinforced and basic insulation between live parts and the touchable surface and the mounting holes has to be guaranteed by the way of its mounting

Dieser Zeichengenehmigungs-Ausweis bildet eine Grundlage für die EG-Konformitätserklärung und CE-Kennzeichnung durch den Hersteller oder dessen Bevollmächtigten und bescheinigt die Konformität mit den grundlegenden Schutzanforderungen der **EG-Niederspannungsrichtlinie (2006/95/EG bis 19.04.2016, 2014/35/EU ab 20.04.2016)**.

*This Marks Approval is a basis for the EC Declaration of Conformity and the CE Marking by the manufacturer or his agent and proves the conformity with the essential safety requirements of the **EC Low-Voltage Directive (2006/95/EC until 2016-04-19, 2014/35/EU from 2016-04-20)**.*

VDE Prüf- und Zertifizierungsinstitut GmbH
VDE Testing and Certification Institute
Fachgebiet CC1
Section CC1

VDE Prüf- und Zertifizierungsinstitut Zeichengenehmigung

Ausweis-Nr. / Beiblatt /
Certificate No. Supplement
40018193

Name und Sitz des Genehmigungs-Inhabers / *Name and registered seat of the Certificate holder*

Rock Tek Electronics (Shenzhen) Co., Ltd., No. 98 Guanguang Road, Guanlan Town, 518110 BAOAN DISTRICT, SHENZHEN CITY, Guangdong, CHINA

Aktenzeichen / *File ref.*

5004990-4401-0001 / 219495 / CC1 / LF

letzte Änderung / *updated*

2015-12-17

Datum / *Date*

2006-07-04

Dieses Beiblatt ist Bestandteil des Zeichengenehmigungsausweises Nr. 40018193.

This supplement is part of the Certificate No. 40018193.

Geräteschalter

Switch for appliances

RT-M2

Fertigungsstätte(n)

Place(s) of manufacture

Referenz/*Reference*
30016237

Rock Tek Electronics
(Shenzhen) Co., Ltd.
No. 98 Guanguang Road
Guanlan Town
518110 BAOAN DISTRICT, SHENZHEN CITY
Guangdong
CHINA

VDE Prüf- und Zertifizierungsinstitut GmbH

VDE Testing and Certification Institute

Fachgebiet CC1

Section CC1



Name und Sitz des Genehmigungs-Inhabers / Name and registered seat of the Certificate holder

Rock Tek Electronics (Shenzhen) Co., Ltd., No. 98 Guanguang Road, Guanlan Town, 518110 BAOAN DISTRICT, SHENZHEN CITY, Guangdong, CHINA

Aktenzeichen / File ref.

5004990-4401-0001 / 219495 / CC1 / LF

letzte Änderung / updated

2015-12-17

Datum / Date

2006-07-04

Dieses Blatt gilt nur in Verbindung mit Blatt 1 des Zeichengenehmigungsausweises Nr. 40018193.

This supplement is only valid in conjunction with page 1 of the Certificate No. 40018193.

Genehmigung zum Benutzen des auf Seite 1 abgebildeten markenrechtlich geschützten Zeichens des VDE:

Grundlage für die Benutzung sind die Allgemeinen Geschäftsbedingungen (AGB) der VDE Prüf- und Zertifizierungsinstitut GmbH (www.vde.com\AGB-Institut). Das Recht zur Benutzung erstreckt sich nur auf die bezeichnete Firma mit den genannten Fertigungsstätten und die oben aufgeführten Produkte mit den zugeordneten Bezeichnungen. Die Fertigungsstätte muss so eingerichtet sein, dass eine gleichmäßige Herstellung der geprüften und zertifizierten Ausführung gewährleistet ist.

Die Genehmigung ist so lange gültig wie die VDE-Bestimmungen gelten, die der Zertifizierung zugrunde gelegen haben, sofern sie nicht auf Grund anderer Bedingungen aus der VDE Prüf- und Zertifizierungsordnung (PM102) zurückgezogen werden muss.

Der Gültigkeitszeitraum einer VDE-GS-Zeichengenehmigung kann auf Antrag verlängert werden. Bei gesetzlichen und / oder normativen Änderungen kann die VDE-GS-Zeichengenehmigung ihre Gültigkeit zu einem früheren als dem angegebenen Datum verlieren.

Produkte, die das Biozid Dimethylfumarat (DMF) enthalten, dürfen gemäß der Kommissionsentscheidung 2009/251/EG nicht mehr in den Verkehr gebracht oder auf dem Markt bereitgestellt werden.

Der VDE-Zeichengenehmigungsausweis wird ausschließlich auf der ersten Seite unterzeichnet.

Approval to use the legally protected Mark of the VDE as shown on the first page:

Basis for the use are the general terms and conditions of the VDE Testing and Certification Institute (www.vde.com\terms-institute). The right to use the mark is granted only to the mentioned company with the named places of manufacture and the listed products with the related type references. The place of manufacture shall be equipped in a way that a constant manufacturing of the certified construction is assured.

The approval is valid as long as the VDE specifications are in force, on which the certification is based on, unless it is withdrawn according to the VDE Testing and Certification Procedure (PM102E).

The validity period of a VDE-GS-Mark Approval may be prolonged on request. In case of changes in legal and / or normative requirements, the validity period of a VDE-GS-Mark Approval may be shortened.

Products containing the biocide dimethylfumarate (DMF) may not be marketed or made available on the EC market according to the Commission Decision 2009/251/EC.

The approval is solely signed on the first page.



产品认证证书

证书编号: CQC06002017445

申请人名称及地址

富力隆电子(深圳)有限公司
广东省深圳市宝安区观澜大水坑观光公路观澜镇大水坑桔新经济合作社

制造商名称及地址

富力隆电子(深圳)有限公司
广东省深圳市宝安区观澜大水坑观光公路观澜镇大水坑桔新经济合作社

生产企业名称及地址

富力隆电子(深圳)有限公司 (V006093)
广东省深圳市宝安区观澜大水坑观光公路观澜镇大水坑桔新经济合作社

产品名称和系列、规格、型号

按钮开关(微动开关)

RT-M2 系列 5A 125/250VAC 50Hz I85 μ 1E4 PII175 锡焊端头 污染等级2

产品标准和技术要求

GB15092.1-2010

认证模式

产品型式试验+初次工厂检查+获证后监督

上述产品符合CQC11-462124-2009认证规则的要求, 特发此证。

发证日期: 2016年04月06日

证书有效期内本证书的有效性依据发证机构的定期监督获得保持。

本证书为变更证书, 证书首次颁发日期: 2006年09月22日

主任: _____



中国质量认证中心

中国·北京·南四环西路188号9区100070

<http://www.cqc.com.cn>

C 0082567