

DORABO®

Cixi Dibo Electronics Co., LTD

产品规格书
product specification

电气性能/Electrical

参考标准/Standard: UL IEC
 额定电压/Rated voltage: 300V 320V
 额定电流/Rated current: 15A 20A

接触电阻/Contact resistance: 20m Ω

耐电压/Withstanding voltage: AC2000V/1Min

绝缘电阻/Insulation resistance: 500M Ω /DC500V

机械性能/Mechanical

温度范围/Temp Range: -40 $^{\circ}$ C~+105 $^{\circ}$ C

瞬间温度/MAX Soldering: +250 $^{\circ}$ C, for 5 Sec

尺寸/Dimensions

间距/Pitch: 7.5mm, 7.62mm

极数/Poles: 2P~24P

材料及电镀/Material

塑件/Housing: PA66, UL94V-0

焊针/Pin header: Brass, Tin plated

螺母/Nut: M2.5 Brass

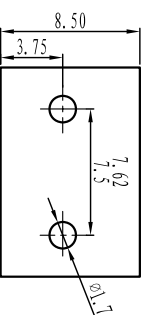
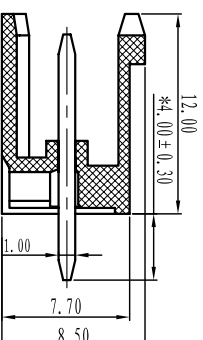
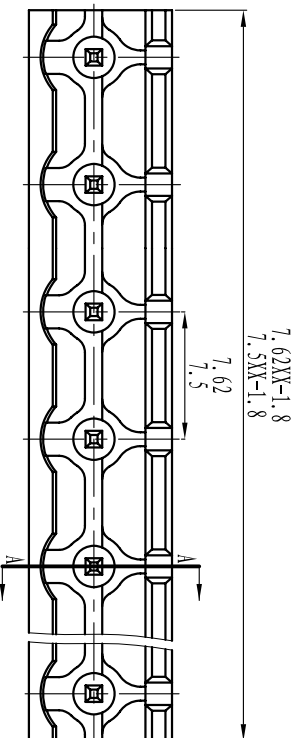

TOLERANCES EXCEPT AS NOTED

	linear dimension	fillet	chamfer	short angle sid	≡	□	//	⊥
variable range	6 to 30 over 30	all to 480 over 480	6 to 6 over 6	10 to 10 over 10	all to 5 over 5	5 to 30 over 30	120 to 120 over 120	
tolerance	±0.1 to ±0.2	±0.2 to ±0.3	±0.2 to ±0.5	±1 to ±1	0.025 to 0.025	0.06 to 0.06	0.12 to 0.12	0.4 to 0.4

订购方式 : HOW TO ORDER

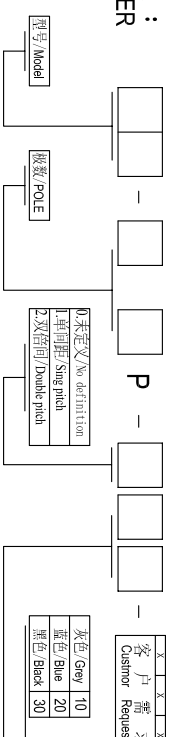

1.未定义/No definition
2.单向孔/Sing Pinch
2.双向孔/Double Pinch

客户请求
灰色/Gray 10
蓝色/Blue 20
黑色/Black 30
绿色/Green 40
棕色/Orange 50
红色/Red 60
透明/Transparent 70
黄色/Yellow 80
白色/White 90

单位/UNITS mm 尺寸/SIZE A4 比例/SCALE

第一视角/FIRST ANGLE PROJECTION

Cixi Dibo Electronics Co., LTD

名称/NAME DB2EV-7.62-XXP