

REVISIONS				
REV	ECO	DESCRIPTION	DATE	BY APPR
B1	-	RELEASED DRAWING	AUG-16-2014	BEN TOMMY

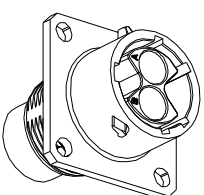

NOTES : (UNLESS OTHERWISE SPECIFIED)

1. MATERIAL :
SHELL : ZINC ALLOY , NICKEL PLATED.
INSERT : THERMOPLASTIC , UL94 V-0.
SEAL GASKET : NBR/SILICONE RUBBER.
2. SPECIFICATIONS :
2.1 RATED CURRENT :
2.1.1 2.5mm CONTACT 23A (MAX) .
2.1.2 20# CONTACT 5A (MAX) .
2.2 RATED VOLTAGE : 350V (AC/DC) .
2.3 OPERATING TEMPERATURE : SEE CHART .
2.4 DIELECTRIC WITHSTANDING VOLTAGE : LESS THAN 2 MILLIAMPS CURRENT LEAKAGE@2000 VOLTS AC.
2.5 INSULATION RESISTANCE : 5000 MEGOHMS MIN.
2.6 IP--CLASS : IP67.
2.7 MATING CYCLES DURABILITY : 500 CYCLES MIN.
2.8 ROHS COMPLIANT.
3. SUITABLE CONTACTS : 2.5mm & 20# CONTACTS.
4. ALL DIMENSIONS ARE FOR REFERENCE USE ONLY.

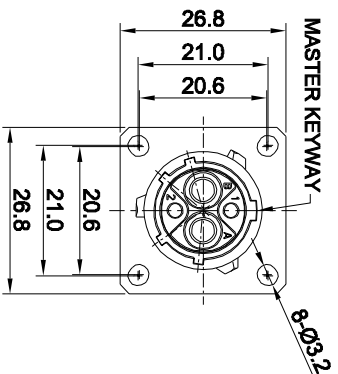
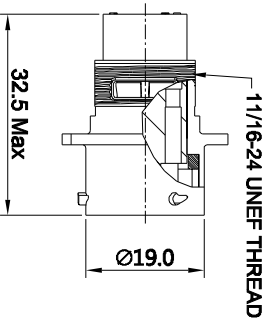
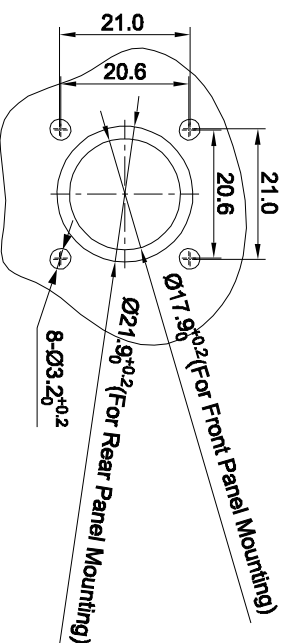

KEY POS	PART NUMBER
-40°C ~ 105°C	-40°C ~ 125°C
N	RT00122PN
W	RT00122PW
X	RT00122PX
Y	RT00122PY
Z	RT00122PZ

QUANTITY	SEE PART NUMBER CHART	PART NUMBER	DESCRIPTION	ITEM
MATERIALS LIST				

SIGNATURES	DATE
DRAWN: BBI	11/5/11
CHECKED: [Signature]	
ENGINEER: [Signature]	
APPROVAL: [Signature]	
CUSTOMER: [Signature]	

UNLESS OTHERWISE SPECIFIED	PROCESS SPECIFICATIONS:	THIS DRAWING IS SUPPLIED FOR INFORMATION ONLY. IT IS NOT TO BE USED FOR THE MANUFACTURE OF REPRODUCTION AND PERFORMANCE DATA. THE DRAWING IS THE PROPERTY OF AMPHENOL AND ALL RIGHTS OF REPRODUCTION ARE RESERVED. ALL MANUFACTURING VARIATION	SIZE	TYPE	DWG NO.	REVISION
1) ALL DIMENSIONS ARE IN MILLIMETERS. 2) TOLERANCES ARE AS SHOWN. 3) HOLE REFERENCE = [Symbol]	1. PL. DEC 50-20 2. PL. DEC 50-20 3. PL. DEC 50-20		B	C-	RT00122P##	B1
ECO-MATE RECEPTACLE, SIZE 12.2POS. PIN.			SCALE: NONE	SHEET 1	OF 1	