

本公司智慧財產，未經同意不得複製  
DAILYWELL copyright, may not be used  
without permission from DAILYWELL

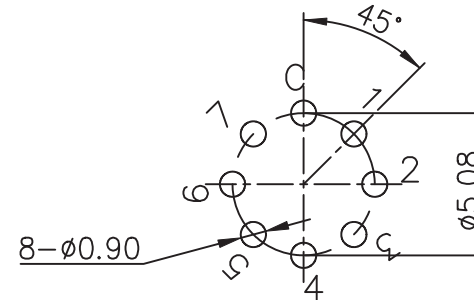
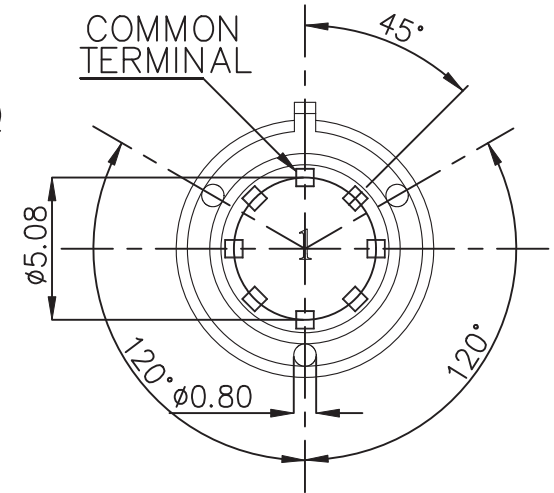
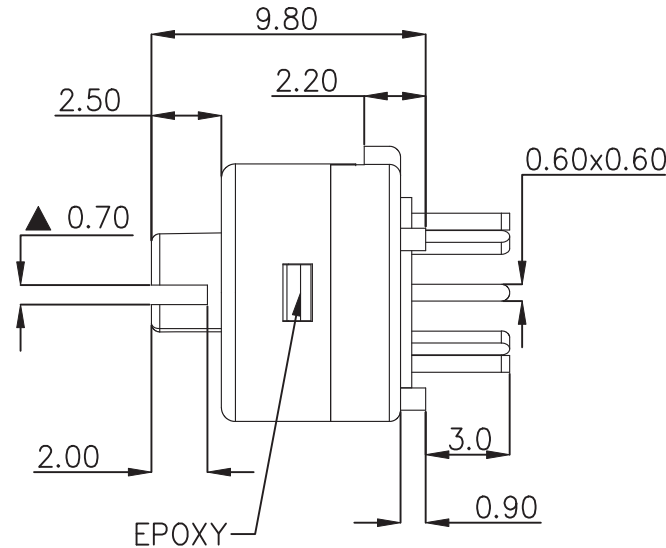
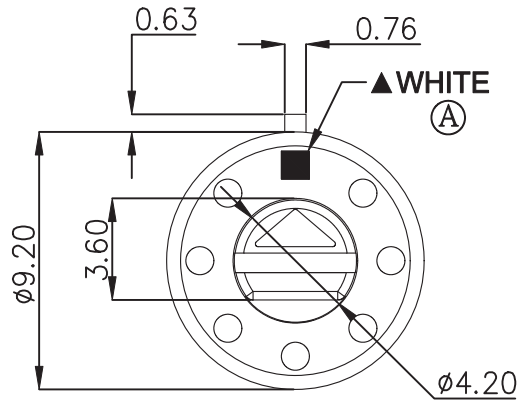

P.C.B. LAYOUT

TRAVEL	SWITCH POSITION
0°	C-C(OFF)
45°	C-1
90°	C-2
135°	C-3
180°	C-4
225°	C-5
270°	C-6
315°	C-7

**SPECIFICATIONS**

ELECTRICAL RATING: 0.5A 24VDC; 0.2A 48VDC  
 CONTACT RESISTANCE: 100 mΩ MAX.  
 INSULATION RESISTANCE: 100 MΩ MIN. 500VDC  
 DIELECTRIC STRENGTH: 500VAC for 1 minute  
 OPERATING FORCE: 350±150g (A)  
 OPERATING LIFE: 2,000 cycles  
 OPERATING TEMPERATURE RANGE : -20°C ~ 70°C

MATERIAL  
 HOUSING: NYLON 6/6  
 BASE: LCP  
 ACTUATOR: NYLON 6/6  
 TERMINAL: Brass gold plating.  
 RoHS: 2002/95/EC

**德利威電子股份有限公司**  
**DAILYWELL ELECTRONICS CO.,LTD.**

符號	原尺寸	修改後尺寸	變更日期
1 (A)	CONN標示變更參照ECN GC11081,350±100g變更±150g		SEP-05-2011
2 (B)			
3 (C)			
4 (D)			
5 (E)			

SCALE (比例): 4 : 1  
 TOLERANCE (公差):  
 0.00 mm ± 0.25mm  
 0.0 mm ± 0.40mm  
 ANGULAR : ± 5°  
 FILE NAME : RT0023

TITLE 圖名	ROTARY SWITCH			SIZE 圖紙	A4
DWG NO. 圖號	RT-0C8-D			UNIT 單位	mm
REV. 版本	B	DATE 日期	APR - 01 - 2011	SHEET 張數	1 of 1
CHECKED BY 審核	RICHARD		DRAWN BY 製圖	IRENE	