



E502650

Features

- High Surge Forward Current Capability
- Glass Passivated Chip
- Lead Free Finish/RoHS Compliant (Note1) ("P" Suffix Designates Compliant. See Ordering Information)
- Epoxy Meets UL 94 V-0 Flammability Rating
- Moisture Sensitivity Level 1

Maximum Ratings

- Operating Junction Temperature Range: -55 °C to +150 °C
- Storage Temperature Range: -55 °C to +150 °C
- Thermal Resistance: 0.8°C/W Junction to Case

MCC Part Number	Device Marking	Maximum Recurrent Peak Reverse Voltage	Maximum RMS Voltage	Maximum DC Blocking Voltage
3GBJ3508	3GBJ3508	800V	560V	800V
3GBJ3510	3GBJ3510	1000V	700V	1000V
3GBJ3516	3GBJ3516	1600V	1120V	1600V

Electrical Characteristics @ 25°C Unless Otherwise Specified

Average Forward Current	$I_{F(AV)}$	35A	$T_C = 110^\circ\text{C}$
Peak Forward Surge Current	I_{FSM}	400A	8.3ms, Half Sine
Maximum Instantaneous Forward Voltage	V_F	1.1V	$I_{FM} = 17.5\text{A}$
Maximum DC Reverse Current at Rated DC Blocking Voltage	I_R	10μA	$T_A = 25^\circ\text{C}$
Dielectric Strength	V_{dis}	2.5KV	
Maximum Mounting Torque	T_{or}	8kg·cm	Recommend torque 5kg·cm
Current Squared time	I^2t	660A ² s	$t < 8.3\text{ms}$

Note

1: High Temperature Solder Exemption Applied, see EU Directive Annex 7a.

35 Amp Bridge Rectifier 800 to 1600 Volts

TSB-5

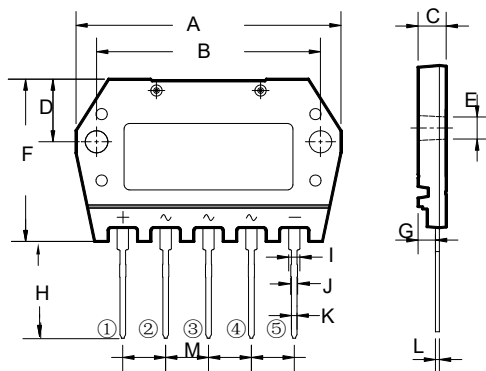

DIM	INCHES		MM		NOTE
	MIN	MAX	MIN	MAX	
A	1.834	1.874	46.60	47.60	
B	1.555	1.579	39.50	40.10	
C	0.185	0.209	4.70	5.30	
D	0.433	0.457	11.00	11.60	
E	0.157	0.177	4.00	4.50	
F	1.134	1.173	28.80	29.80	
G	0.118	0.126	3.00	3.20	
H	0.677	0.701	17.20	17.80	
I	0.075	0.083	1.90	2.10	
J	0.039	0.047	1.00	1.20	
K	0.035	0.043	0.90	1.10	
L	0.024	0.031	0.60	0.80	
M	0.296	0.304	7.52	7.72	

Curve Characteristics

Fig. 1 - Forward Current Derating Curve

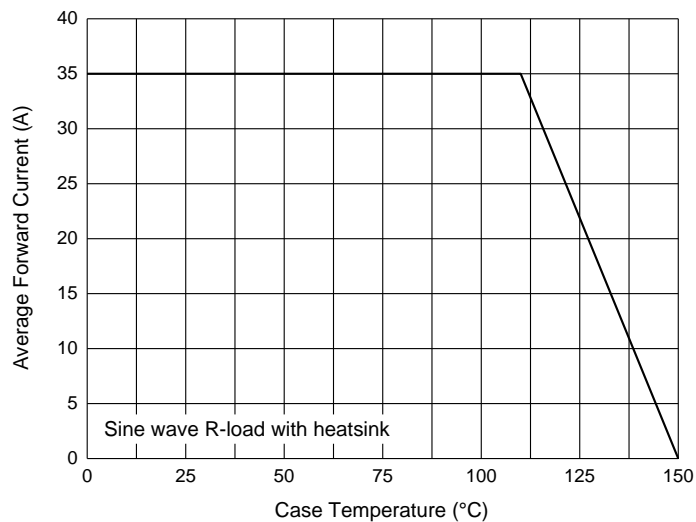

Fig. 2 - Maximum Non-Repetitive Peak Forward Surge Current

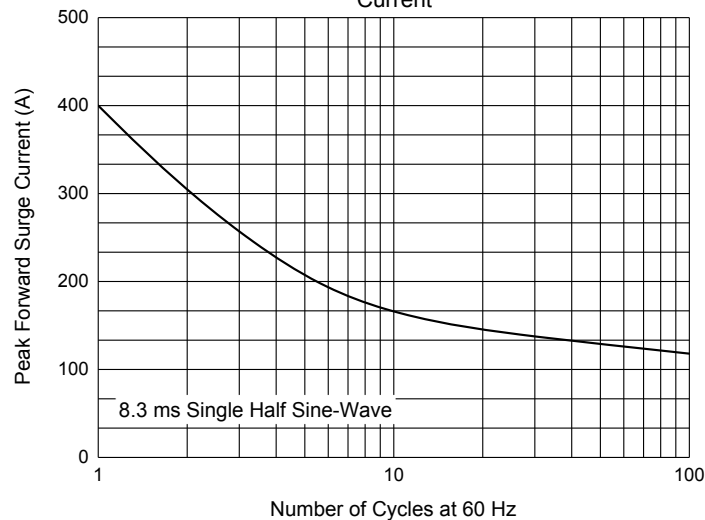

Fig. 3 - Typical Instantaneous Forward Characteristics

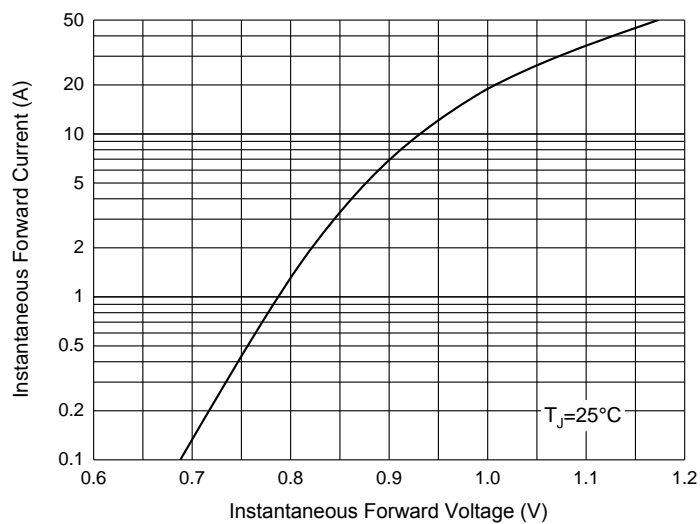
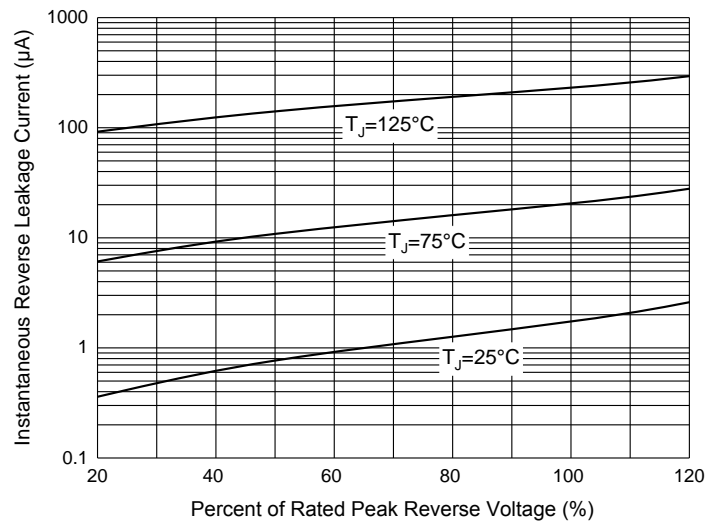

Fig. 4 - Typical Reverse Leakage Characteristics



Ordering Information

Device	Packing
Part Number-BP	Bulk: 96pcs/Box;960pcs/Ctn

IMPORTANT NOTICE

Micro Commercial Components Corp. reserves the right to make changes without further notice to any product herein to make corrections, modifications , enhancements , improvements , or other changes . **Micro Commercial Components Corp** . does not assume any liability arising out of the application or use of any product described herein; neither does it convey any license under its patent rights ,nor the rights of others . The user of products in such applications shall assume all risks of such use and will agree to hold **Micro Commercial Components Corp** . and all the companies whose products are represented on our website, harmless against all damages.

LIFE SUPPORT

MCC's products are not authorized for use as critical components in life support devices or systems without the express written approval of Micro Commercial Components Corporation.

CUSTOMER AWARENESS

Counterfeiting of semiconductor parts is a growing problem in the industry. Micro Commercial Components (MCC) is taking strong measures to protect ourselves and our customers from the proliferation of counterfeit parts. MCC strongly encourages customers to purchase MCC parts either directly from MCC or from Authorized MCC Distributors who are listed by country on our web page cited below. Products customers buy either from MCC directly or from Authorized MCC Distributors are genuine parts, have full traceability, meet MCC's quality standards for handling and storage. **MCC will not provide any warranty coverage or other assistance for parts bought from Unauthorized Sources.** MCC is committed to combat this global problem and encourage our customers to do their part in stopping this practice by buying direct or from authorized distributors.