

# HSF

Recommended P.C.B Layout(Top Side)  
(PCB BOARD TOLERANCE±0.05)

### NOTES:

Rated Current:5.0A  
Contact Resistance:10mΩ max  
Withstand Voltage:1500V AC/Minute  
Insulation Resistance:1000MΩ min  
Operation Temperature:-25℃ to+85℃

Contact Material:Brass  
Contact plating:Sn over Ni  
Insulator Material:PA66

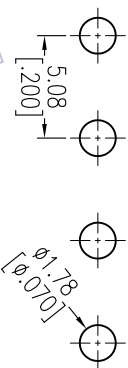
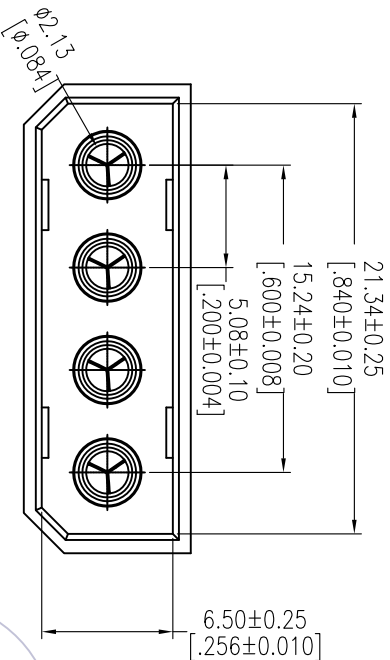

## Ordering Information

WF5084 -WS 04 W 0 2

No.of pins  
Color  
W=White  
0=PE Bag  
Packing

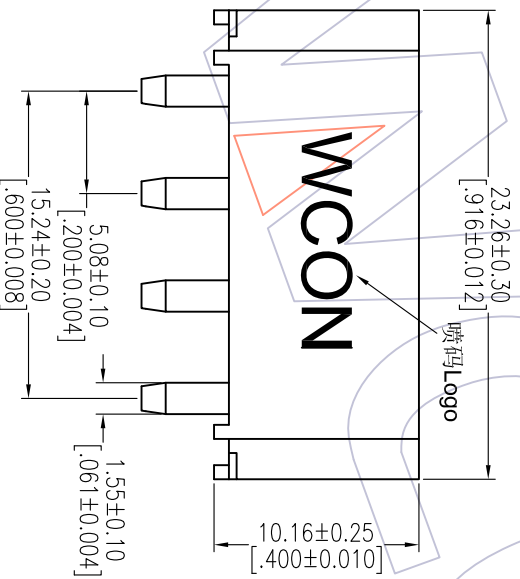

Logo 参考尺寸:

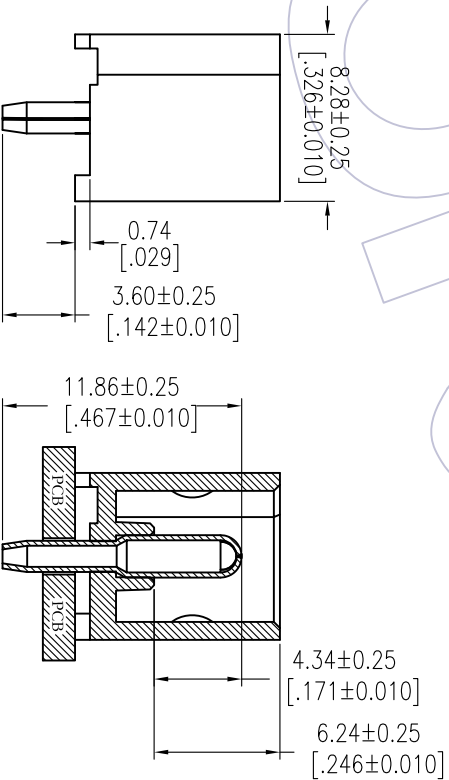

REV	DATE	MODIFICATION DESCRIPTION	CHANGE	OPERATION	DRAW	DATE	SCALE	FIT	PART NO.	TITLE:	Customer NO.	WCON-Dongguan	WCON-Kunshan
AO	2016/06/23	NEW		XXX ±0.25	Lizufeng	2016/06/23	mm A4	1/1	WF5084-WS04W02	5.08 WAFER 1*4P 180° DIP	K4101A	Http: www.wcon.com	Http: www.wcon.com
				XXX ±0.15	CHECK	DATE	SHEET					Tel: +86 769 85358920	Tel: +86 512 57468408
				Angle ± 3°	APPROVE	DATE	PROJ.					Fax: +86 769 85358915	Fax: +86 512 57468468
				DIM TOL								E-mail: sales@wcon.com	E-mail: sales@wcon.com

# WCON

Http: www.wcon.com

WCON-Dongguan  
Tel: +86 769 85358920  
Fax: +86 769 85358915  
E-mail: sales@wcon.com

WCON-Kunshan  
Tel: +86 512 57468408  
Fax: +86 512 57468468  
E-mail: sales@wcon.com