

REV	LOCATIONS	DESCRIPTION	DATE	REVISER	APPD

**SPECIFICATIONS**

**Electrical**  
 Current Rating: 1A AC(rms)/DC  
 Voltage Rating: 250V AC(rms)/DC  
 Contact Resistance: 30 mΩ Max  
 Insulation Resistance: 500 MΩ Min  
 Withstanding Voltage: 500V AC r.m.s  
 Temperature Range—Operating: -55°C~+105°C

**Material and Plating**  
 Housing: PBT (UL 94V-0)  
 Contact: Phosphor Bronze Gold  
 Contact plating: Selective gold in contact area, tin on tail  
 Shell: Zinc Alloy

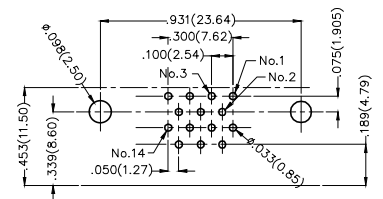
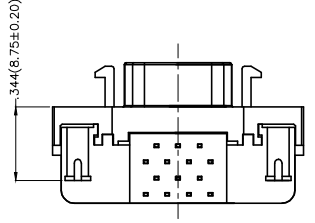
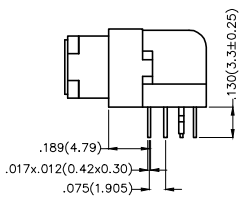
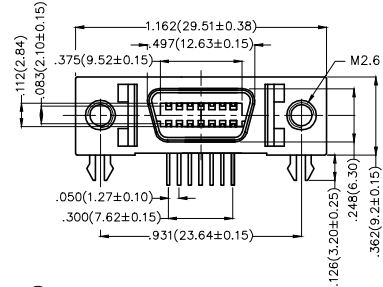
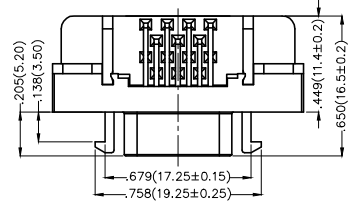

**Recommended P.C.Board Layout**  
 General Tolerances: ±0.05mm

**Ordering Information**

FCS 14 01 — FO D B 3 XX K6 K A  
 1 2 3 4 5 6 7 8 9 10 11

1 <u>Category</u> FCS-SCSI	2 <u>Circuits</u> 14	3 <u>Distinction No.</u> 01	4 <u>Type</u> FO-Female	5 <u>Assembly Layout</u> D-DIP	6 <u>Entry Angle</u> B-90° Angle
7 <u>Plating</u> 3-Selective gold in contact area, tin on tail	8 <u>Thickness of Plating</u> 00-Gold flash 03-3μ" Custom plate available	9 <u>Color-Resin</u> K6-Black	10 <u>Packaging</u> K-Tray	11 <u>Distinction Type</u> A-Type A	

<p>THIRD ANGLE PROJECTION</p>	GENERAL TOLERANCES (UNLESS SPECIFIED)		APPROVE BY FRANK	DATE 19/JUL/13	PART NO. FCS1401-F0DB3XXK6KA	ITEM NO. FCS1401	<p>Leader Of Industry</p>	
	DESIGN UNITS Inch (metric)	X.±.012(0.30) X.X±.008(0.20) X.XX±.006(0.15) X.XXX±.004(0.10)	X.'±5' X.'±2' X.X'±1' X.XXX'±0.5'	CHECKED BY CHERRY	DATE 19/JUL/13	TITLE SCSI Connector Pitch 1.27mm 90° Angle Female		REV 0
SCALE 5:1	SIZE A4	DRAWN BY KEVIN	DATE 19/JUL/13	THIS DRAWING CONTAINS INFORMATION THAT IS PROPRIETARY TO TXGA INDUSTRIAL ELECTRONICS(S.Z)CO.,LTD AND SHOULD NOT BE USED WITHOUT WRITTEN PERMISSION				

REV	LOCATIONS	DESCRIPTION	DATE	REVISER	APPD

**SPECIFICATIONS**

**Electrical**

Current Rating: 1A AC(rms)/DC  
 Voltage Rating: 250V AC(rms)/DC  
 Contact Resistance: 30 mΩ Max  
 Insulation Resistance: 500 MΩ Min  
 Withstanding Voltage: 500V AC r.m.s  
 Temperature Range—Operating: -55°C~+105°C

**Material and Plating**

Housing: PBT (UL 94V-0)  
 Contact: Phosphor Bronze Gold  
 Contact plating: Selective gold in contact area, tin on tail  
 Shell: Zinc Alloy

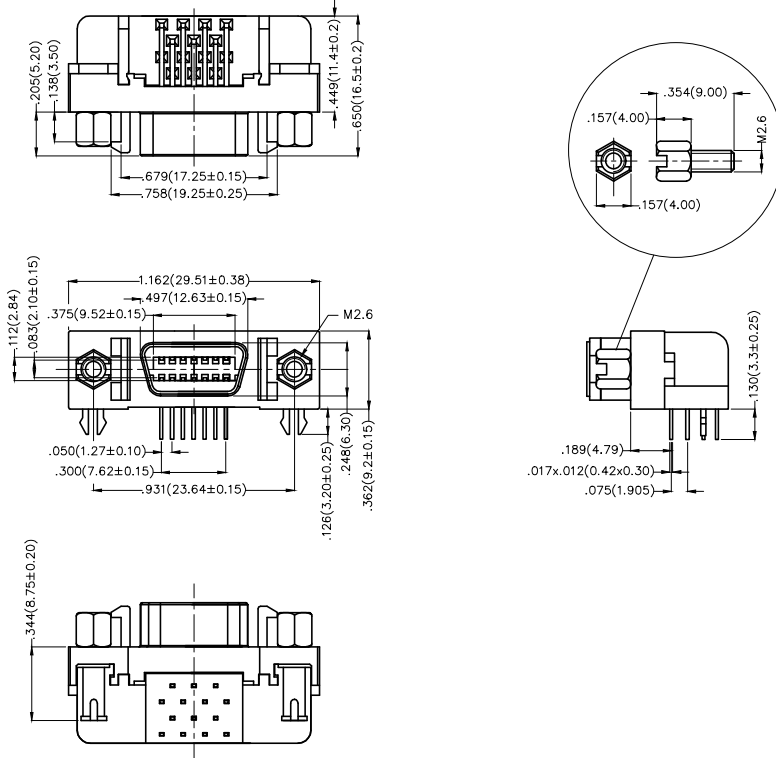

**Ordering Information**

FCS 14 01 — FO D B 3 XX K6 K B  
 1 2 3 4 5 6 7 8 9 10 11

1	Category FCS-SCSI	2	Circuits 14	3	Distinction No. 01	4	Type FO-Female	5	Assembly Layout D-DIP	6	Entry Angle B-90° Angle
7	Plating 3-Selective gold in contact area, tin on tail	8	Thickness of Plating 00-Gold flash 03-3μ" Custom plate available	9	Color-Resin K6-Black	10	Packaging K-Tray	11	Distinction Type B-Type B		

**Recommended P.C.Board Layout**  
 General Tolerances: ±0.05mm

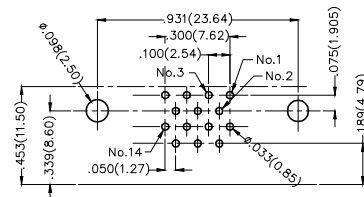

<p>THIRD ANGLE PROJECTION</p>	GENERAL TOLERANCES (UNLESS SPECIFIED)		APPROVE BY FRANK	DATE 19/JUL/13	PART NO. FCS1401-F0DB3XXK6KB	ITEM NO. FCS1401	<p>Leader Of Industry</p>	
	X.±.012(0.30)	X.±5'	CHECKED BY CHERRY	DATE 19/JUL/13	TITLE SCSI Connector Pitch 1.27mm 90° Angle Female			REV 0
	DESIGN UNITS Inch (metric)	X.XX±.008(0.20)	.X'±2'	DRAWN BY KEVIN	DATE 19/JUL/13	THIS DRAWING CONTAINS INFORMATION THAT IS PROPRIETARY TO TXGA INDUSTRIAL ELECTRONICS(S.Z)CO.,LTD AND SHOULD NOT BE USED WITHOUT WRITTEN PERMISSION		
	SCALE 5:1	SIZE A4	X.XX±.006(0.15)	.XX±1'				

REV	LOCATIONS	DESCRIPTION	DATE	REVISER	APPD

**SPECIFICATIONS**

**Electrical**

Current Rating: 1A AC(rms)/DC  
Voltage Rating: 250V AC(rms)/DC  
Contact Resistance: 30 mΩ Max  
Insulation Resistance: 500 MΩ Min  
Withstanding Voltage: 500V AC r.m.s  
Temperature Range—Operating: -55°C~+105°C

**Material and Plating**

Housing: PBT (UL 94V-0)  
Contact: Phosphor Bronze Gold  
Contact plating: Selective gold in contact area, tin on tail  
Shell: Zinc Alloy

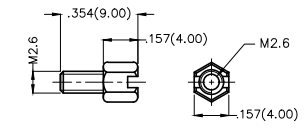
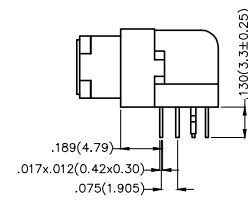
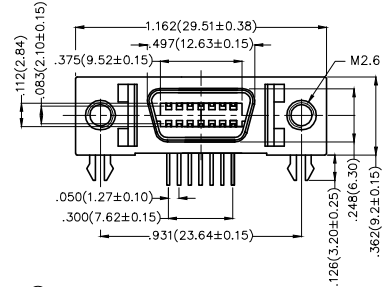
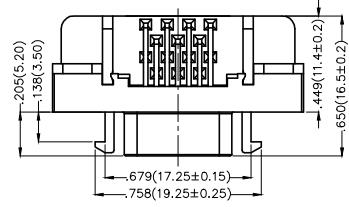

Screw (2pcs)

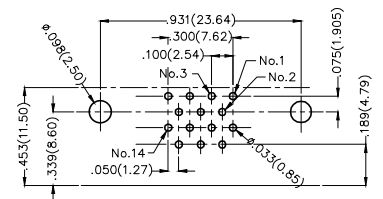
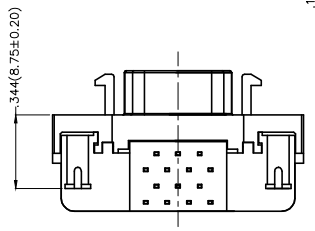

Recommended P.C.Board Layout  
General Tolerances: ±0.05mm

**Ordering Information**

FCS 14 01 — F0 D B 3 XX K6 K C  
1 2 3 4 5 6 7 8 9 10 11

1	Category FCS-SCSI	2	Circuits 14	3	Distinction No. 01	4	Type F0-Female	5	Assembly Layout D-DIP	6	Entry Angle B-90° Angle
7	Plating 3-Selective gold in contact area, tin on tail	8	Thickness of Plating 00-Gold flash 03-3μ" Custom plate available	9	Color-Resin K6-Black	10	Packaging K-Tray	11	Distinction Type C-Type C		

 THIRD ANGLE PROJECTION	GENERAL TOLERANCES (UNLESS SPECIFIED)		APPROVE BY FRANK	DATE 19/JUL/13	PART NO. FCS1401-F0DB3XXK6KC	ITEM NO. FCS1401	 Leader Of Industry	
	X.±.012(0.30)	X.±5'	CHECKED BY CHERRY	DATE 19/JUL/13	TITLE SCSI Connector Pitch 1.27mm 90° Angle Female			REV 0
DESIGN UNITS Inch (metric)	X.X±.008(0.20)	.X'±2'	DRAWN BY KEVIN	DATE 19/JUL/13	THIS DRAWING CONTAINS INFORMATION THAT IS PROPRIETARY TO TXGA INDUSTRIAL ELECTRONICS(S.Z)CO.,LTD AND SHOULD NOT BE USED WITHOUT WRITTEN PERMISSION			
SCALE 5:1	SIZE A4	X.XX±.006(0.15)	.XX'±1'					
		X.XXX±.004(0.10)	.XXX'±0.5'					