



SMC/DO-214AB

Features

- ✧ FOR SURFACE MOUNTED APPLICATIONS
- ✧ LOW PROFILE PACKAGE
- ✧ BUILT-IN STRAIN RELIEF
- ✧ EASY PICK AND PLACE
- ✧ PLASTIC MATERIAL USED CARRIES UNDERWRITERS
- ✧ LABORATORY CLASSIFICATION 94 V-0
- ✧ EXTREMELY LOW VF
- ✧ MAJORITY CARRIER CONDUCTION
- ✧ HIGH TEMPERATURE SOLDERING : 260°C//10 SECONDS AT TERMINALS

Mechanical Data

- ✧ CASE : DO-214AB(SMC)
- ✧ TERMINALS : SOLDER PLATED
- ✧ POLARITY : INDICATED BY CATHODE BAND
- ✧ WEIGHT : 0.22GRAMS

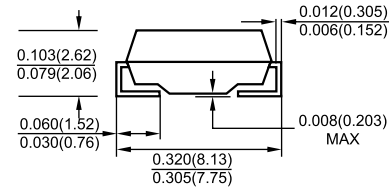
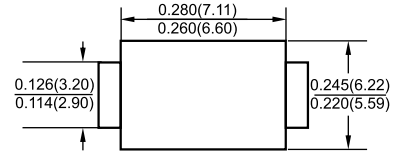

Dimensions in inches and (millimeters)

MAXIMUM RATINGS AND ELECTRICAL CHARACTERISTICS

Ratings at 25 C ambient temperature unless otherwise specified

Resistive or inductive load

	SYMBOL	SS1020	SS1030	SS1040	SS1045	SS1050	SS1060	SS1080	SS10A0	UNITS
Maximum Repetitive Peak Reverse Voltage	V_{RRM}	20	30	40	45	50	60	80	100	Volts
Maximum RMS Voltage	V_{RMS}	14	21	28	32	35	42	56	70	Volts
Maximum DC Blocking Voltage	V_{DC}	20	30	40	45	50	60	80	100	Volts
Maximum Average Forward Current .375" (9.5mm) lead length at $T_L = 75^\circ C$	I_{AV}	10.0								Amps
Peak Forward Surge Current 8.3ms Single Half Sine-Wave Superimposed on Rated Load (JEDEC Method)	I_{FSM}	250								Amps
Maximum Instantaneous Forward Voltage at 8.0A	V_F	0.55			0.70		0.85			Volts
Maximum DC Reverse Current $T_A = 25^\circ C$ at Rated DC Blocking Voltage $T_A = 100^\circ C$	I_R	1.0 20								mA
Maximum Thermal Resistance (NOTE 2)	$R_{\theta JL}$	20								$^\circ C / W$
Operating Junction Temperature Range	T_J	-50 to +150								$^\circ C$
Storage and Operating Temperature Range	T_{STG}	-55 to +150								$^\circ C$

NOTES :

1. Pulse test with $PW = 300 \mu sec$, 1% duty cycle
2. Mounted on P.C.Board with $8mm^2$ (0.13mm thick) copper pad areas

RATINGS AND CHARACTERISTIC CURVES

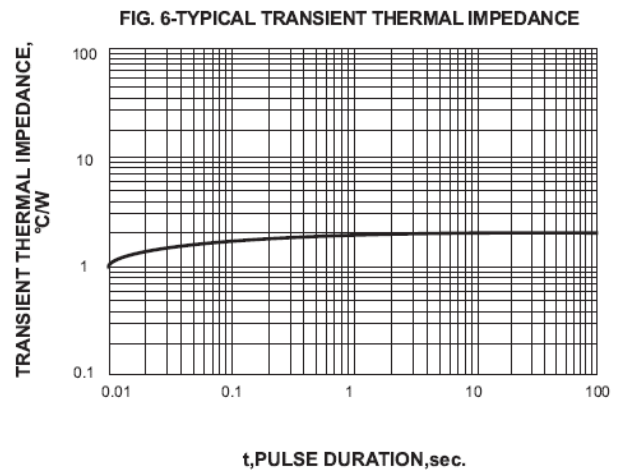
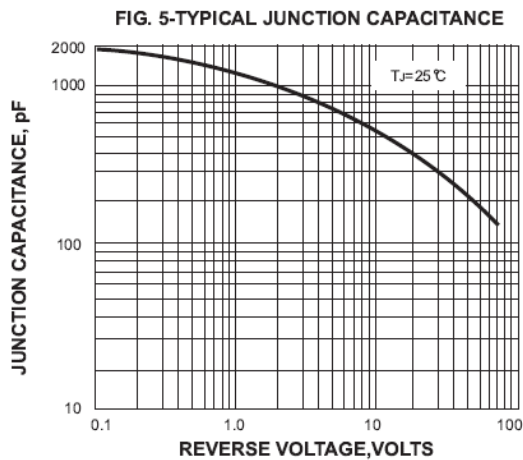
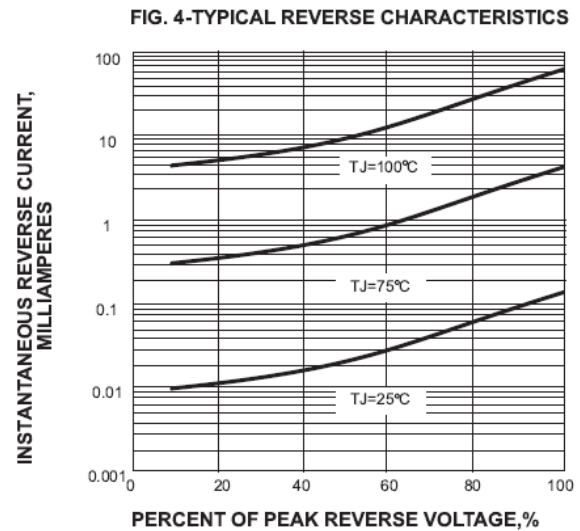
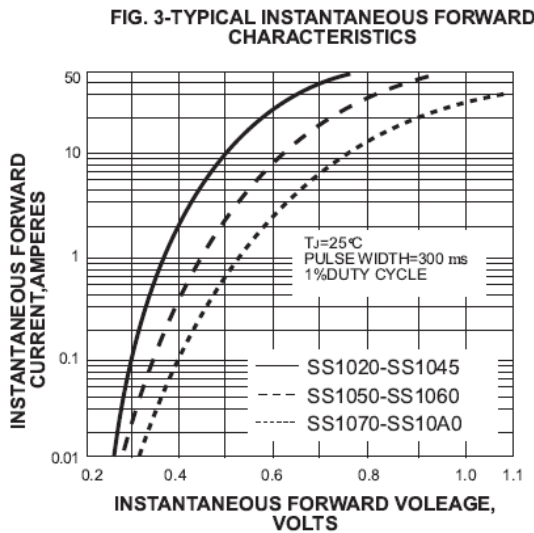
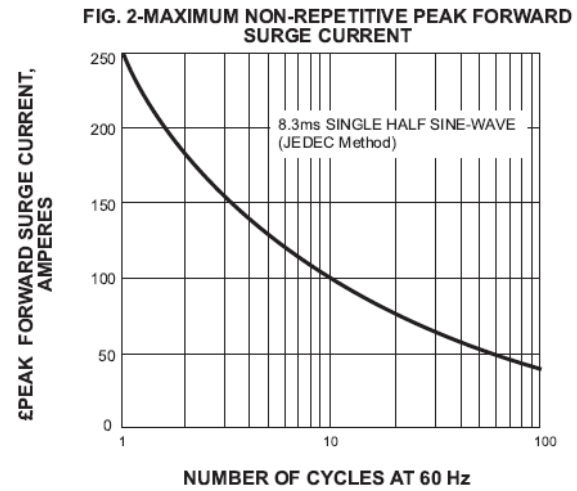
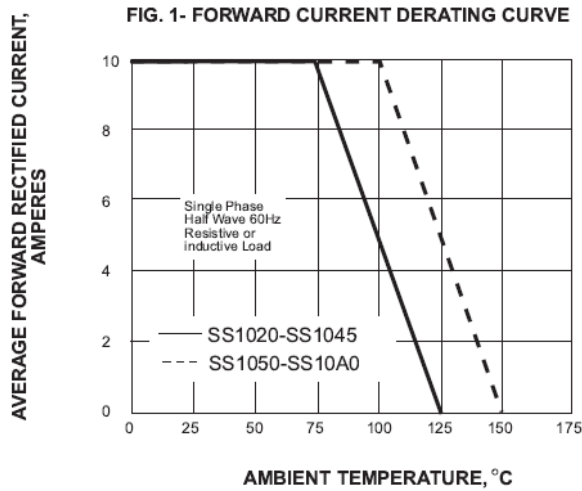

PACKAGE	SPQ/PCS	CARTON SPQ/PCS	CARTON SIZE/CM	CARTON GW/KG	CARTON NW/KG
SMC	3000/REEL	42000	36X36X36.5	18.50	15.50