

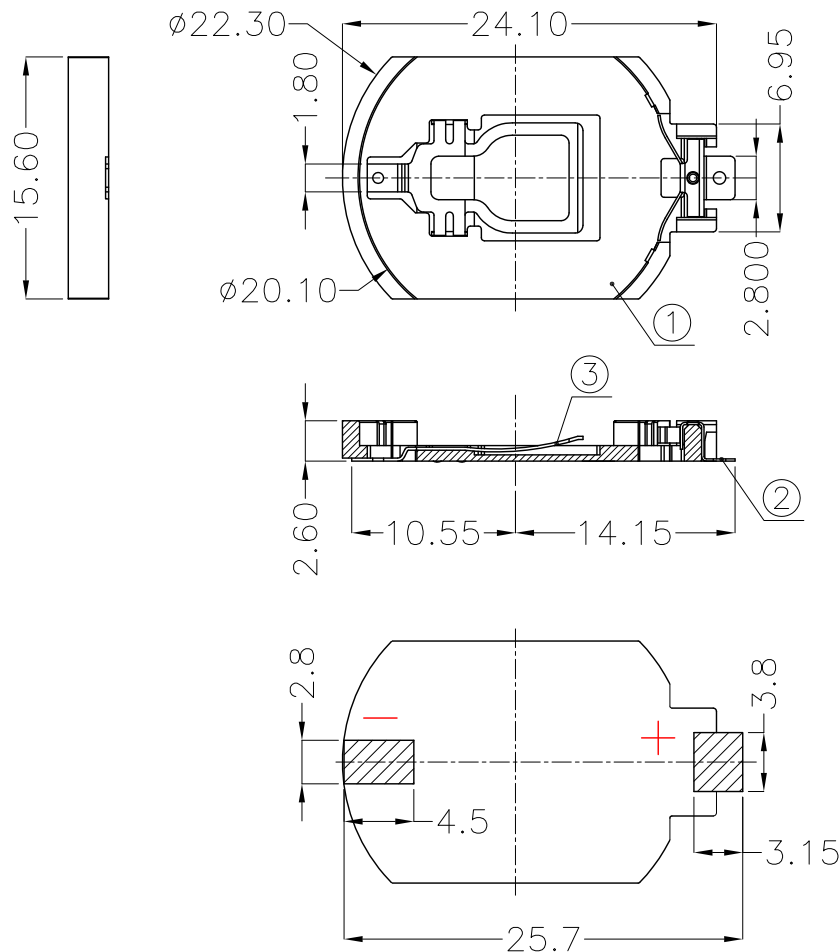

REV.	ECN NO.	REVISED	DATE



NOTE:

1.MATERIAL:

a.HOUSING:PPA  
b.CONTACT:PHOSPHOR BRONZE  
(SURFACE PLATING: Au1u")  
SEE ORDERING INFORMATION

2.ELECTRIC:

a.CONTACT RESISTANCE: 30 MILLIOHMS MAX  
b.INSULATION RESISTANCE: 1000 MEGA OHMS MIN  
c.DIELECTNIC VOLTAGE: 500V AC ONE SEC LEVEL  
d.OPERATING TEMPERATURE: -25°C~ +85°C

ORDERING INFORMATION  
**BS-2016-B\*\*\*001**

电池座系列  
BS-2016系列  
SMT 180° TYPE

PLATING:  
A-Au1U"  
J-Ni100U"~120U"  
K-Sn100U"~120U"

MATERIAL:  
1A-PBT BLACK  
1B-PA66 BLACK  
2A-PPA BROWN  
2B-PPA BLACK  
3A-PPS BROWN  
3B-PPS BLACK  
4A-LCP WHITE  
4B-LCP BLACK

工程部  
2017-07-15  
ZW DANG

PCB Layout Diagram  
Top View

UNLESS OTHERWISE SPECIFIED TOLERANCES		<b>MYOUNG 美阳</b> <a href="http://www.meiyangdz.com">www.meiyangdz.com</a>					
DECIMALS: X :±0.30 X.X :±0.25 X.XX :±0.20 X.XXX :±0.10	ANGLES: X :±1° X.X :±0.5°	DSND	YangFeng	DATE	2017-07-15	TITLE:	BS-2016-8-1 PPA SMT
WEIGHT: 0.66g		CHKD	ZhouRuicai	DATE	2017-07-15	PART NO.:	BS-2016-B2AA001
SHEET 1 OF 1		APVD	XueShunyong	DATE	2017-07-15	VIEW:	
		SCALE:	2:1	SIZE:	A4	UNIT:	mm
		REV.:	A/0	OBJECT:	MY	DRAW NO.:	MY-CP-0029

NO.	PART NAME	Q'TY	MATERIAL	PLATING & COLOR
3	TERMINAL(-)	1	PHOSPHOR BRONZE, T=0.20mm	Gold Plating and Ni Under-Plating
2	TERMINAL(+)	1	PHOSPHOR BRONZE, T=0.15mm	Gold Plating and Ni Under-Plating
1	HOUSING	1	PPA	BROWN

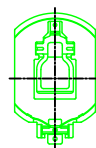

产品

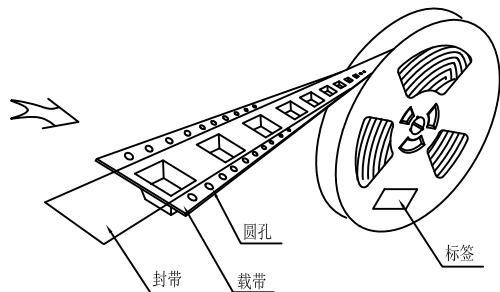

圆孔

封带

载带

标签

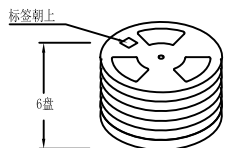

标签朝上

6盘

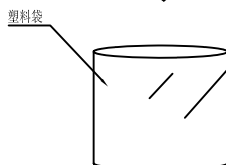

塑料袋

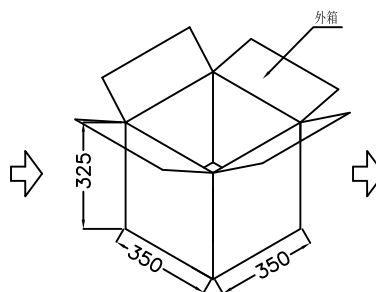

外箱

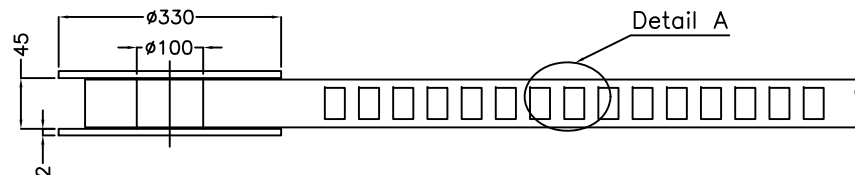
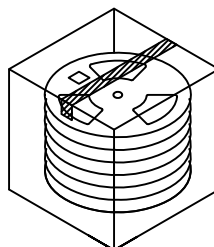

Detail A

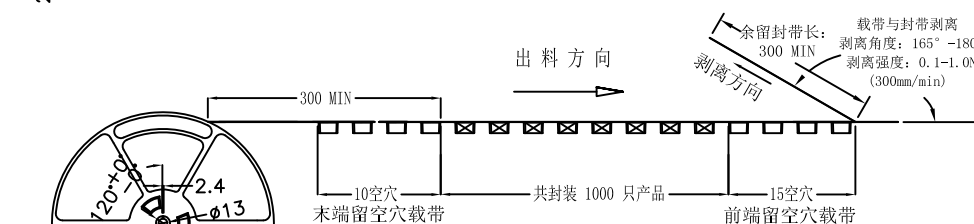

出料方向

剥离方向

余留封带长: 300 MIN  
载带与封带剥离  
剥离角度: 165°-180°  
剥离强度: 0.1-1.0N  
(300mm/min)

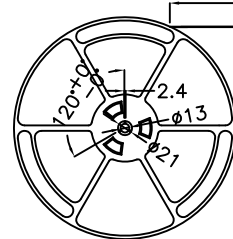

10空穴 末端留空穴载带  
共封装 1000 只产品  
15空穴 前端留空穴载带

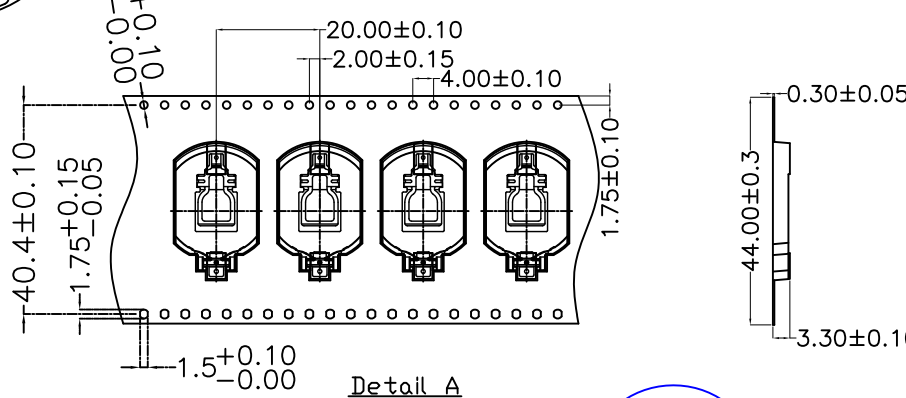

Detail A



工程部

2019-06-17

H. WANG

技术要求:

1. 圆孔十个孔距离累计允许公差为 $\pm 0.2\text{mm}$
2. 带长250mm内容许弯曲度1mm
3. 材料厚度以在载带边缘测量为准
4. 所有尺寸定义依循EIA-481-C系准则定义之
5. 材料: 黑色PS T=0.3mm
6. 所有卷轮为灰蓝挖空旋转塑胶卷轮
7. 整模成型长度: 20.5M,
8. 非指明公差范围为:  $\pm 0.1\text{mm}$ ; 超过250mm不计算累计误差
9. 型腔外形凡未标明处倒角R为0.2-0.3; 拔模斜度未标注的为 $3^\circ$  以下

包装信息:

- 1、每卷盘装产品 1000 只, 卷盘外侧贴相关标签;
- 2、每 6 卷盘放在一个塑料袋中;
- 3、每外箱装6盘, 产品总数: 6000 只;
- 4、外箱上下用胶纸封成“工”字;
- 5、净重: KG, 毛重: KG。

UNLESS OTHERWISE SPECIFIED TOLERANCES		<b>MYOUNG 美阳</b> www.meiyangdz.com			
DECIMALS: X : ±*** X.X : ±*** X.XX : ±*** X.XXX : ±***	ANGLES: X : ±*** X.X : ±***	DSND	YangFeng	DATE	2019-06-17
		CHKD	ZhouRuicai	DATE	2019-06-17
		APVD	XueShunyong	DATE	2019-06-17
WEIGHT:		SCALE:	3:1	SIZE:	A4
SHEET 1 OF 1		VIEW:	④	REV.:	A/0
		UNIT:	mm	OBJECT:	MY
		TITLE:		BS-2016-8-1 PPA 卷装	
		PART NO.:		BS-2016-B2AA001	
		DRAW NO.:		MY-BD-0030	