

PCB LAYOUT TOP VIEW
TOLERANCES ±0.05

NOTES:

注释:

- CONTACT CURRENT RATING:1A.
触点额定电流: 1A.
- CONTACT RESISTANCE:50MΩ MAX.;
接触电阻: 最大50MΩ.;
- INSULATION RESISTANCE: 100MΩ MIN,
绝缘电阻: 100MΩMIN.
- DIELECTRIC WITHSTANDING: 500V AC MIN.;
耐介质: 最小500V AC.;
- DURABILITY:5.000 CYCLES MIN.
耐久性: 每分钟5000次循环.
- CONNECTOR MATING FORCES: 29.4N (3.00Kgf) MAX.;
连接器配合力: 最大29.4N (3.00Kgf) .;
- CONNECTOR UNMATING FORCES: 4.94N (0.50Kgf)MIN.,
连接器脱离力: 最小4.94N (0.50Kgf) .;

	MATERIAL	PLATING
center pin	Brass	tin
terminal 1	Brass	tin
terminal 2	Phosphor Bronze	tin
terminal 3	Brass	tin
plastic	Pbt	

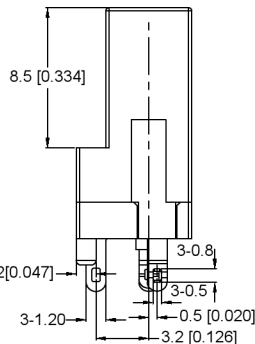
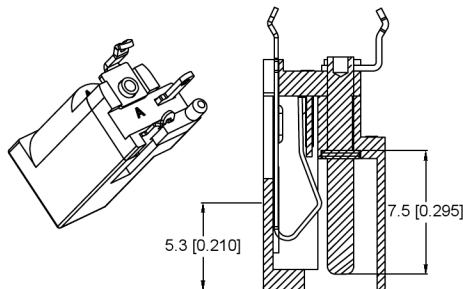

Ø3.5 [0.138]

Ø1.1 [0.043]

SCHEMATIC	
	±0.1
	±0.2
	±0.1
	±0.05mm
Center Pin	Ø1.0 mm
	Ø1.3 mm
	Ø1.65 mm

广东玺坤科技股份有限公司

生	日期
效	
Δ	
Δ	
MARK	DESCRIPTION
文件	工程章
REVISIONS	
DATE	REVISED
APPROVED	
UNSPECIFIED TOLERANCES	

DSND	DATE	SCALE: N/A	MODEL TYPE: DC POWER JACK
DWN	DATE	VIEW:	PART NO.:
CHKD	DATE	UNIT: mm/in	DWG NO.:
APPD	DATE	SIZE: A4	DC-002H-2.5A-1.0
XKB INDUSTRIAL PRECISION CO., LIMITED			WEIGHT 1.0g
			SHEET 1/1
			REVISION A0