

SPECIFICATIONS

Rated(额定参数): 300V,10A
 Dielectric strength(抗电强度): AC1250V/1 Minute
 Insulation Resistance(绝缘电阻):1000MΩ Min
 Contact Resistance(接触电阻):20mΩ Max
 Screw Torque(扭矩): 0.2Nm (1.77Lb.in)
 Wire Range(线径):26~16AWG
 Strip length(剥线长度):4~5mm
 Temp. range(操作温度): -40℃~+105℃
 MAX Soldering(瞬时温度):+250℃,5s

Housing Material(塑件): PA66 (UL94 V-0)
 Contact(端子): Brass, Tin plating(黄铜镀锡)
 Wire protector(弹片): Brass(黄铜), Ni plating(镍鍍)
 Screw (螺丝): M2.0, Steel, Zinc plating(钢,镀锌)

PITCH RANGE IN MM	NOMINAL DIMENSION RANGE IN MM				
	OVER TO	OVER TO	OVER TO	OVER TO	OVER TO
±0.10	6	10	30	60	100
±0.15	10	24	30	60	100
±0.25	±0.25	±0.30	±0.30	±0.50	±0.70
±1.00	±1.00	±1.00	±1.00	±1.00	±1.00

Ordering Information

JL 102 - 381 XX G 0 1

Pitch 381=3.81PH
 No.of pins 2P,3P,4P~18P
 Housing Color B=Black
 G=Green
 U=Blue
 R=Red
 W=White
 Y=Yellow
 O=Orange
 E=Grey
 Packing

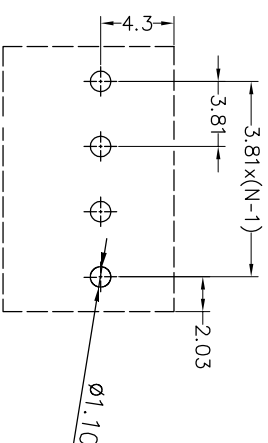
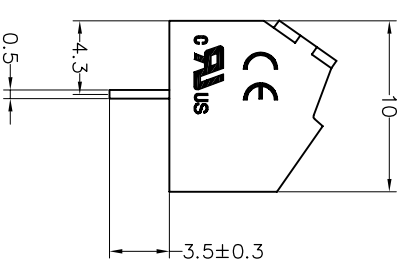
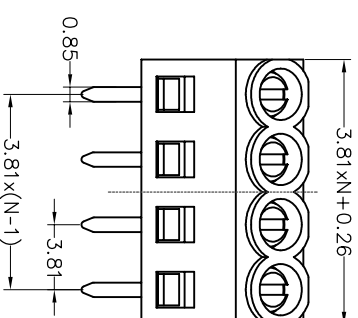
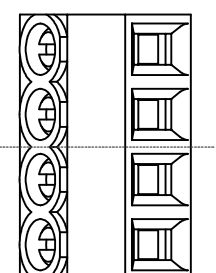

Recommended P.C.B. Layout(Top Side)

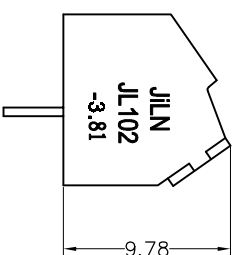

DRAW	SHUANGPING ZHENG		SCALE	FIT	PART NO.	JL102-381XXG01
	CHECK	LICHAO LIU	UNIT	mm		
APPROVE	YONGLIANG GAO		SIZE	A4	TITLE:	JL102-381-XXP螺钉式/PA66/绿色
			SHEET	1/1		
			PROJ.			

JILIN 东莞市锦凌电子有限公司
 DONGGUAN JILIN ELECTRONIC CO., LTD