

Specifications:  
 规格:  
 Current rating:5A AC/DC  
 额定电流: 5A AC/DC  
 Withstanding voltage:500 AC/minute  
 耐受电压: ≥ 500V AC/分钟  
 Temperature range:-25℃--+85℃  
 温度范围: -55℃--+85℃  
 Insulation resistance:1000MΩMIN  
 绝缘电阻: ≥1000MΩ  
 Contact resistance:30mΩMAN  
 接触电阻: ≤30mΩ  
 Material:  
 材料:  
 Contacts:Brass Gold Plated  
 接触: 黄铜镀金  
 Insulator:PBT+30%  
 绝缘体: PBT+30%  
 Shell (Fead) :Spcc  
 外壳: 铁

X04 XX W X X X X  
 ① ② ③ ④ ⑤ ⑥ ⑦

- ① Series NO.
- ② Row No.Pin No.XX-09;15;25;37
- ③ Welding Board Angle :W-male
- ④ T: Tradutional C: Car-pin
- ⑤ Planting Category: 1:1U 2:2U 3:3U 4:5U 5:15U 6:30U 7 : AuSn
- ⑥ B:BLACK W:White BL:Blue Y:Yellow G:Green R:Red
- ⑦ 1:TYPE-1; 2:TYPE-2; 3:TYPE-3; 4:TYPE-4; 5:TYPE-5; 6:TYPE-6

TYPE-2加前铆 (不通孔)

TYPE-3加后铆 (通孔)

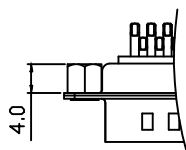
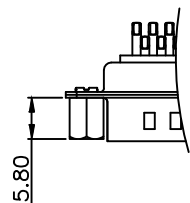

NO.POS	A	B	C	D	E
15PIN	16.92	24.99	30.80	19.00	2.29
26PIN	25.25	33.32	39.20	27.65	2.29
44PIN	38.96	47.04	53.10	41.20	2.29
62PIN	55.42	63.50	69.40	57.44	2.29

DSND		DATE		SCALE: N/A	MODEL TYPE:
DWN		DATE		VIEW:	PART NO.:
CHKD		DATE		UNIT: mm/in	DWG NO.:
APPD		DATE		SIZE: A4	X04XXWXXXX
				XKB INDUSTRIAL PRECISION CO.,LIMITED	WEIGHT
					1.0g
					SHEET
					1/1
					REVISION
					A0

MARK	DESCRIPTION	DATE	REVISED	APPROVED	units: mm	tolerance:
Δx					X.X	±0.2mm
Δx					X.XX	±0.1mm
Δx					X.XXX	±0.05mm
REVISIONS						UNSPECIFIED TOLERANCES
www.xk-dg.cn www.helloxkb.com www.helloxkb.cn						