

| | | |
|------|--------------|------|
| MAPX | MODIFICATION | DATE |
|------|--------------|------|

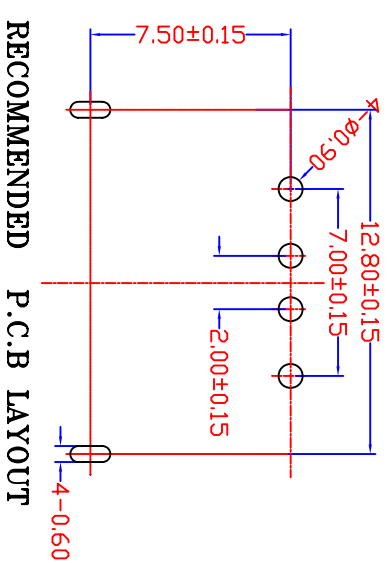
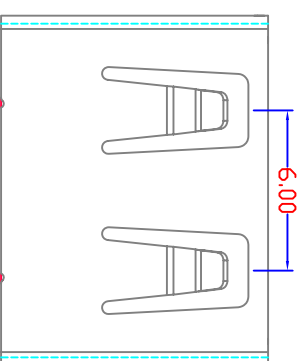
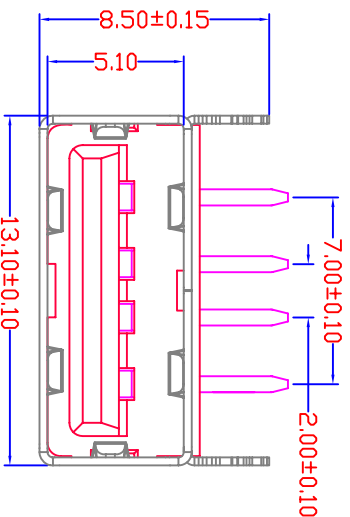
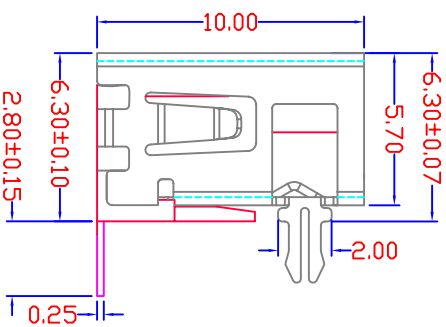
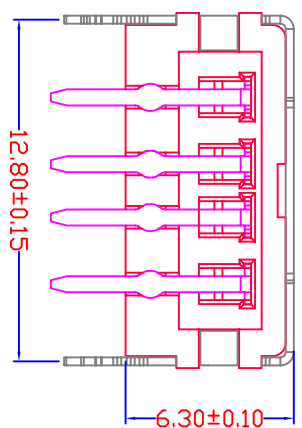

RECOMMENDED P.C.B LAYOUT

- Specification:**
- Electrical Characteristics:**
 Dielectric Withstanding Voltage: AC 500V/1MINUTE.
 Insulation Resistance: 1000 MΩ/Min.
 Contact Resistance: 30 mΩ/ Max.
 - Mechanical Characteristics:**
 INSERTION FORCE: 30N(3.06kgf) MAX
 EXTRACTION FORCE: 10~30N(1.02~3.06kgf)
 Durability: 1500cycles.EXTRACTION FORCE: 10~30N(1.02~3.06kgf)
 - Material:**
 Terminal: Phosphor Bronze, C5191/C2680R-EH T=0.25
 Plating: Gold 0.76 um Min plating over 1.27 um Min Nickel underplate, 2.54 um Min Sn selective plating on solder tail;
 Shell: Bronze, C2680R-H =0.30mm
 Plating: Nickel underplate 2.54 um Min;
 Housing: LCP Black
 - Environmental:**
 Operating Temperature: 0°C to +85°C.

产品图
PRODUCT CHART DWG

深圳市精拓金电子有限公司

| | | | | | | | |
|-------------------------------------|-------|-------------|-------|---------------|---------|------------------------|---------------------------|
| 公差一览表 TOLERANCE UNLESS OTHERWISE | | 单位 UNITS | MM | 制图 DRAWING | Z-Y-B | 制料号 PRODUCT PART NO | 908-161A1011D10111 |
| X | ±0.25 | X | ±5° | 审核 CHKD | | 产品名称 PRODUCT NO | LE10.0 新款脚无加.3特新白胶.3012无耳 |
| X | ±0.15 | X | ±2° | 核准 APPD | | 角法 VIEW | 版本 VER |
| XX | ±0.10 | XX | ±1° | 日期 DATE | 2015081 | AD | |
| XXX | ±0.05 | XXX | ±0.5° | | | | |

G F E D C B A 1 2 3 4 5 6 7 8 9 10