

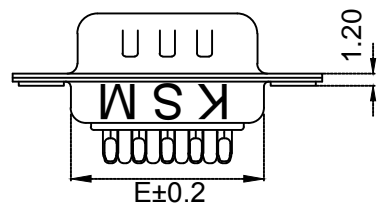

Material
 Insulator: Glass filled PBT, (UL 94V-0)
 Contact : Brass

Electrical Characteristics
 Current rating: 3AMP
 Dielectric Withstanding Voltage: AC 500V for 1 Minute.
 Insulator Resistance: 1000MΩ Min. AT DC 500V.
 Contact Resistance: 20mΩ Max.
 Operating Temperature: -45°C ~ +105°C

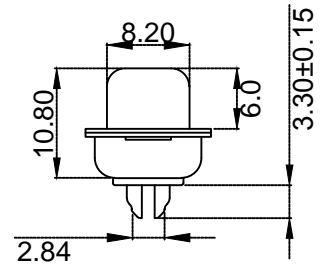
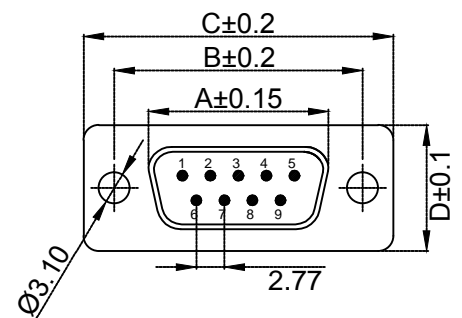

PIN	尺寸								D-SUB-*M		上海洲日电子有限公司 Shanghai Zhouri Electronics CO.,LTD			
	A±0.15	B±0.2	C±0.2	D±0.1	E±0.2						上海康司玛电子设备进出口有限公司 Shanghai KangSiMa Eletronic Equipment import and export Co.,LTD			
D-SUB-9M	17.90	25.00	30.80	12.50	19.20	X.	±0.3	±5°	20171018 A/0		TEL:86-21-34975176/51571121			
D-SUB-15M	26.50	33.30	39.20	12.50	27.80	X.X	±0.2	±3°	ZR20171018-DB-61		: 1 1			
D-SUB-25M	40.00	47.10	53.05	12.50	41.30	X.XX	±0.15		201171018		物料编号			
D-SUB-37M	56.50	63.50	69.44	12.50	57.50				201171018		: 1 1			
									201171018		: 1 1			

