

REV.	SPECIFICATION	ECN NO.	APPD.
R5		ECN210406	

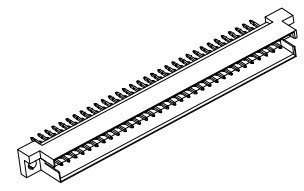
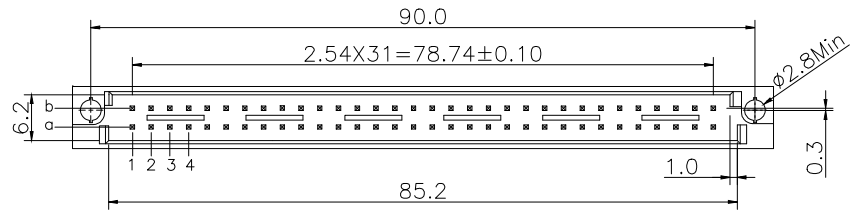

**Material and Plating:**

Housing: PBT, UL94V-0, Beige  
 Contacts: Brass  
 Gold Plated on Contact Area and 80u" Min Tin or Gold  
 Flash Plated on Solder Tail over 50u" Min Nickel.

**Electrical Characteristics:**

Current Rating: 2 AMP.  
 Dielectric Withstanding Voltage: AC 1000V For 1 minute.  
 Insulator Resistance: 1000MΩ min. at DC 500V.  
 Contact Resistance: 20mΩ max. at DC 100mA.  
 Operating Temperature: -55°C~+125°C.

**\*RoHS Compliant**

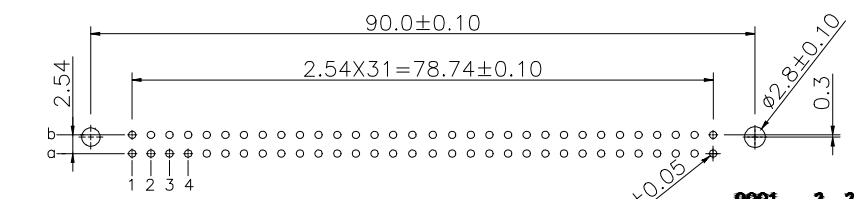
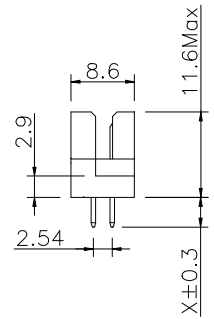
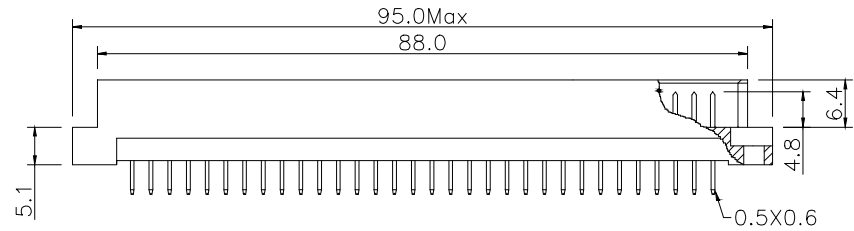

**P.C. Board Layout**  
 (Tolerance: ±0.05)

**9001- 3 3 xx x C xx A**

Series: 3: 2.54mm, 4: 5.08mm, 3: Male

Position: 1: Dip Length, 2: Dip Length, W1: Dip Length, W2: Dip Length

A: Tray Package  
 00: G/F, 10: 10u", 15: 15u", 30: 30u"

C: Dip Tin  
 Contact Gold, G: Gold Plated

Pitch	Position	Rows with Contacts	Contact Arrange	P/N	X length			
					1	2	W1	W2
2.54mm	64	a b		9001-3364xCxxA	4.0	2.5	13	17
	32	a -		9001-3332xCxxA				
5.08mm	32	a b		9001-4332xCxxA				
	16	a -		9001-4316xCxxA				

Tolerances	Dwg No.	9001D33001	
x = ±0.5	Projection		
.x = ±0.25	Unit	mm	Scale 1:1
.xx = ±0.15	Drawn By	ZY 04/14'21	

Title: 9001 Series  
 DIN41612 Q Type Male

<b>WingTAT</b> <sup>®</sup>			
深圳市格林柏电子技术开发有限公司			
P/N: 9001-3(4)3xxxCxxA			
SHEET	1/1	Ver.No.	R5