

REV.	SPECIFICATION	ECN NO.	APPD.
R6		ECN181118	

Material:

Housing: PBT, UL94V-0, Beige.

Contacts: Copper Alloy

Lock: Phosphor Bronze

Gold Plated on Contact Area and 80u" Min Tin or Gold Flash Plated on Solder tail over 50u" Min Nickel.

Electrical Characteristics:

Current Rating: 2 AMP.

Dielectric Withstanding Voltage: AC 1000V for 1minute.

Insulator Resistance: 10¹⁰MΩ min. at DC 500V.

Contact Resistance: 20mΩ max. at DC 100m A.

Operating Temperature: -55°C ~ +125°C .

* RoHS Compliant

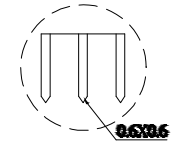
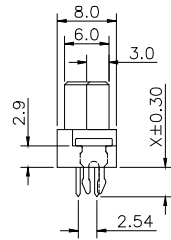
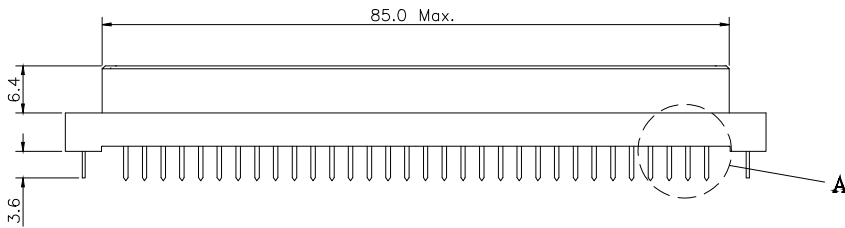
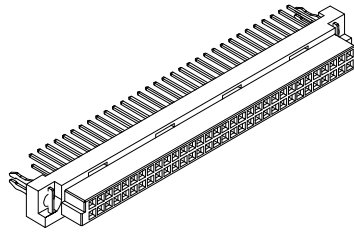
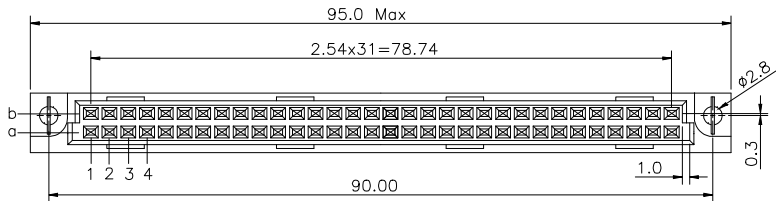

X length: 1/2
Detail-A
2:1

X length: W1/W2
Detail-A
2:1

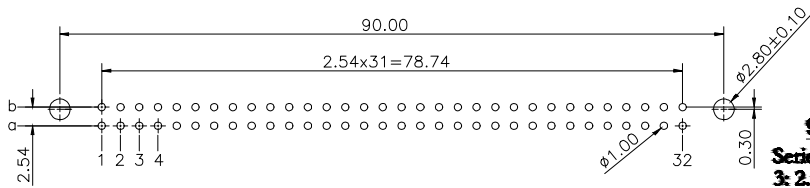

P.C. Board Layout:
(Tolerance: ±0.05)

9001- 3 2 xx 1 C xx L1 A
 Series: 3: 2.54mm
 Position: 2: Female
 1: Dip Length
 2: Dip Length
 W1: Dip Length
 W2: Dip Length
 C: Dip Tin Contact Gold
 G: Gold Plated
 L1: With Lock
 A: Tray Package
 Blank/W/O Lock
 00: G/F
 05: 05u"
 10: 10u"
 15: 15u"
 30: 30u"

Pitch	Position	Rows with Contacts	Contact Arrange	X length			
				1	2	W1	W2
2.54mm	64	a b		4.0	2.5	13	17
	32	a -		P/N			
				9001-3254xCxxxA			
				9001-3232xCxxxA			

Tolerances	Dwg No.	9001D32006		Title
x = ±0.5	Projection			9001 Series DIN41612 B Type Female
.x = ±0.25	Unit	mm	Scale	
.xx = ±0.15	Scale	1:1		
	Drawn By	WQ 11/11'19		

WINGTAT [®]			
深圳市格林柏电子技术有限公司			
P/N: 9001-32xxxCxxL1A			
SHEET	1/1	Ver. No.	R6