

SCHEMATIC (NON-SHORTING)

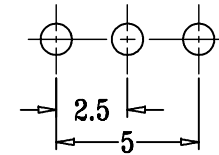
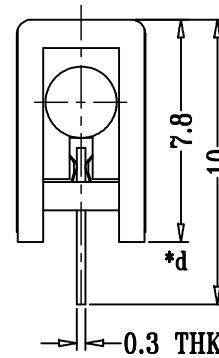
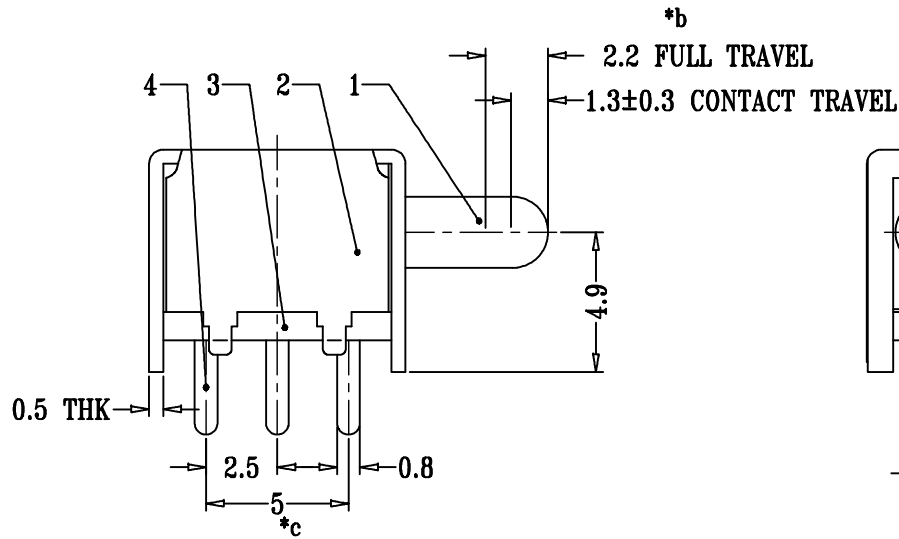

**P.C.B LAYOUT
BOTTOM VIEW**

H=XXmm

注：“*”表示关键尺寸(6个).

| NO. | PART NAME | MATERIAL | QTY | FINISHING | TOLERANCE UNLESS SPECIFIED | | NO | DATE | REVISIONS | | BY | APPD |
|-----|--------------|----------------|-----|-----------|-------------------------------|---------|---------------------|-----------|-----------|--|----|---------|
| 8 | | | | | UP TO 5mm: ±0.1 | ANGULAR | | | | | | |
| 7 | | | | | ABOVE 5mm: ±0.2 | ±1° | | | | | | |
| 6 | SPRING | STEEL WIRE | 1 | NATURAL | | | | | | | | |
| 5 | CONTACT CLIP | PBS STRIP | 1 | Ag PLATED | | | | | | | | |
| 4 | TERMINAL | BRASS STRIP | 3 | Ag PLATED | TITLE: PUSH SWITCH | | UNIT : MM | ROHS | DWN | | | |
| 3 | BASE | PHENOLIC RESIN | 1 | NATURAL | MODEL: PS12D33 | | SCALE: 1:1 | COMPLIANT | CHK'D | | | |
| 2 | FRAME | STEEL STRIP | 1 | Ni PLATED | 深圳市金航标电子有限公司 | | www.kinghelm.com.cn | | APPD | | | |
| 1 | KNOB | POM | 1 | BLACK | KH-PS12D33-G3 | | 0755-28190160 | | PRO.AGL: | | | REV :A0 |