

ROHS

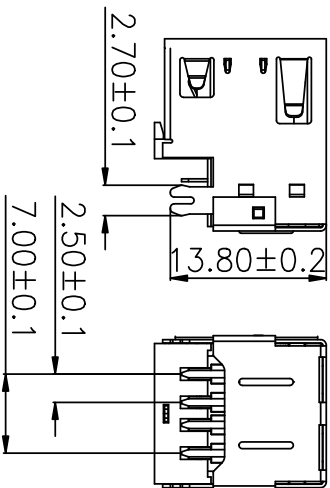
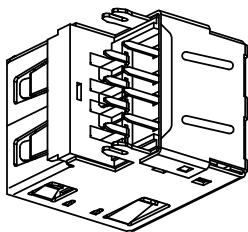
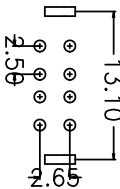
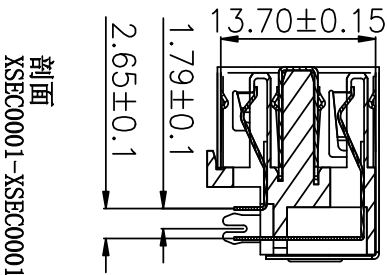
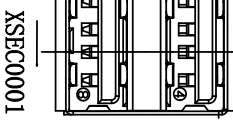
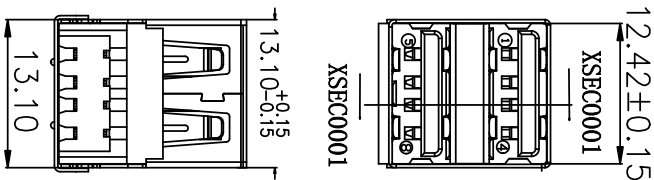
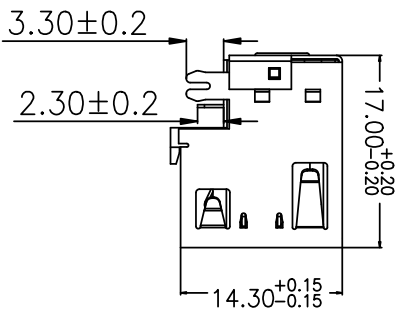
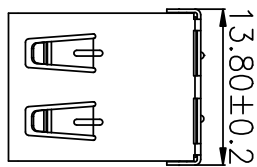

MAPX	MODIFICATION	DRW	DATE

电气特性:Electrical:

- 1. 额定电流: Current Rating
 - 1.5A/contact terminal
- 2. 额定电压: Voltage Rating
 - 30V DC
- 3. 接触阻抗: Contact Resistance
 - 30 milliohms MAX
- 4. 耐电压: Dielectric Withstanding Voltage:
 - 500 V AC AT Sea Level
- 5. 绝缘阻抗: Insulation Resistance:
 - 1000MΩCA ohms MIN

物理性能:Mechanical:

- 1. 插拔力: Connector Mate and Unmate Force
 - Mate force: 3.57kgf (MAX)
 - Unmate force: 0.7kgf (MIN)
 - 2. 端子保持力: Terminal Retention
 - 1.2kgf (MIN)
 - 3. 寿命: 1500次
 - 原材料: Matorial:
 - 1. 塑胶: Housing: PBT 白胶
 - 2. 端子: Contact: Copper Alloy C2680
 - 3. 外壳: Shell: SPCC
- 电镀: Finish:
- 1. 端子Contact: Au 0.7μ" Plated on contact area
 - 2. 端子: Nickel 50μ" Plated underplating over all.
 - 3. 外壳Shell: Nickel 50μ" Min plating over all.

PIN序号	信号名称
PIN1	VBUS
PIN2	D-
PIN3	D+
PIN4	GND
PIN5	VBUS
PIN6	D-
PIN7	D+
PIN8	GND

NO.	Part Name	MATERIAL	THICK	FINISH
5	SHELL-B	SPCC	T=0.30	NPLATED
4	SHELL-A	SPCC	T=0.30	NIN40/Min
3	TERMINAL-B	BRASS	T=0.25	Sn 60μ" Au 0.5μ"
2	TERMINAL-A	BRASS	T=0.25	Sn 60μ" Au 0.5μ"
1	HOUSING	PBT	✓	BLACK

产品图
PRODUCT CHART.DWG

公差一览表	公差	公差	公差	公差
TOLERANCE UNLESS OTHERWISE	±0.25	±0.15	±0.10	±0.05
角度	±5°	±2°	±1°	±0.5°

深圳市精拓金电子有限公司
Shenzhen Jing Tuo Jin Electronics Co., Ltd.

单位	MM
比例	1:1
日期	2020-06-22

制图: YANG
审核: 郭治富
核准: 黄国荣

制图料号: 907-421A101BP10201
产品名称: AF-290#17.0双层沉板鱼叉脚无边铁壳
白胶2#H/AC

版本: A0