

ROHS

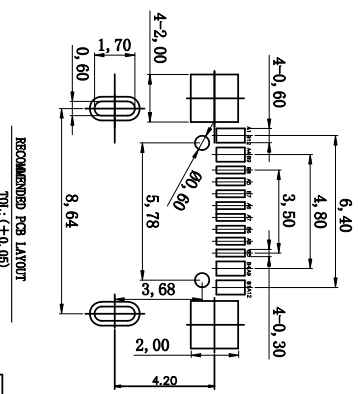
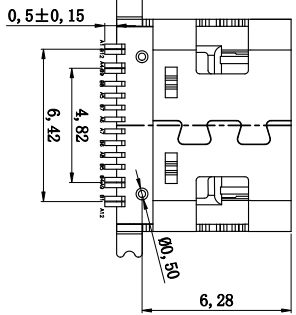
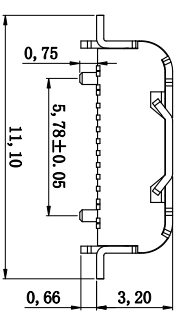
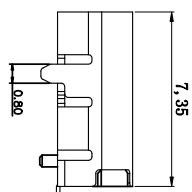
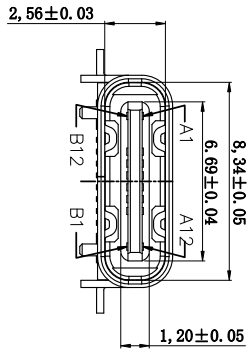
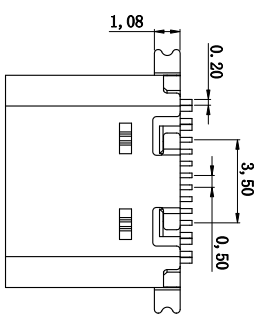

RECOMMENDED PCB LAYOUT  
TOL: (+0.05)

TABLE 1:

NO.	PART NAME	QTY	MATERIAL	DESCRIPTION	REMARK
④	Shell	1	SUS 304	NI PLATING:	T=0-30mm
③	MID PLATE	1	SUS 304		T=0-15mm
②	Terminal	16	C880	Au:1μt PLATING:	T=0-15mm
①	Housing	3	LDP 1301		

Signal Name	Signal Name
A1	GND
A2	SSTXp1
A3	SSTXn1
A4	VBUS
A5	CC1
A6	Dp1
A7	Dn1
A8	SBU1
A9	VBUS
A10	SSRXn2
A11	SSRXp2
A12	GND
B12	GND
B11	SSRXp1
B10	SSRXn1
B9	VBUS
B8	SBU2
B7	Dn2
B6	Dp2
B5	VBUS
B4	SSRXn2
B3	SSRXp2
B2	SSRXp1
B1	GND

- NOTES:
1. MATERIAL: SEE "TABLE 1";
  2. FINISH: SEE "TABLE 1";
  3. ELECTRICAL:
    - 3-1. CONTACT CURRENT RATING:
      - 3A (VBUS PIN 1.5A/PIN MAX),
      - 3A (GND PIN 1.25A/PIN MAX), 0.25A/PIN (OTHER PIN).
    - 3-2. INSULATION RESISTANCE:
      - 100 MEGOHMS MIN. AT 250VDC.
    - 3-3. DIELECTRIC WITHSTANDING VOLTAGE:
      - 100VAC MIN.
    - 3-4. LOW LEVEL CONTACT RESISTANCE:
      - INITIAL 40mΩ MAX.
      - AFTER 50mΩ MAX.
  4. MECHANICAL CHARACTERISTICS:
    - 4-1. MATING FORCE: 5\*20N;
    - 4-2. UNMATING FORCE: 6\*20N (INITIAL), 6\*20N (AFTER 10000 CYCLES);
    - 4-3. DURABILITY: 10,000 MATING CYCLES.
    - 4-4. OPERATING TEMPERATURE: -40° C TO +80° C

**产品图**  
公差一览表

TOLERANCE UNLESS OTHERWISE	±5.°	±2.°	±1.°	±0.5°
X.	±0.25	X.	±1.	±0.5°
X.	±0.20	X.	±1.	±0.5°
.XX	±0.15	.XX	±1.	±0.5°
.XXX	±0.10	.XXX	±1.	±0.5°

单位: MM  
比例: 1:1  
日期: 2020-05-22  
制图: 林属升  
审核: 郭治富  
核准: 黄国荣

制图料号: 918-418X2323S4020  
PRODUCT PART NO.  
产品名称: TP05-03 1.5A/1.5A L7.25mm 插板  
PRODUCT NO.: 零件清单请向市场部  
角法: NEW

深圳市精拓金电子有限公司  
Shenzhen Jing Tuo Jin Electronics Co., Ltd.

MAPX	MODIFICATION	DRW	DATE

