

1 ROHS

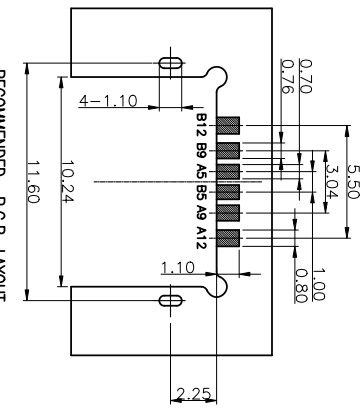
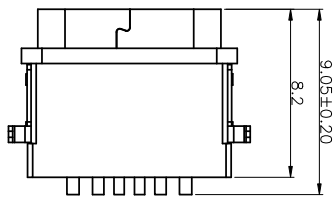
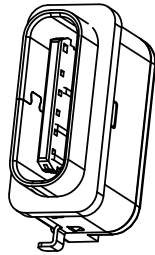

RECOMMENDED P.C.B. LAYOUT
TOLERANCE UNSPECIFIED ±0.05mm

NOTES:

SPECIFICATION:

1. CURRENT RATING: 3.0A MAX
2. VOLTAGE: 100 VAC
3. TEMPERATURE RANGE: -30 °C ~ 85 °C
4. CONTACT RESISTANCE: 40 MILLIONHM MAX
5. INSULATION RESISTANCE: 100 MEGOHMS MIN.
6. INSERTION FORCE : 5N~20N
7. UNMATING FORCE: 8N~20N
8. DURABILITY: 10,000 CYCLES
9. WATER PROOFNESS:THISPRODUCTIS BASED ON IPX7.

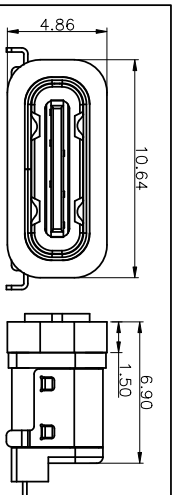
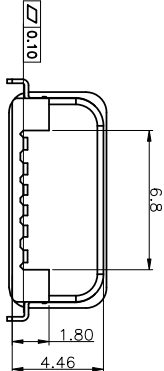
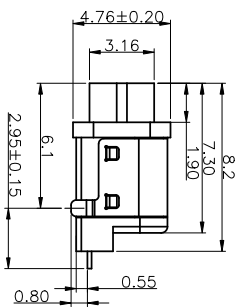
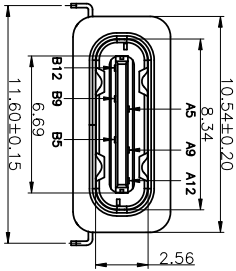

加防水圈示意图

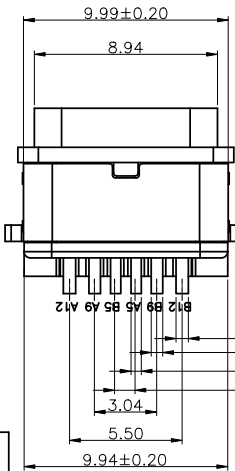

5	SHELL	STAINLESS STEEL	NI Plated	1PCS
4	SHIELDING PLATE	STAINLESS STEEL	NI Plated	1PCS
3	CONTACT	COPPER ALLOY	TIN/Au/NI Plated	1SET
2	SHELL HOUSING	HIGH TEMPERATURE PLASTIC	BLACK	1PCS
1	HOUSING	HIGH TEMPERATURE PLASTIC	BLACK	1PCS

备注:

NO.	料号	备注
1	AA0B010-077	不带硅胶
2	AA0B010-079	带硅胶

A5	CC1	B12	GND
A9	VBUS	B9	VBUS
A12	GND	B5	CC2
PIN	SIGNAL NAME	PIN	SIGNAL NAME

产品图

PRODUCT CHART DWG
深州市精拓金电子有限公司
Shenzhen Jing Tu Jin Electronics Co., Ltd.

公差一览表

TOLERANCE UNLESS OTHERWISE	公差
X.	±0.25
.X	±0.20
.XX	±0.15
.XXX	±0.10
.X.X	±1.5°
.X.X	±2.0°
.XX	±1.0°
.XXX	±0.5°

单位	MM	制图	林属升	制图料号	918-418K2023S40012
比例	1:1	审核	郭治富	产品名称	TYPE-C3.1防水母座双壳8.2两脚
日期	2016-09-09	日期	2016-09-09	插板0.8LCP黑胶单排SMT 6P2IN	
日期	2016-09-09	日期	2016-09-09	角法	
日期	2016-09-09	日期	2016-09-09	版本	A0