

目錄 MAPX	投交內容 MODIFICATION	日期 DATE
------------	----------------------	------------

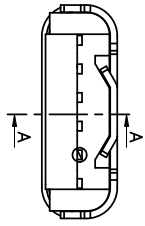
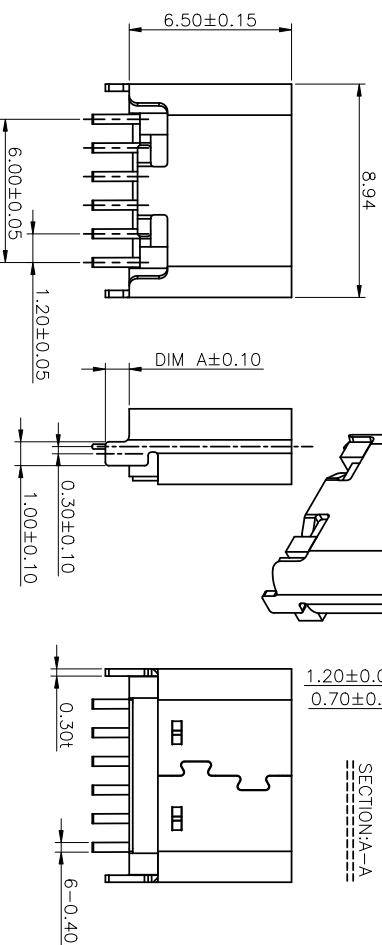
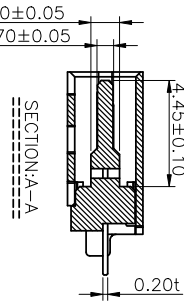
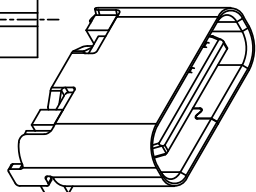
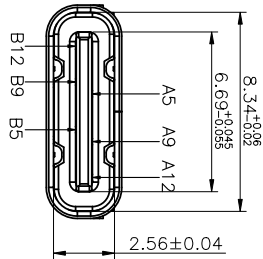
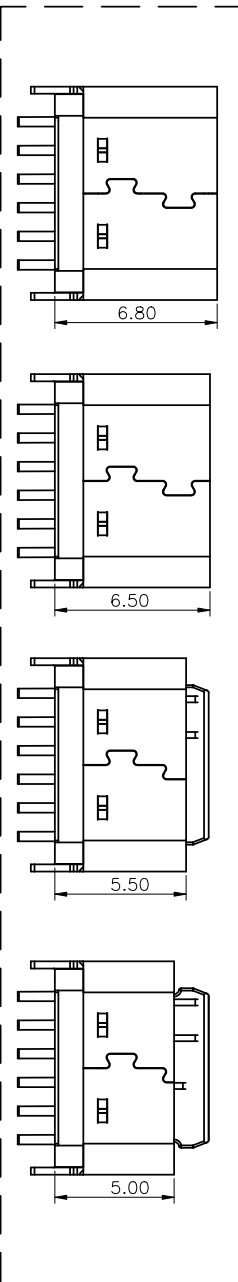

NOTE2:

DIM	ALUMI	BI	PART No.
1.50	6.80	T04-006RT138RT1R	
1.50	6.80	T04-006RT138RT1R	
1.00	6.50	T04-006RT138RT1R	
1.50	6.50	T04-006RT137RT1R	
1.00	5.50	T04-006RT138RT1R	
1.50	5.50	T04-006RT138RT1R	
1.00	5.00	T04-006RT140RT1R	
1.50	5.00	T04-006RT141RT1R	

- NOTE:
- MATERIAL SPECIFICATION:
 - HOUSING: HIGH TEMPERATURE RESISTANT PLASTIC UL94 V-0.
 - CONTACTS: COPPER ALLOY
 - MID PLATE: STAINLESS STEEL
 - FRONT SHELL: STAINLESS STEEL
 - PLATING SPECIFICATION:
 - CONTACTS:
 - 50μ" MIN. UNDER PLATED OVER ALL.
 - 50μ" MIN. UNDER PLATED OVER ALL.
 - PLATED ON THE FUNCTIONAL AREA OF CONTACT. (GOLD PLATING THICKNESS FOLLOW THE P/N)
 - PLATING SPECIFICATIONS OF THE SOLDER AREA FOLLOW THE P/N
 - FRONT SHELL:
 - 30μ" MIN. UNDER PLATED OVER ALL.
 - SHIELD PLATE/MID PLATE:
 - CLEAR ONLY
 - MECHANICAL PERFORMANCE:
 - INSERTION FORCE: 0.5~2.0kgf.
 - REMOVAL FORCE: 0.8kgf~2.0kgf.
 - DURABILITY: 2000 CYCLES.
 - ELECTRICAL PERFORMANCE:
 - CURRENT RATING: 5.0A
 - VOLTAGE RATING: 5.0V
 - LCOR:
 - VBUS & GND PINS AND OTHER PINS: 40mΩ /PIN MAX. SHIELD: 50mΩ /MAX. LCOR MAX. CHANGE OF ALL PINS: 10mΩ.
 - INSULATION RESISTANCE: 100MΩ MIN
 - DIELECTRIC WITHSTAND VOLTAGE, AC 100V FOR 1 MINUTE.
 - ENVIRONMENTAL PERFORMANCE:
 - OPERATING TEMPERATURE: -25° C~+85° C.
 - IR REFLOW:
 - THE PEAK TEMPERATURE ON THE BOARD SHALL BE MAINTAINED FOR 10 SECONDS AT 260° C.

深圳市精拓金电子有限公司

产品图

PRODUCT CHART DWG

公差一览表

TOLERANCE	UNLESS OTHERWISE
X	±0.25
.X	±0.20
.XX	±0.15
.XXX	±0.10

单位 UNITS	MM
比例 SCALE	1:1
日期 DATE	2015/10/20
制图 DRAWING	林属升
审核 CHKD	郭志富
核准 APPD	黄国荣
产品料号 Product Part No.	918-418K2028140001
产品名称 Product No.	TYPE-C3.1母座两脚立式插板6.5不锈钢
角法	LCF 黑胶 6P/IN/SY
版本 VER	A0

您正在使用 ZWCAD 2022 个人版, 不得用于商业用途, 详情请咨询 40077482-588.