

REV.	ECN NO.	DESCRIPTION	DATE	DESIGN
A	ECN NO.	INITIAL RELEASED	23/05/21	Lin R

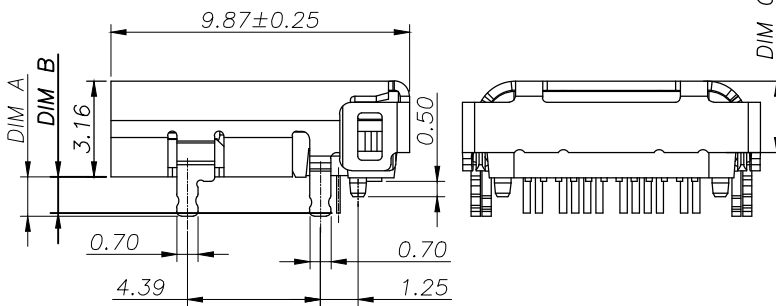

NOTE:

- MATERIAL SPECIFICATION:
 - HOUSING: HIGH TEMPERATURE RESISTANT PLASTIC, UL94 V-0.
 - CONTACTS: COPPER ALLOY
 - MID PLATE: STAINLESS STEEL
 - FRONT SHELL: STAINLESS STEEL
 - EMI PLATE: STAINLESS STEEL
- PLATING SPECIFICATION:
 - CONTACTS:
 - Ni 50u" MIN. UNDER PLATED OVER ALL.
 - Au PLATED ON THE FUNCTIONAL AREA OF CONTACT. (GOLD PLATING THICKNESS FOLLOW THE P/N)
 - FRONT SHELL: PLATING SPECIFICATIONS FOLLOW THE P/N
 - MID PLATE & EMI PLATE: CLEAR ONLY
- MECHANICAL PERFORMANCE,
 - INSERTION FORCE: 0.5~2.0kgf.
 - REMOVAL FORCE: 0.8kgf~2.0kgf.
 - DURABILITY: 10000 CYCLES.
- ELECTRICAL PERFORMANCE,
 - CURRENT RATING: 5.0A
VOLTAGE RATING: 5.0V
 - LLCR:
 - VBUS & GND PINS AND OTHER PINS: 40mΩ/PIN MAX.
 - SHIELD: 50mΩ/MAX.
 - LLCR MAX. CHANGE OF ALL PINS: 10mΩ.
 - INSULATION RESISTANCE: 100MΩ MIN
 - DIELECTRIC WITHSTAND VOLTAGE, AC 100V FOR 1 MINUTE.
- ENVIRONMENTAL PERFORMANCE:
 - OPERATING TEMPERATURE: -25°C~+85°C.
- IR REFLOW:
 - THE PEAK TEMPERATURE ON THE BOARD SHALL BE MAINTAINED FOR 10 SECONDS AT 260°C.

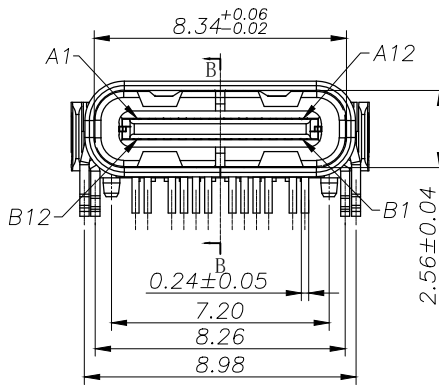
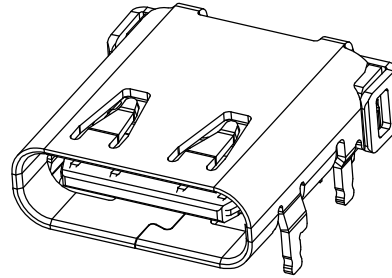
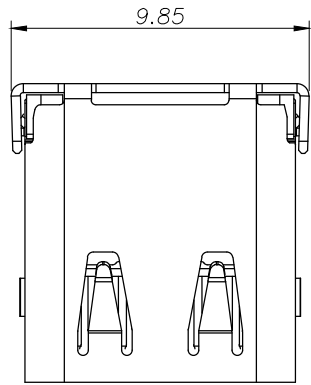
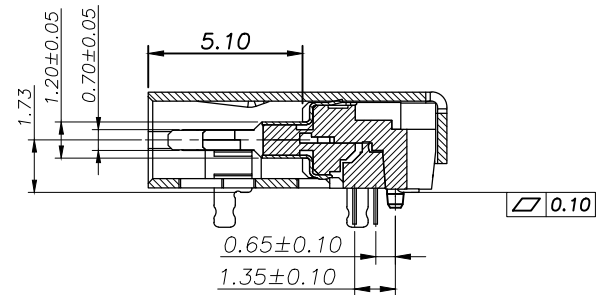

SECTION B-B
SCALE 1:1

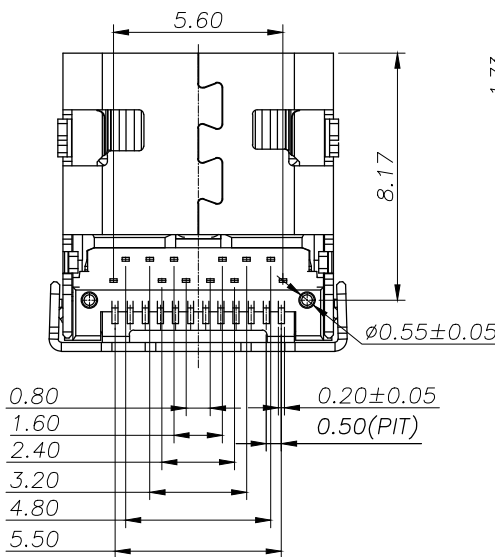

TOLERANCE		NAME (INTENDED USE) CUSTOMER DRAWING			
X.X ±0.30	X.* ±10°	PART NO. ZX-TYPEC-WTM2448-QC	TITLE: Type-C 母座 卧贴		
.XX ±0.20	.X* ± 8°	DESIGN: Lin R	DRAWG NO. ZX-TYPEC-WTM2448-QC		
.XXX ±0.10	.XX* ± 5°	UNITS: mm			
MATERILA	CHED:	APPD:	SCALE: 1:1	SHEET: 1/3	REV. A
FINISH					

REV.	ECN NO.	DESCRIPTION	DATE	DESIGN
A	ECN NO.	INITIAL RELEASED	23/05/21	Lin R

TABLE 1

ITEM	P/N	DIM"A"	DIM"B"	DIM"C"	HOUSING CLOER	PLATING	
						MATING AREA	SOLDER AREA
1	ACF005-1E1H1A103-0HR	1.30	1.20	1.96	BALCK	Au:3u"	Au:G/F

USB TYPE-C PIN ASSIGNMENTS

PIN NUMBER	SIGNAL NAME	PIN NUMBER	SIGNAL NAME
A1	GND	B12	GND
A2	TXp1+	B11	RXp1+
A3	TXn1-	B10	RXn1-
A4	Vbus	B9	Vbus
A5	CC1	B8	SBU2
A6	Dp1	B7	Dn2
A7	Dn1	B6	Dp2
A8	SBU1	B5	CC2
A9	Vbus	B4	Vbus
A10	RXn2-	B3	TXn2-
A11	RXp2+	B2	TXp2+
A12	GND	B1	GND

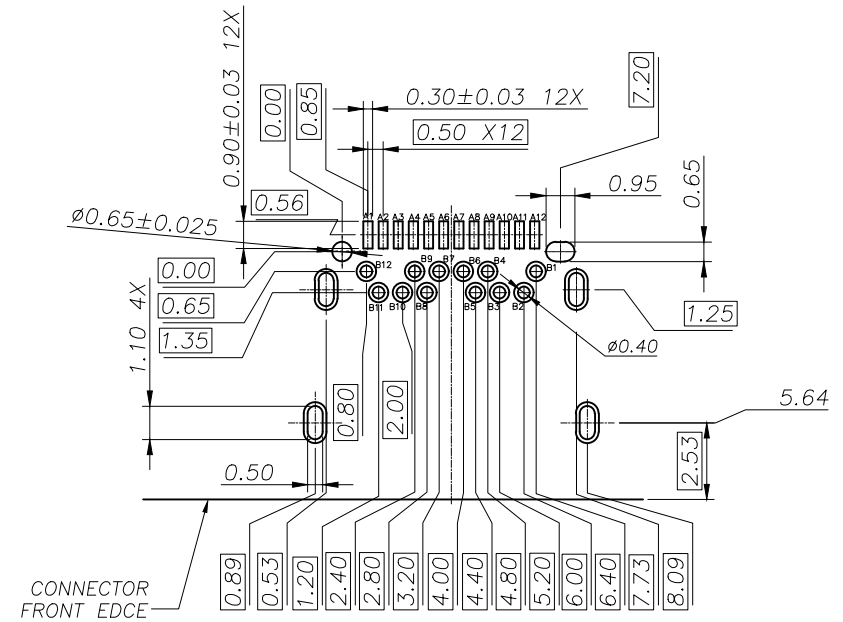

RECOMMENDED P.C.B. LAYOUT (T=1.00mm)
TOLERANCE UNSPECIFIED ±0.05mm

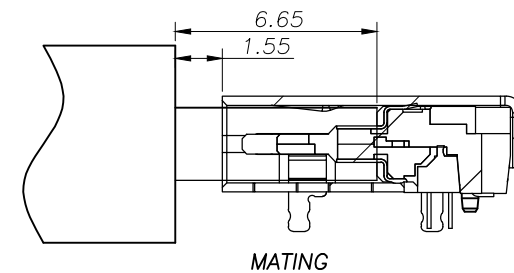

TOLERANCE		NAME(INTENDED USE) CUSTOMER DRAWING			
X.X ±0.30	X.* ±10°	PART NO.	TITLE:		
.XX ±0.20	.X* ± 8°	ZX-TYPEC-WTM2448-QC	Type-C 母座 卧贴		
.XXX ±0.10	.XX* ± 5°	DESIGN: Lin R	DRAWG NO.		
UNITS	mm	CHED:	SCALE SHEET REV.		
MATERILA		APPD:	1:1	2/3	A
FINISH					

REV.	ECN NO.	DESCRIPTION	DATE	DESIGN
A	ECN NO.	INITIAL RELEASED	23/05/21	Lin R

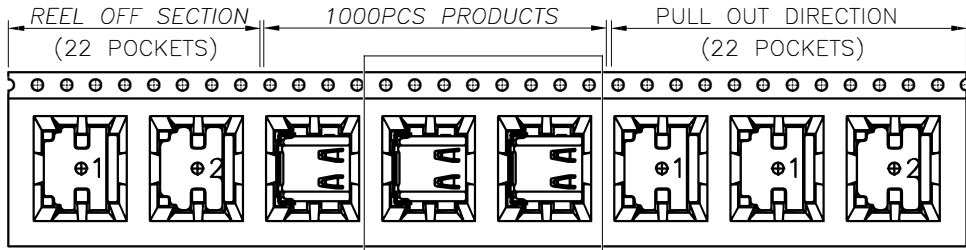

SEE DETAIL X

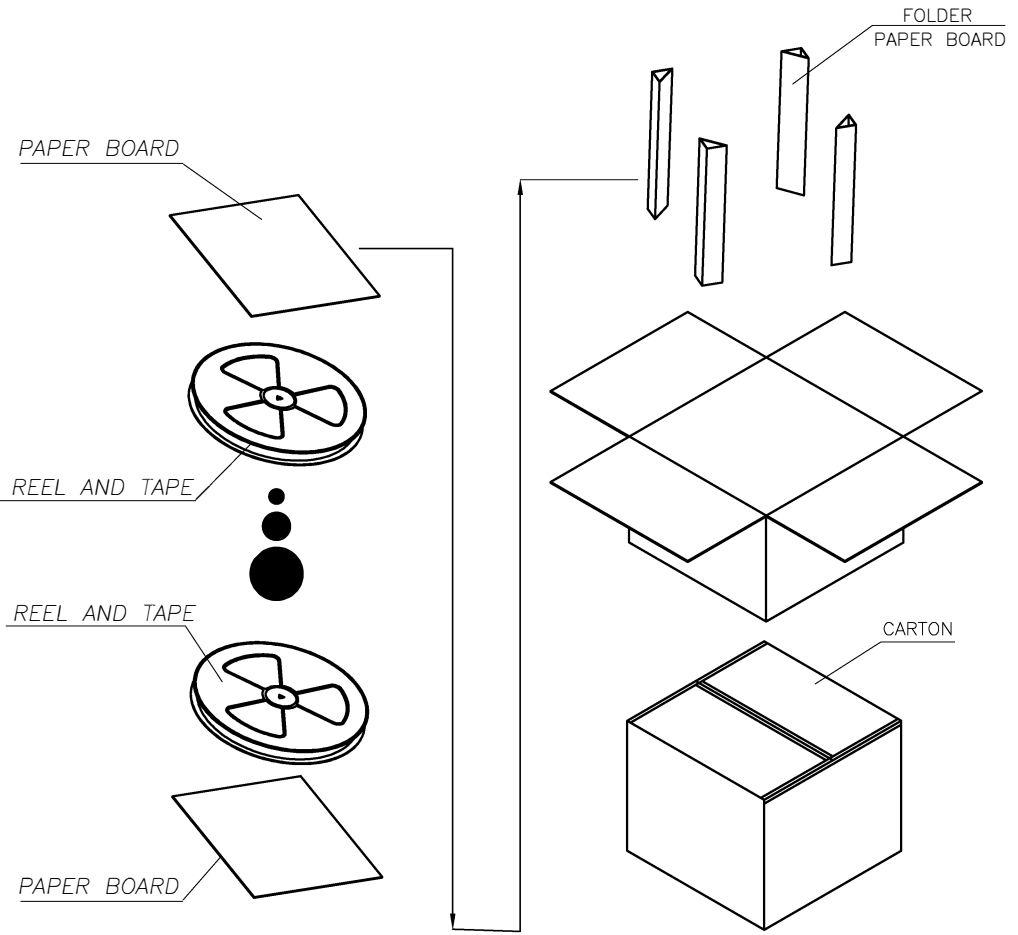
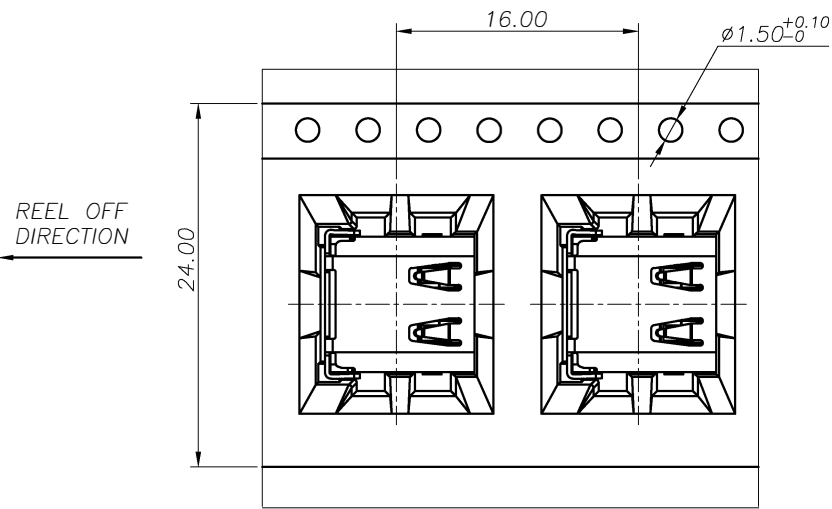
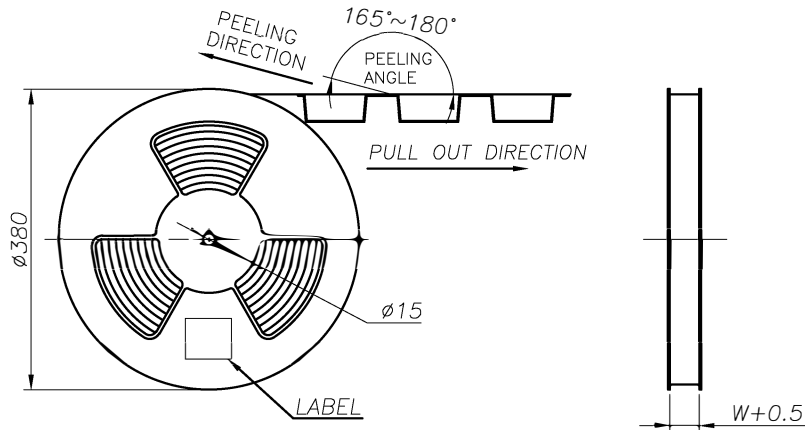

	REEL/TRAY	CARTON
CONNECTOR (PCS)	1000	10000

TOLERANCE		NAME(INTENDED USE) CUSTOMER DRAWING			
X.X	± 0.30	X.*	$\pm 10^{\circ}$	PART NO.	
.XX	± 0.20	.X*	$\pm 8^{\circ}$	ZX-TYPEC-WTM2448-QC	
.XXX	± 0.10	.XX*	$\pm 5^{\circ}$	TITLE: Type-C 母座 卧贴	
UNITS	mm		DESIGN: Lin R		
MATERILA			DRAWG NO.		
FINISH			CHED:		
APPD:					
			SCALE	SHEET	REV.
			1:1	3/3	A