

X	
PART NO	vigor
2	G2
3	G3
4	G4
5	G5
6	G6
7	G7
8	G8

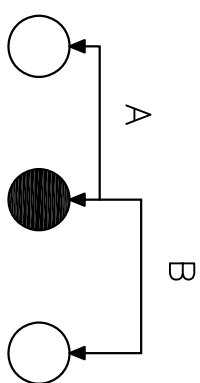

Circuit Diagram



- Specification:
1. Rating: DC 30V 50mA
  2. Travel:  $2.5 \pm 0.1$ mm
  3. Operating Force: A-B 150gf  $\pm 75$ gf  
B-A 150gf  $\pm 75$ gf
  4. Contact Resistance:  $100m\Omega$  Max
  5. Life: 10,000 Cycles Min

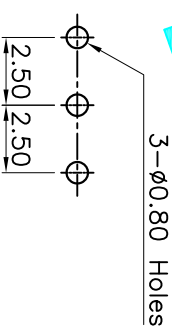

P.C.B Layout

ITEM	PART NAME	QTY.	MATERIAL	FINISHING
⑤	Contact	1	Phosphor Bronze	Ag Plated
④	Terminal	3	Brass Strip	Ag Plated
③	Base	1	Phenolic Resin	Natural
②	Frame	1	STEEL STRIP	Ni Plated
①	Knob	1	POM	Black

APPROVALS		DATE	DRAWING NO.	
DRAWN	G.M.Chen	2014/11/25	SS-12D01-GX	
CHECKED			TITLE: VERTICAL SLIDE SWITCHES	
APPROVALS			PART NO.	
TOLERANCES ARE		30 <sup>±0.15</sup>	±0.30	ANGLE
		10 <sup>±0.10</sup>	±0.20	UNIT: mm
		5 <sup>±0.10</sup>	±0.15	SCALE: 1:1
				SHEET 1 OF 1
ECN NO.	REV.	DATE.	DESCRIPTION.	CHANGE.
	A		NEW	CHECK.
				APPRO.

**DEALON** 德隆  
ELECTRONICS CO.,LTD

