

TYPE 1

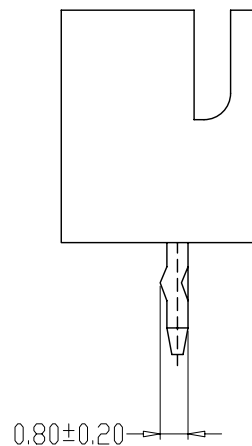

TYPE 2

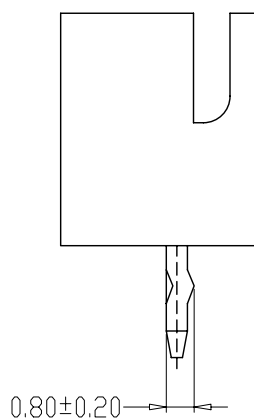
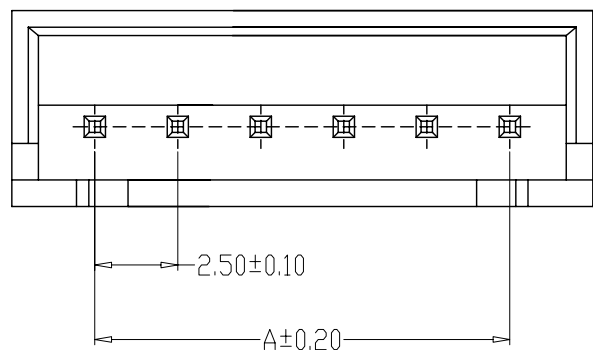

TYPE 3

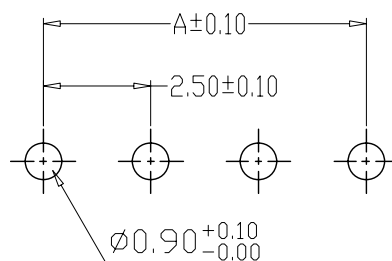

PCB LAYOUT

SPECIFICATIONS

- 1、Current Rating: 3A AC, DC
- 2、Voltage Rating: 250V AC, DC
- 3、Temperatuer Range: -25℃~+85℃
- 4、Contact Resistance: 20mΩ Max
- 5、Insulation Resistance: 1000MΩ Min
- 6、Withstanding Voltang: 1000V AC/minute
- 7、Material: Wafer Nylon66, UL94V-0
PIN Brass Tin-plated

编 号	尺寸 (mm)	
	A	B
A2501-02A	2.50	7.50
A2501-03A	5.00	10.00
A2501-04A	7.50	12.50
A2501-05A	10.00	15.00
A2501-06A	12.50	17.50
A2501-07A	15.00	20.00
A2501-08A	17.50	22.50
A2501-09A	20.00	25.00
A2501-10A	22.50	27.50
A2501-11A	25.00	30.00
A2501-12A	27.50	32.50
A2501-20A	47.50	52.50

制图 DRAWN	变更内容 DESCRIPTION	日期 DATE	GENERAL TOLERANCE		制图 DRAWING	料号 PART NO.	ZX-XH2.54-9PZZ		版本 REV.	A
			.X±0.25	.X*±2'			品名 TITLE	页次 SHEET		
			.X±0.20	.X*±1'	审核 CHECK	客户料号 CUTM. NO.				
			.XX±0.15	.XX*±0.5'	核准 APPROVAL					
			.XXX±0.10	.XXX*±0.5'	单位 UNITS	比例 SCALE	1:1	兆星精密电子(深圳)有限公司		