

- Specifications:**  
 规格:
- 1.Voltage rating:250VAC/DC  
 额定电压: 250V AC/DC
  - 2.Current rating:3A AC/DC  
 额定电流: 3A AC/DC
  - 3.Withstanding voltage:1000V AC/minute  
 耐受电压: 1000V AC/分钟
  - 4.Temperature range: -25°C-+85°C  
 温度范围: -25°C-+85°C
  - 5.Insulation resistance:1000MΩ MIN  
 绝缘电阻: 1000MΩ MIN
  - 6.Contact resistance:10mΩ Max  
 接触电阻: 10mΩ Max

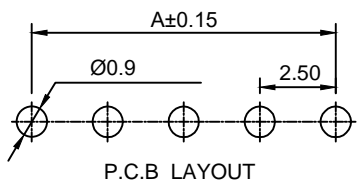
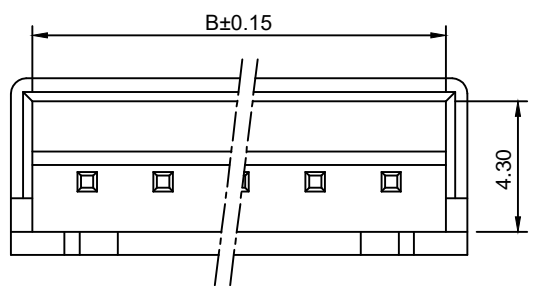
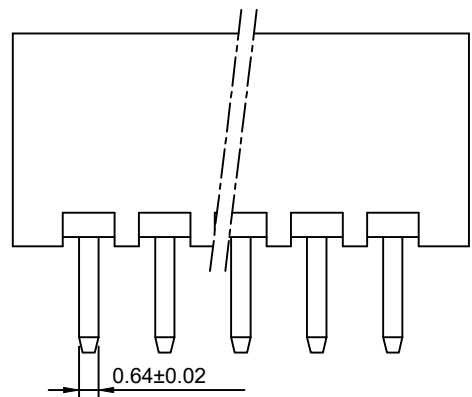
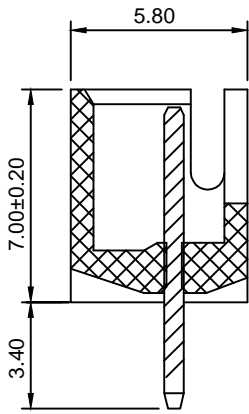
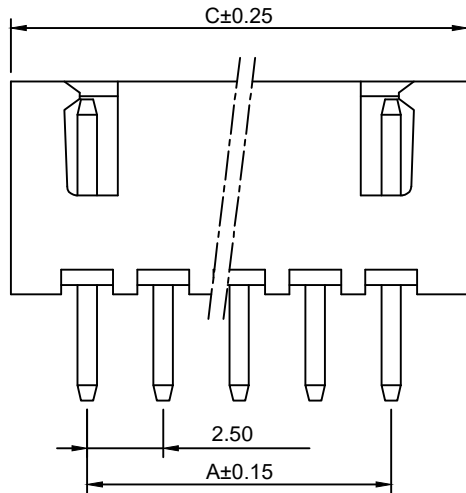

8821WV-XXP	Nylon UL94V-0	Brass	Tin Plated	8821H
Series No.	Material	Material	Metal plating	Mate with Housing

Circuits	Dimensions		
	A	B	C
2	2.50	6.10	7.50
3	5.00	8.60	10.00
4	7.50	11.10	12.50
5	10.00	13.60	15.00
6	12.50	16.10	17.50
7	15.00	18.60	20.00
8	17.50	21.10	22.50
9	20.00	23.60	25.00
10	22.50	26.10	27.50
11	25.00	28.60	30.00
12	27.50	31.10	32.50
13	30.00	33.60	35.00
14	32.50	36.10	37.50
15	35.00	38.60	40.00
16	37.50	41.10	42.50

ECN BO.		new		2015/5/3	A	瀚源
DESIGNED	CHECKED	APPROVAL	DRAWING NUMBER	DATE.	REV.	
Mikey	Tom	Jerry	PART NAME	8821WV-XXP	UNLESS OTHERWISE SPECIFIED,TOLERANCE:	X. ±0.25 X.x ±0.20 X.xx ±0.15 ANGULAR ±3°
			MODEL NAME	H-8821WV-XXP		
			3RD ANGLE PROJ	HanElectricity Co.,LTD		FILE.NO.