

适应基板厚度: 1.2mm~1.6mm

温度范围: -25℃~85℃

额定电压: 250V AC/DC

额定电流: 1A

绝缘电阻: ≥1000MΩ

耐压: 800V AC/minute

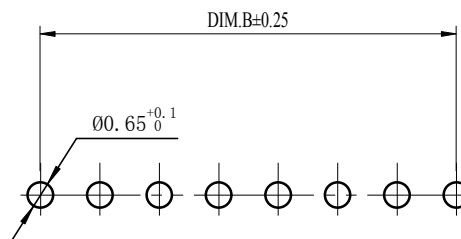
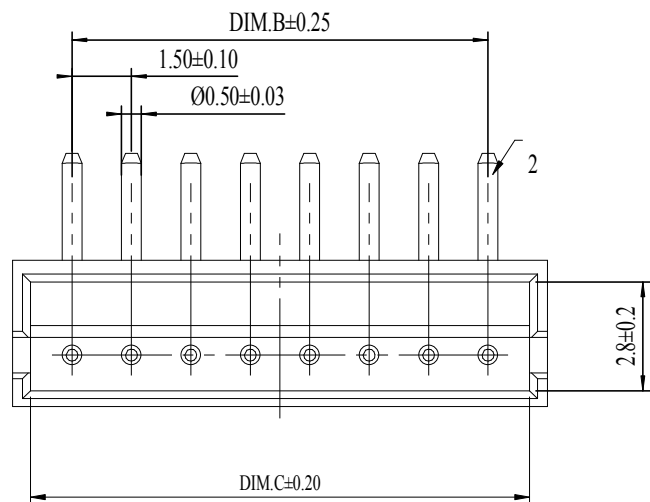

PCB Layout

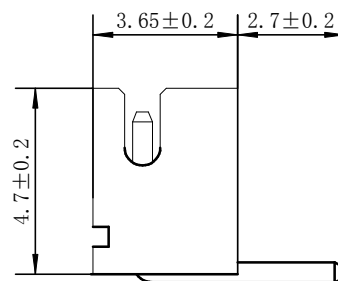
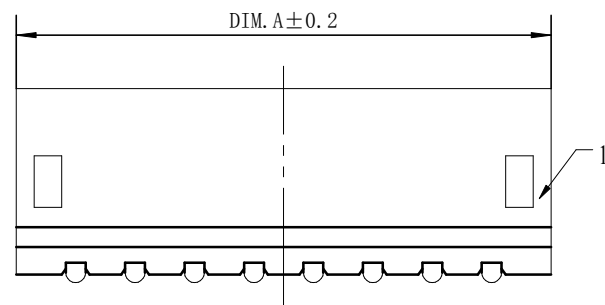

15	24.00	21.00	23.10
14	22.50	19.50	21.60
13	21.00	18.00	20.10
12	19.50	16.50	18.60
11	18.00	15.00	17.10
10	16.50	13.50	15.60
9	15.00	12.00	14.10
8	13.50	10.50	12.60
7	12.00	9.00	11.10
6	10.50	7.50	9.60
5	9.00	6.00	8.10
4	7.50	4.50	6.60
3	6.00	3.00	5.10
2	4.50	1.50	3.60
Pin	DIM A	DIM B	DIM C

2	PIN	n PCS	材质:黄铜,电镀:镀完锡60u"MIN
1	Housing	1 PCS	材质:PA66 (UL94V-0),颜色:本色或黑色
NO.	NAME	QTY	DESCRIPTION

1502WR-XXP	PA66 UL94V-0	1502H	1502T
PART NO	Material	Suitable Housing	Suitable Terminal

—		new		2015/5/3		A		瀚源	
ECN BO.		DESCRIPTION.		DATE.		REV.			
DESIGNED	CHECKED	APPROVAL	DRAWING NUMBER			SCALT: 1/2		SCALE: 3:1	
Mikey	Tom	Jerry	PART NAME	1502WR-XXP	UNLESS OTHERWISE SPECIFIED,TOLERANCE:		X.	±0.25	
			MODEL NAME	H-1502WR-XXP			X.x	±0.20	
			3RD ANGLE PROJ	HanElectricity Co.,LTD				X.xx	±0.15
			3RD ANGLE PROJ		HanElectricity Co.,LTD			FILE.NO.	