

SPECIFICATION FOR APPROVAL

承 認 書

CUSTOMER

客戶名稱：

NUMBER

编号： L075

DESCRIPTION

型 号： CD75 系列

QUANTITY

數量：10PCS

PART NO.

品 名： SMD POWER INDUCTORS

DATE

日期：2023.04.12

CUSTOMER PART NO.

客戶料號：

NOTE

注解：

APPROVAL SIGNATURE

客戶承認簽章

Approved By 核 准	Checked By 审 查	Drawn By 制 作
李庆辉	刘志坚	劳水花

深圳市柯爱亚电子有限公司

Shenzhen Ceaiya Electronics Co., Ltd.

深圳地址：深圳市龙华区高新技术开发区捷顺科技中心 B706

东莞地址：东莞市清溪镇力合紫荆智造中心 10 栋一单元

Http://www.szceaiya.com Tel: 0769-89135516 Fax: 0769-89135519



History of change

Rev.	Effective Date	Changed Contents	Change reasons	Approved By
A0	2016.07.05	New release		

1. Shape and Dimension (Unit:mm)

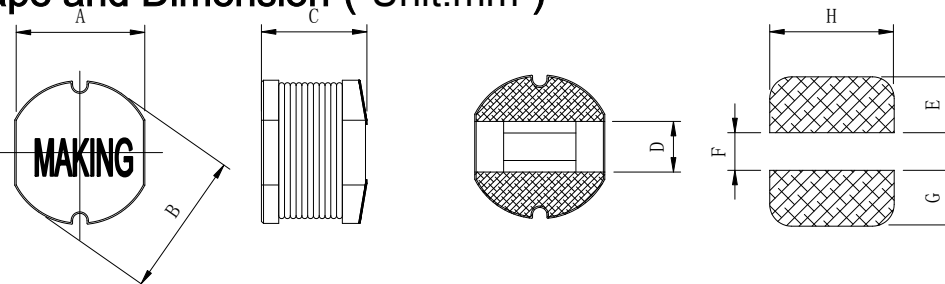

A	B	C	D	E	F	G	H
7.0 ± 0.3	7.8 ± 0.3	5.5Max	2.5	3.0	2.0	3.0	7.5

2. Electronic Characteristics List

Part Number	Inductance (μH)	Tolerance (±%)	DCR(Ω) (Max)	I.D.C ※ (A)	Marking	测试仪器
CD75-R82N	0.82	30	12.5m	5.20	R82	LCR : HIOKI3532 MICROTEST6337 DCR : HIOKI3540 DC BIAS : MICROTEST6220
CD75-1R2N	1.2	30	15.0m	5.20	1R2	
CD75-1R5M	1.5	20	18.0m	5.10	1R5	
CD75-2R2M	2.2	20	21.0m	5.00	2R2	
CD75-2R7M	2.7	20	25.0m	4.60	2R7	
CD75-3R3M	3.3	20	28.0m	4.00	3R3	
CD75-3R9M	3.9	20	35.0m	4.00	3R9	
CD75-4R7M	4.7	20	36.0m	3.80	4R7	
CD75-5R6M	5.6	20	42.0m	3.10	5R6	
CD75-6R8M	6.8	20	52.0m	2.80	6R8	
CD75-8R2M	8.2	20	55.0m	2.52	8R2	
CD75-100K	10	10	50.0m	2.31	100	
CD75-120K	12	10	55.0m	2.00	120	
CD75-150K	15	10	71.5m	1.81	150	
CD75-180K	18	10	84.5m	1.59	180	
CD75-220K	22	10	91.0m	1.50	220	
CD75-270K	27	10	106.6m	1.28	270	
CD75-330K	33	10	119.6m	1.20	330	
CD75-390K	39	10	149.5m	1.08	390	
CD75-470K	47	10	175.5m	1.05	470	
CD75-560K	56	10	208.0m	0.93	560	
CD75-680K	68	10	234.0m	0.83	680	
CD75-820K	82	10	273.0m	0.78	820	
CD75-101K	100	10	325.0m	0.73	101	
CD75-121K	120	10	390.0m	0.65	121	
CD75-151K	150	10	520.0m	0.58	151	
CD75-181K	180	10	598.0m	0.51	181	
CD75-221K	220	10	793.0m	0.48	221	
CD75-271K	270	10	884.0m	0.40	271	
CD75-331K	330	10	1.13	0.39	331	
CD75-391K	390	10	1.30	0.35	391	
CD75-471K	470	10	1.68	0.33	471	
CD75-561K	560	10	1.90	0.30	561	
CD75-681K	680	10	2.47	0.27	681	
CD75-821K	820	10	2.86	0.25	821	

※ This indicates the value of current when the inductance is 10% lower than its initial value at D.C superposition or D.C current when temperature rise ΔT=40℃ whichever is lower .(Ta=20℃)
 测试条件: (L≤8.2uH 用 100KHz / 0.25V; L>8.2uH 测试频率 1KHz / 0.25V.)

3. General Characteristics

3-1. Storage Temperature range : $-40^{\circ}\text{C} \sim +125^{\circ}\text{C}$

3-2. Operating temperature range: $-40^{\circ}\text{C} \sim +125^{\circ}\text{C}$ (Including coil's self temperature rise)

3-3. External appearance : No external defects can be found in the visual inspection.

3-4. Electrode strength : No electrode detachment should be found when the device is pushed in two directions of X and Y with the force of 10.0N for 10 ± 2 seconds after soldering between copper plate and the electrodes.
(Refer to figure at right)

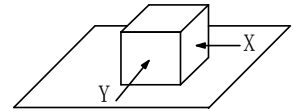

3-5. Vibration test : Inductance deviation is within $\pm 3.0\%$ after 1 hour sweeping vibration in each three directions, namely, forward and backward, up and down, right and left. The frequency is $10 \sim 55 \sim 10\text{Hz}$ and the amplitude of 1 minute cycle is 1.5mm PP.

3-6. Recommended reflow condition:

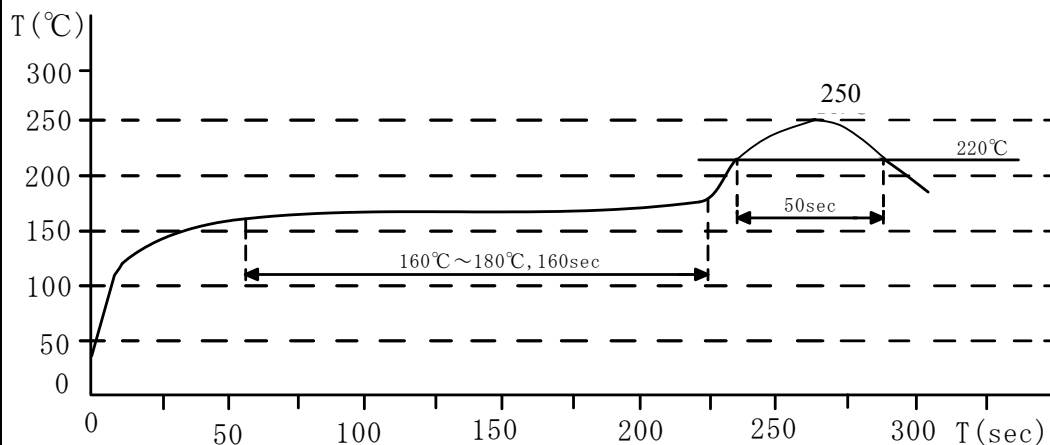

3-7. Humidity test : Inductance deviation is within $\pm 5.0\%$ after 96 ± 4 hours test under the condition of relative humidity of $90 \sim 95\%$ and temperature of $40 \pm 2^{\circ}\text{C}$,
and 1 hour storage under room ambient conditions after the device is wiped with dry cloth.

LEAD-FRE



4. Construction and materials

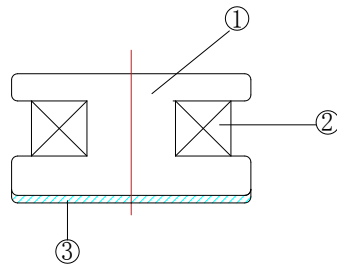

No.	Part name	Material	Ceaiya P/N
①	Drum Core	Ni-Zn Ferrite Core	(BL,DC)
②	Wire	Polyurethane enameled copper wire	3210250
③	Electrode	Cu + Sn plating	

5. Packaging and Marking:

5-1. Carrier Tape Dimensions:

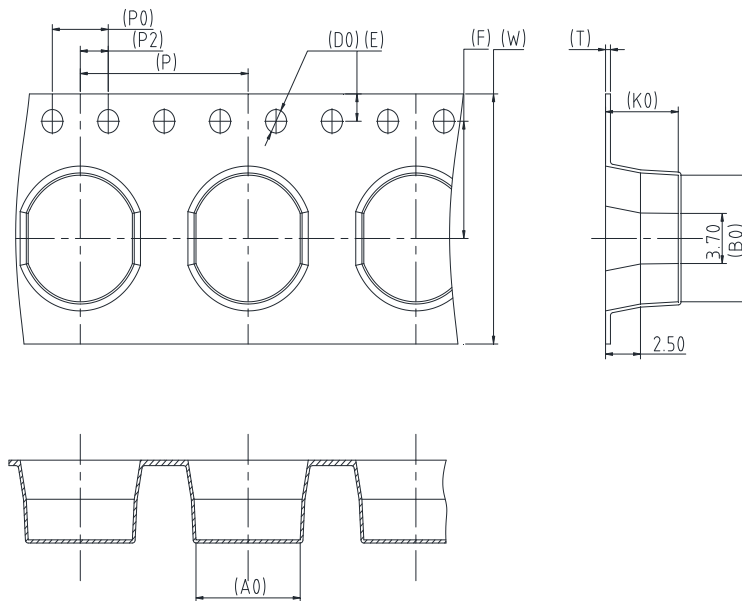

ITEM	W	A0	B0	K0	P	F	E	D0	P0	P2	T
DIM	16.00	7.2	8.1	5.5	12.00	7.50	1.75	1.50	4.00	2.00	0.40
TOLE	+0.30 -0.10	±0.1	±0.1	±0.1	±0.1	±0.1	±0.1	+0.1	±0.1	±0.1	±0.05

6. CARRIER REEL DIMENSIONS:

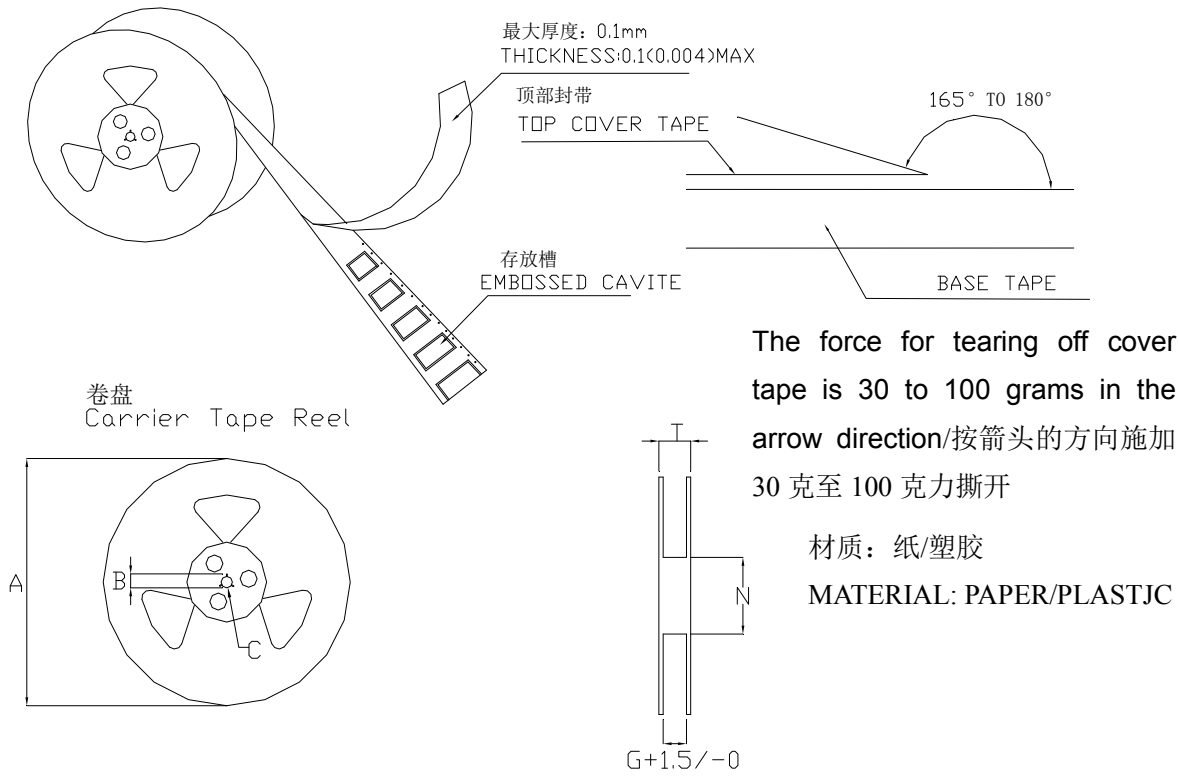

Type	A	B	C	G	N	T
16mm	330	21±0.8	13±0.4	16.4	100	20.4

7. PACKAGE SPECIFICATION:

1.0KPCS/ Reel 3.0KPCS/ Inner Box 9KPCS/ Outer Box

编带方向 , 如下图所示

