

THE INFORMATION CONTAINED IN THIS DRAWING IS THE SOLE PROPERTY OF L-COM, INC. ANY REPRODUCTION IN PART OR WHOLE WITHOUT THE WRITTEN PERMISSION OF L-COM, INC. IS PROHIBITED.

REVISIONS			
REV	DESCRIPTION	DATE	APPROVED
A	CN PRELIMINARY RELEASE	2/18/11	B. ZHANG
B	ECN 6854: ADDED PACKAGING PS-0031, UPD FORMAT & COMPLIANCE NOTE	5/23/13	D. DESJARDIN
C	REVISED PACKAGING NOTE TO PKG-00012 FROM PS-0031	7/26/13	D. FRISIELLO

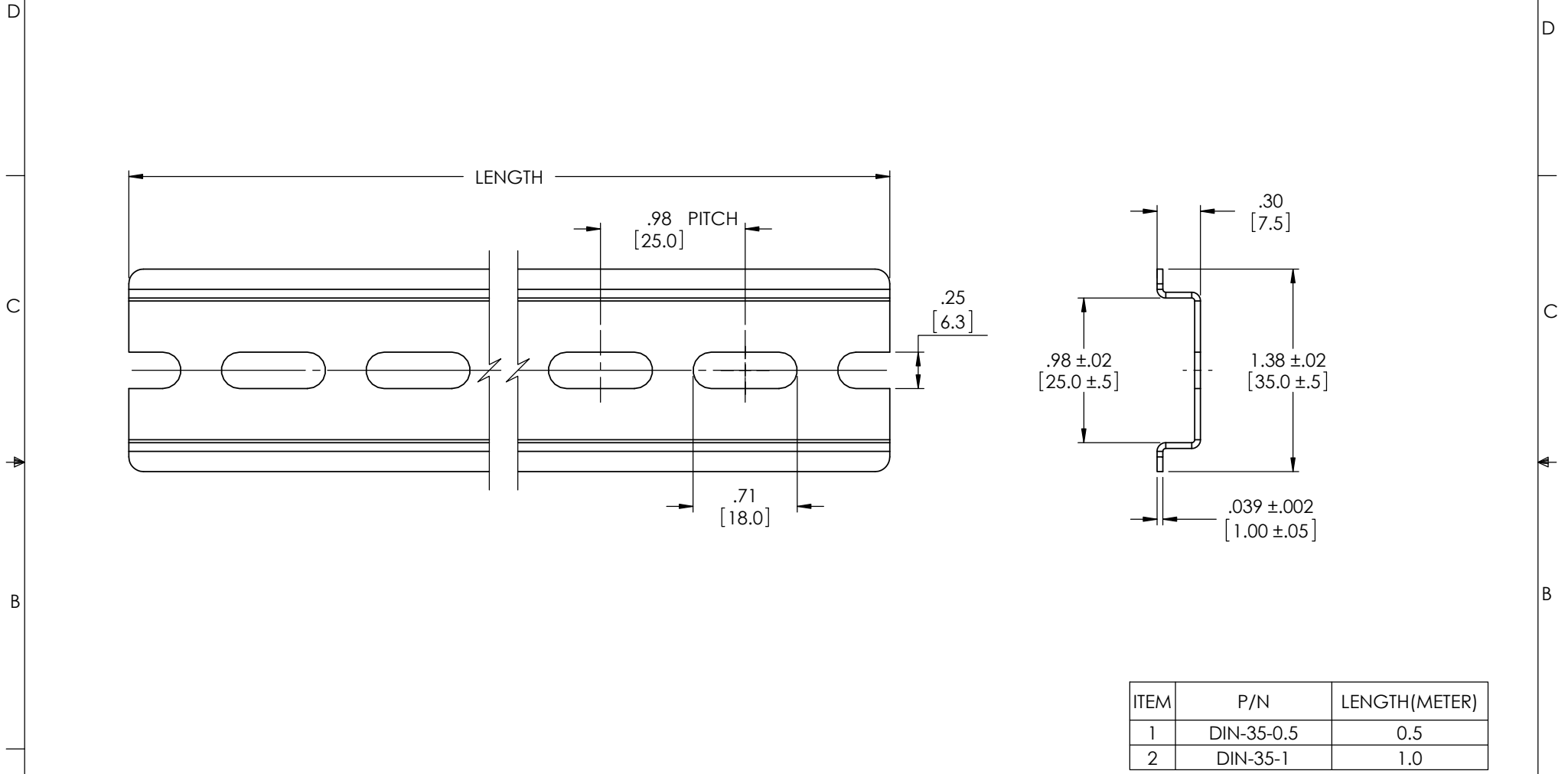

ITEM	P/N	LENGTH(METER)
1	DIN-35-0.5	0.5
2	DIN-35-1	1.0

**NOTES:**

1. MATERIAL: RUGGED CONSTRUCTION STEEL
2. PLATING: ZINC PLATED
3. DIN RAIL SHALL BE INDIVIDUALLY PACKAGED IN ACCORDANCE WITH L-COM SPECIFICATION PKG-00012.

**REGULATORY COMPLIANCE:**  
ROHS, CE



UNLESS OTHERWISE SPECIFIED, DIMENSIONS ARE IN INCHES [mm] OVERALL CABLE LENGTH TOLERANCE: ≤12 [305] = +1 [25] / -0 >12 [305] ≤60 [1524] = +2 [51] / -0 >60 [1524] ≤120 [3048] = +4 [102] / -0 >120 [3048] ≤300 [7620] = +6 [152] / -0 >300 [7620] = +5% / -0% ALL OTHER DIMENSIONAL TOLERANCES: .X = ± .2 .XX = ± .02 .XXX = ± .005	APPROVALS DRAWN BY B. ZHANG CHECKED BY F. MAO APPROVED BY T. LU	DATE 2/18/11 2/18/11 2/18/11	45 BEECHWOOD DRIVE NORTH ANDOVER, MA 01845	
	CONFIGURATION DETAILS OF UNDIMENSIONED FEATURES MAY VARY			CATEGORY <b>RACK/ENCLOSURES</b> PRODUCT DESCRIPTION <b>35MM DIN RAIL</b>
PROJECTION 	COLOR VARIATIONS MAY OCCUR	SIZE <b>A</b>	FSCM NO. <b>43321</b> DWG. NO. <b>DIN-35-0.5</b> SCALE: NONE CAD FILE: DIN-35-0.5.SLDDRW	REV. <b>C</b> SHEET 1 OF 1