

SPECIFICATIONS:

- ELECTRICAL CHARACTERISTICS:
 - CONTACT RESISTANCE: 30mΩ MAX.
 - DIELECTRIC WITHSTANDING VOLTAGE: 100V AC FOR ONE MINUTE.
 - INSULATION RESISTANCE: 100MΩ MIN. MEASURED BY 500 VDC.
- MECHANICAL CHARACTERISTICS:
 - INSERTION FORCE :0.5-2.0Kgf(REF.)
 - WITHDRAWAL FORCE :0.8-2.0Kgf(REF.)
- LIFE TEST: 10,000 CYCLES.
- TO CONFORM TO THE KRCONN HAZARDOUS SUBSTANCE FREE SPEC.

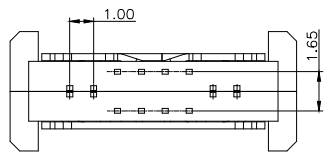
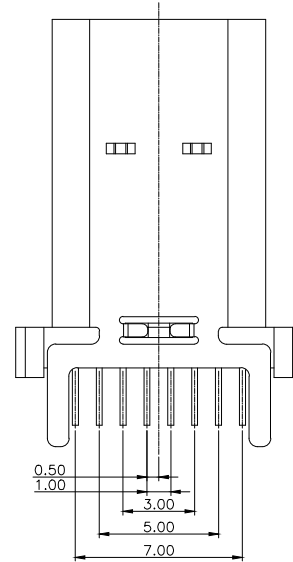
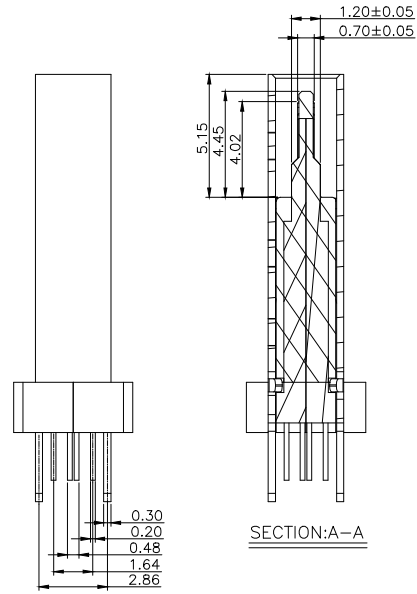
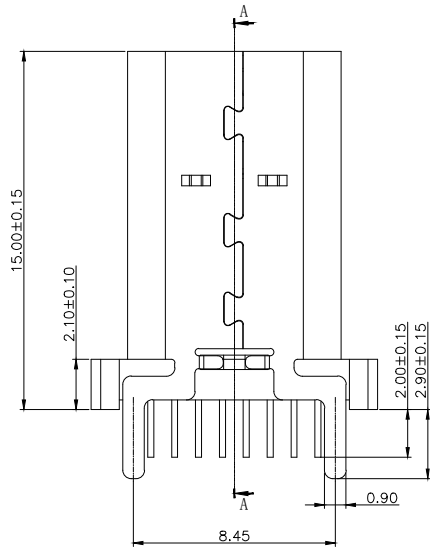
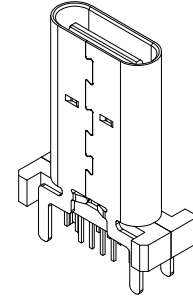

USB TYPE-C PIN ASSIGNMENTS

PIN NUMBER	SIGNAL NAME	PIN NUMBER	SIGNAL NAME
A1	GND	B12	GND
A2	SSTXP1	B11	SSRXN1
A3	SSTXN1	B10	SSRXN1
A4	VBUS	B9	VBUS
A5	CC1	B8	SBU2
A6	Dp1	B7	Dn2
A7	Dn1	B6	Dp2
A8	SBU1	B5	CC2
A9	VBUS	B4	VBUS
A10	SSRXN2	B3	SSTXN2
A11	SSRXP2	B2	SSTXP2
A12	GND	B1	GND

P/N	L	F 附长	COLOR	额定电流
HC-TYPE-C-16P-VS15-5A-F2-9-25	15.0mm	2.90mm	棕色	5A

Ordering Information

HC-TYPE-C - 16P - * - *A - F* - * - 25



GENEAL TOLERANCE		制 图	DRAWING	
DIM	TOL	审 核	CHECK	
X.X	±0.30	批 准	APPROVAL	
X.XX	±0.20	比 例	SCALE	
X.XXX	±0.10	投 影	Projection	
Angle	±3.0°			



深圳市华灿天禄电子有限公司
ShenzhenhuacantianluELECTRONICS CO., LTD

序号 No.	变更内容 MODIFY CONTENT	日期 MODIFY DATE	产品名称 TITLE	版本 REV.	单位 UNITS	页次 SHEET
1	初版发行		TYPE CF 16P 直立式 L15.0mm 无弹无柱	A	mm	1/2
			产品料号 PART NO.			
			材料 MATERIAL			