

Technical Data

Material:

Pin(outer sleeve): Brass,machined CuZn38Pb2

Clip(contact 6 finger): Beryllium Copper,heat treated

Plating(outer sleeve):

Tin plated:2μm/80μ"Ni, 5μm/200μ"Sn

Gold Plated:2μm/80μ"Ni, Full gold

Plating(contact): 2μm/80μ"Ni, gold or Tin plated

Insulator(black): Glass filled thermoplastic polyester

UL94V-0



Electrical:

Current rating: 3Amps/contact max.

Contact resistance: $54m\Omega/$contact

Insulation resistance: $\geq 1000M\Omega$ at $V=100V$

Operating voltage: 60VAC/DC

Mechanical:

Average insertion force : <math><250g</math>

with steel pin of $\varnothing 0.7mm$ - $\varnothing 0.8mm$ or $\varnothing Q0.64mm$

Average withdrawal force : $>50g$

with steel pin of $\varnothing 0.7mm$ - $\varnothing 0.8mm$ or $\varnothing Q0.64mm$

Mechanical life cycle:min.200

Operating temperatures: Gold Plated:-55°C to+105°C

Tin plated:-40°C to+105°C

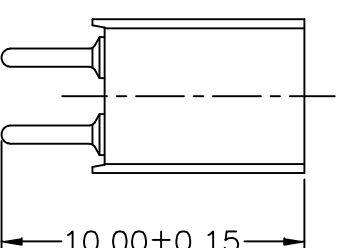
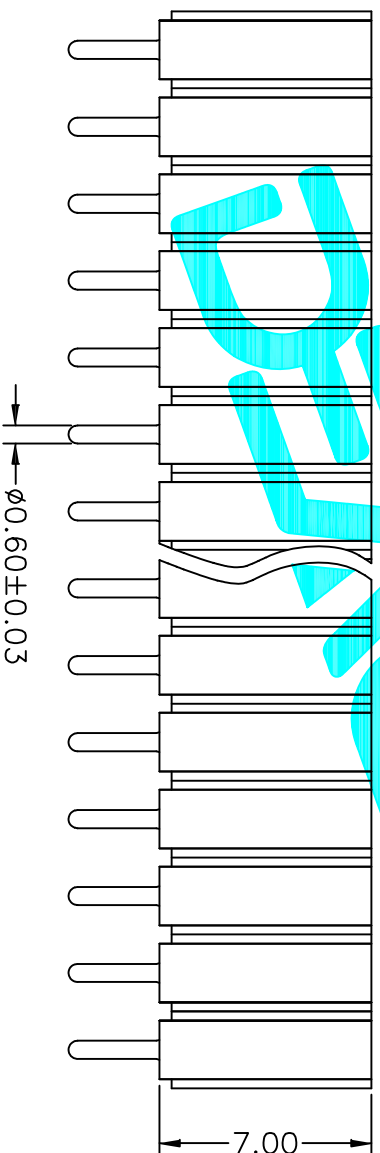
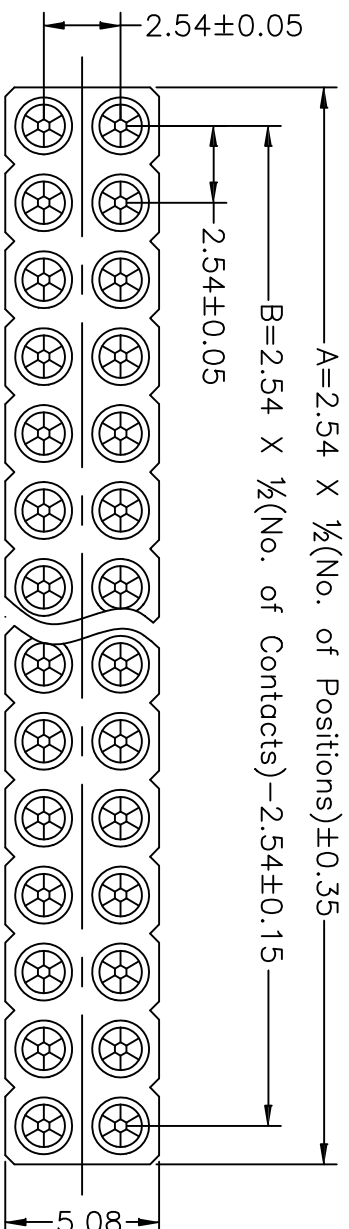

APPROVALS		DATE	TITLE:	
DRAWN	G.M.Chen	2015/7/17	Connector	
CHECKED			ELECTRONICS CO.,LTD	
APPROVALS			DEALON 德之隆®	
PART NO.		MW254R-22-XX-10	DRAWING NO.	
UNIT: mm		SCALE: 1:1	SHEET 1 OF 1	
ANGLE		±2°	PROJ.	
TOLERANCES ARE				
30 ^{±0.15}	±0.30	ANGLE		
10 ^{±0.10}	±0.20			
5 ^{±0.10}	±0.15			
~ 5	±0.10			
ECN NO.	REV.	DATE.	DESCRIPTION.	
	A		NEW	
			CHANGE.	
			CHECK.	
			APPRO.	