

版次	变更摘要	日期
0	新产品发行	2021/1/15

序号	品名	材质
①	1.50-K型立式WTB胶芯带扣	PA6T 米白色 LCP 本色
②	1.50-K型立式WTB端子	黄铜/表面镀雾锡
③	1.50-K型立式WTB吸盖	LCP 本色

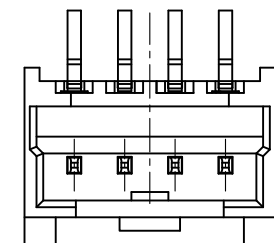
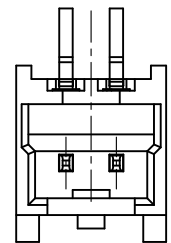
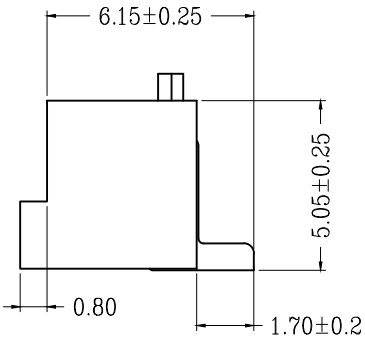
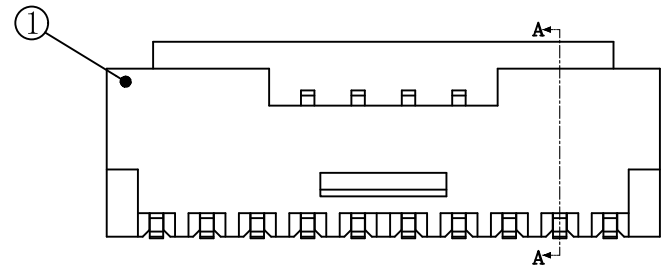
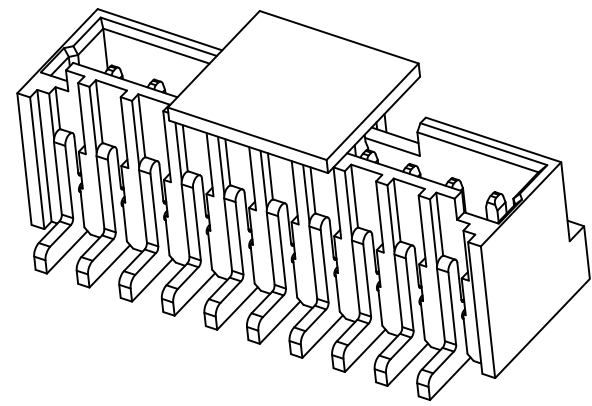
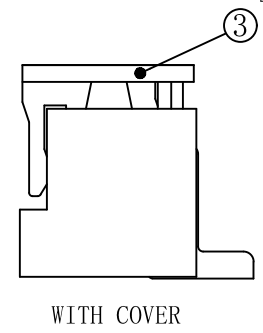
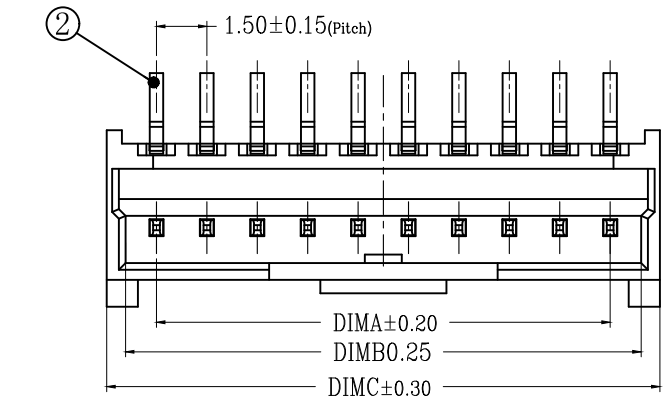

PIN 2~3

PIN 4~7

CKT	DIM A	DIM B	DIM C
2	1.50	3.35	4.46
3	3.00	4.85	5.96
4	4.50	6.35	7.46
5	6.00	7.85	8.96
6	7.50	9.35	10.46
7	9.00	10.85	11.96
8	10.50	12.35	13.46
9	12.00	13.85	14.96
10	13.50	15.35	16.46
11	15.00	16.85	17.96
12	16.50	18.35	19.46
13	18.00	19.85	20.96
14	19.50	21.35	22.46
15	21.00	22.85	23.96

- 技术指标:
- 塑件表面应光洁、无毛边、无明显收缩、缺陷、裂纹等现象。
 - 温度范围: -25° C~85° C.
 - 额定电压: 350V AC, DC.
 - 接触电阻: ≤0.02Ω.
 - 绝缘电阻: ≥1000MΩ.
 - 额定电流: 3A AC, DC.
 - 产品料号:

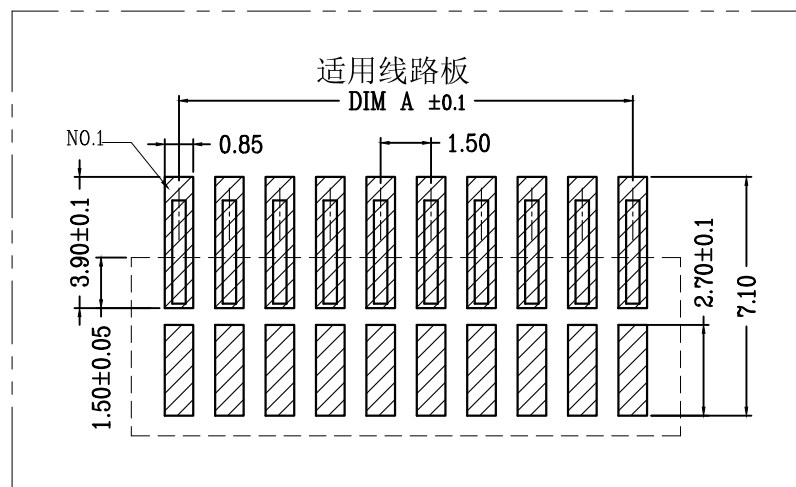

WT150KL—** * *—K**

NO OF CKT (产品PIN数) * *

Plating (电镀方式) * *

Packing (包装方式) * *

0: 端子全雾锡 R: TAPE & REEL 卷装

1: 端子全金 (G/F OVERALL) C: TAPE & REEL WITH COVER加吸盖卷装

4: 端子全亮锡

K20 胶芯LCP料带扣有LOGO:WD
 K2W 胶芯LCP料带扣/无LOGO
 K0 胶芯带扣有LOGO:WD
 KW 胶芯带扣/无LOGO

一般公差 (TOLERANCE)	
X ±0.50	.XX ±1.0
.X ±0.20	.XXX ±0.05
ANGLES ±1°	

深圳市虹成电子有限公司

品名 (TITLE)	1.50 Pitch K型立式(带扣)WTB业务图	制图 (DR)	ANLAN
料号 (DWG.NO)	HC-ZE1.5-4PLT	校对 (CHKD)	李绍宗
比例 (SCALE)	1:1	审核 (APPD)	黄志明
单位 (UNITS)	mm	张数 (SHEET)	1 OF 1
比例尺		SIZE	A4
REV	A		