

DO NOT
SCALE FROM
THIS PRINT

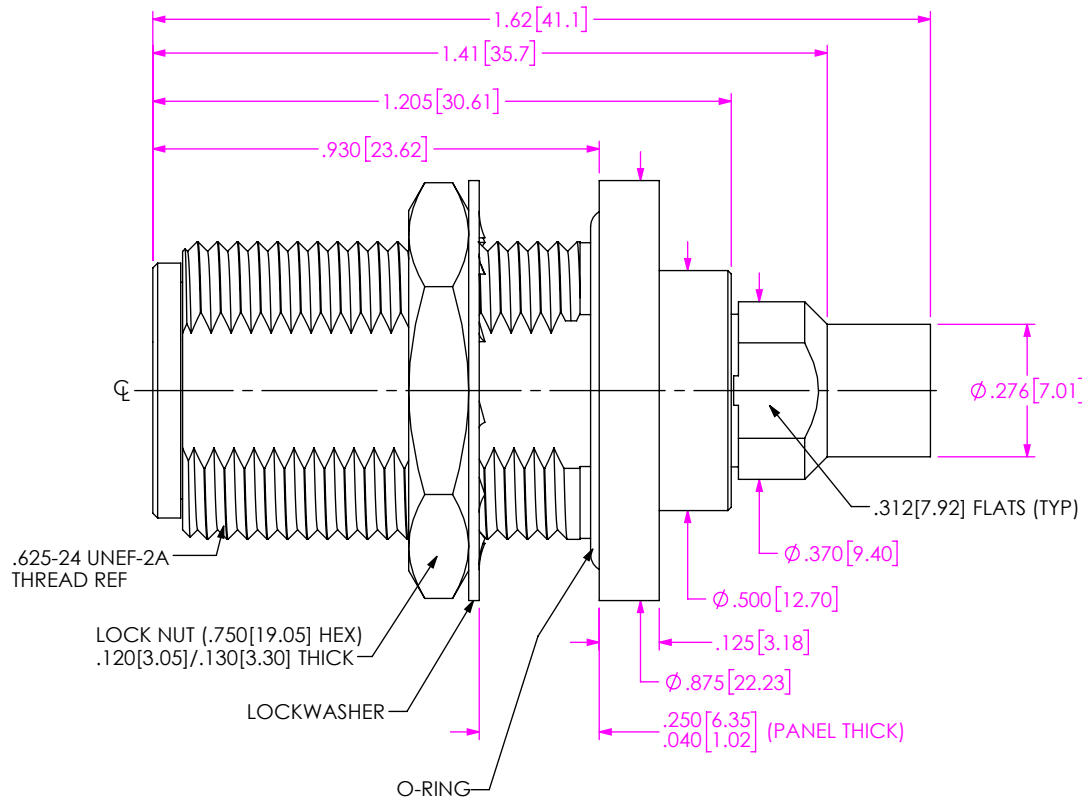

PRF06-J-C-EP-190-BS

SERIES
-06: NTPE

GENDER
-J: JACK

TYPE
-C: CABLE

TERMINATION
S: SOLDER CLAMP

ORIENTATION
-B: BULK ANGLE

CABLE TYPE
-190: SEMFLEX HP190

FINISH
-EP: 50μ" EXTRA HEAVY GOLD
CENTER CONTACT, PASSIVATED
OUTER CONTACT

DESIGNED & DIMENSIONED
IN INCHES[MILLIMETERS]

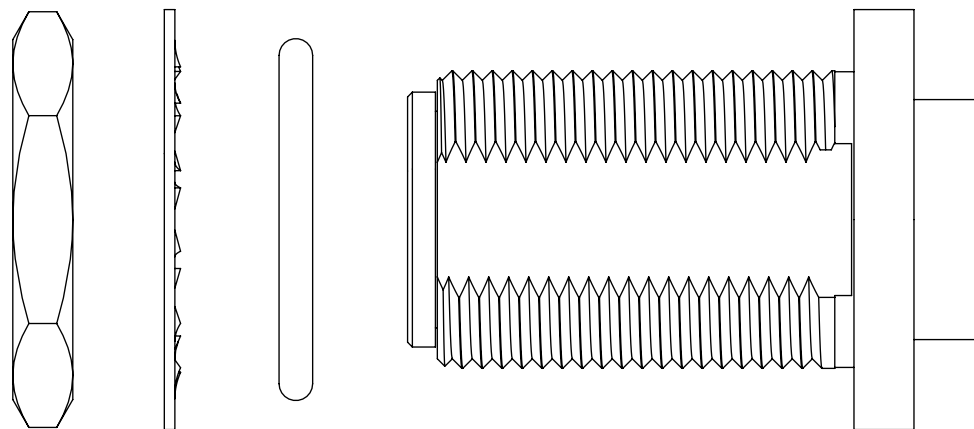
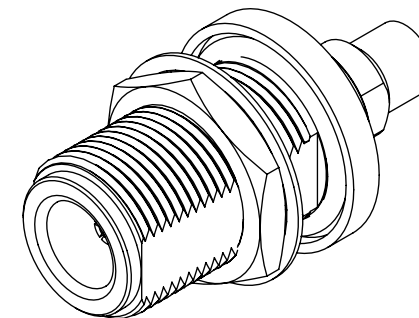

EXPLODED VIEW
NOT TO SCALE
(FOR CLARITY ONLY)

F:\DWG\MISC\MKTG\PRF06-J-C-EP-190-BS-MKT.SLDDRW

NOTES:

1. MATERIAL:
BODY, BUSHING, LOCK WASHER, LOCK NUT, CLAMP NUT: STAINLESS STEEL
CONTACT: BERYLLIUM COPPER
SOLDER FERRULE: BRASS ALLOY
BEADS: PEI
O-RINGS: SILICONE RUBBER

2. FINISH:
BODY, BUSHING, LOCK WASHER, LOCK NUT, CLAMP NUT: PASSIVATED
CONTACT, SOLDER FERRULE: 50μ" MIN. GOLD OVER 50μ" MIN. NICKEL PLATE

3. PCI P/N: 3307

UNLESS OTHERWISE SPECIFIED,
DIMENSIONS ARE IN INCHES.
TOLERANCES ARE:
DECIMALS ANGLES
.XX: ±.02 [0.5] 1°
.XXX: ±.005 [0.13]
.XXXX: ±.0005 [0.013]

PROPRIETARY NOTE
THIS DOCUMENT CONTAINS CONFIDENTIAL AND
PROPRIETARY INFORMATION AND ALL DESIGN,
MANUFACTURING, REPRODUCTION, USE, PATENT RIGHTS
AND SALES RIGHTS ARE EXPRESSLY RESERVED BY SAMTEC,
INC. THIS DOCUMENT SHALL NOT BE DISCLOSED, IN WHOLE
OR PART, TO ANY UNAUTHORIZED PERSON OR ENTITY NOR
REPRODUCED, TRANSFERRED OR INCORPORATED IN ANY
OTHER PROJECT IN ANY MANNER WITHOUT THE EXPRESS
WRITTEN CONSENT OF SAMTEC, INC.

samtec

520 PARK EAST BLVD, NEW ALBANY, IN 47150
PHONE: 812-944-6733 FAX: 812-948-5047
e-Mail: info@SAMTEC.com code 55322

DO NOT SCALE DRAWING

SHEET SCALE: 2.5:1

DESCRIPTION: N BULKHEAD JACK, SOLDER CLAMP
FOR SEMFLEX HP190 CABLE

DWG. NO. PRF06-J-C-EP-190-BS

BY: CANDY W 05/13/2019 SHEET 1 OF 3

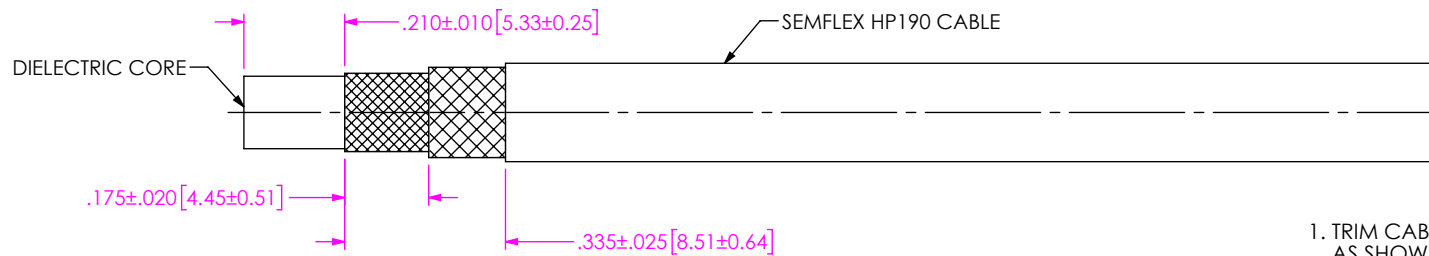

1. TRIM CABLE TO EXPOSE DIELECTRIC CORE AND OUTER BRAID AS SHOWN.

IN-PROCESS VIEW 1

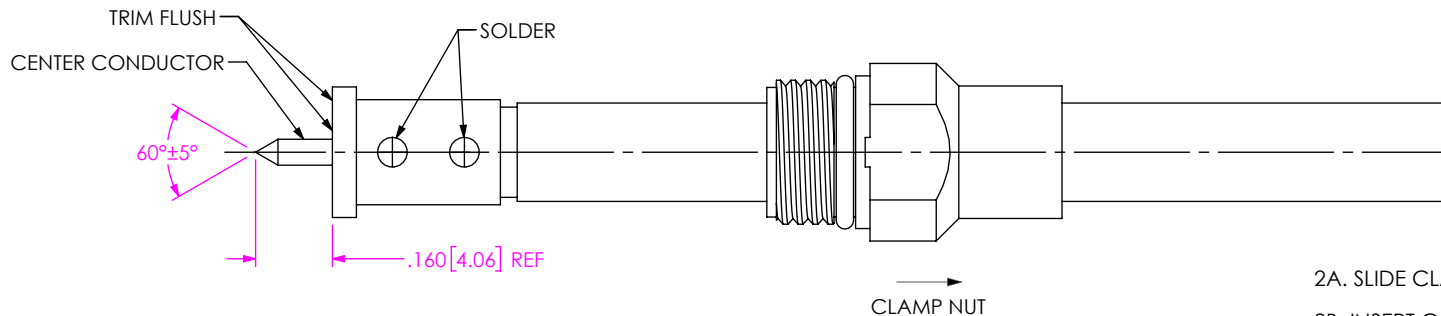

- 2A. SLIDE CLAMP NUT OVER CABLE IN ORIENTATION AS SHOWN.
 2B. INSERT CABLE INTO SOLDER FERRULE UNTIL BRAIDS SEATS AND SOLDER TO FERRULE WHERE SHOWN.
 2C. TRIM DIELECTRIC CORE FLUSH WITH FACE OF SOLDER FERRULE.
 2D. POINT CENTER CONDUCTOR AS SHOWN.

IN-PROCESS VIEW 2

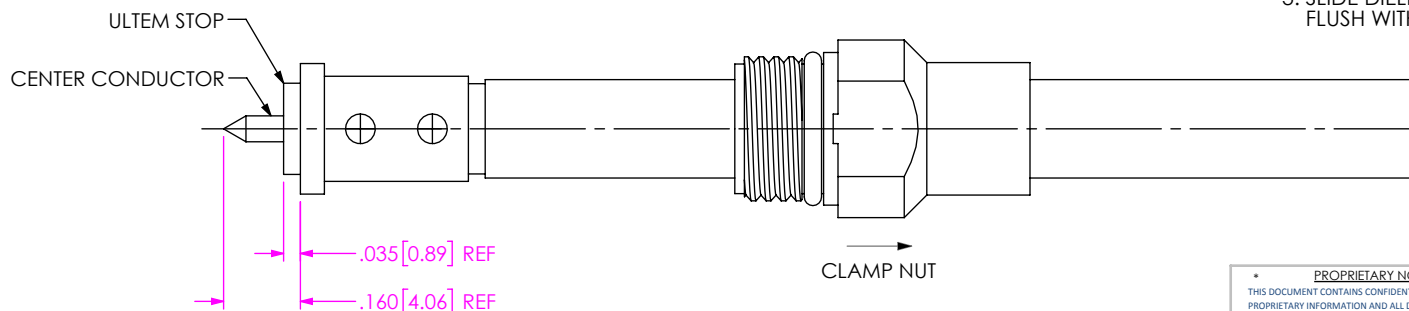

3. SLIDE DIELECTRIC STOP ONTO CABLE CENTER CONDUCTOR FLUSH WITH SOLDER FERRULE FACE.

IN-PROCESS VIEW 3

PROPRIETARY NOTE
 THIS DOCUMENT CONTAINS CONFIDENTIAL AND PROPRIETARY INFORMATION AND ALL DESIGN, MANUFACTURING, REPRODUCTION, USE, PATENT RIGHTS AND SALES RIGHTS ARE EXPRESSLY RESERVED BY SAMTEC, INC. THIS DOCUMENT SHALL NOT BE DISCLOSED, IN WHOLE OR PART, TO ANY UNAUTHORIZED PERSON OR ENTITY NOR REPRODUCED, TRANSFERRED OR INCORPORATED IN ANY OTHER PROJECT IN ANY MANNER WITHOUT THE EXPRESS WRITTEN CONSENT OF SAMTEC, INC.

DO NOT SCALE DRAWING

SHEET SCALE: 2.5:1

samtec

520 PARK EAST BLVD, NEW ALBANY, IN 47150
 PHONE: 812-944-6733 FAX: 812-948-5047
 e-Mail: info@SAMTEC.com code 55322

DESCRIPTION: N BULKHEAD JACK, SOLDER CLAMP FOR SEMFLEX HP190 CABLE

DWG. NO. PRF06-J-C-EP-190-BS

BY: CANDY W 05/13/2019 SHEET 2 OF 3

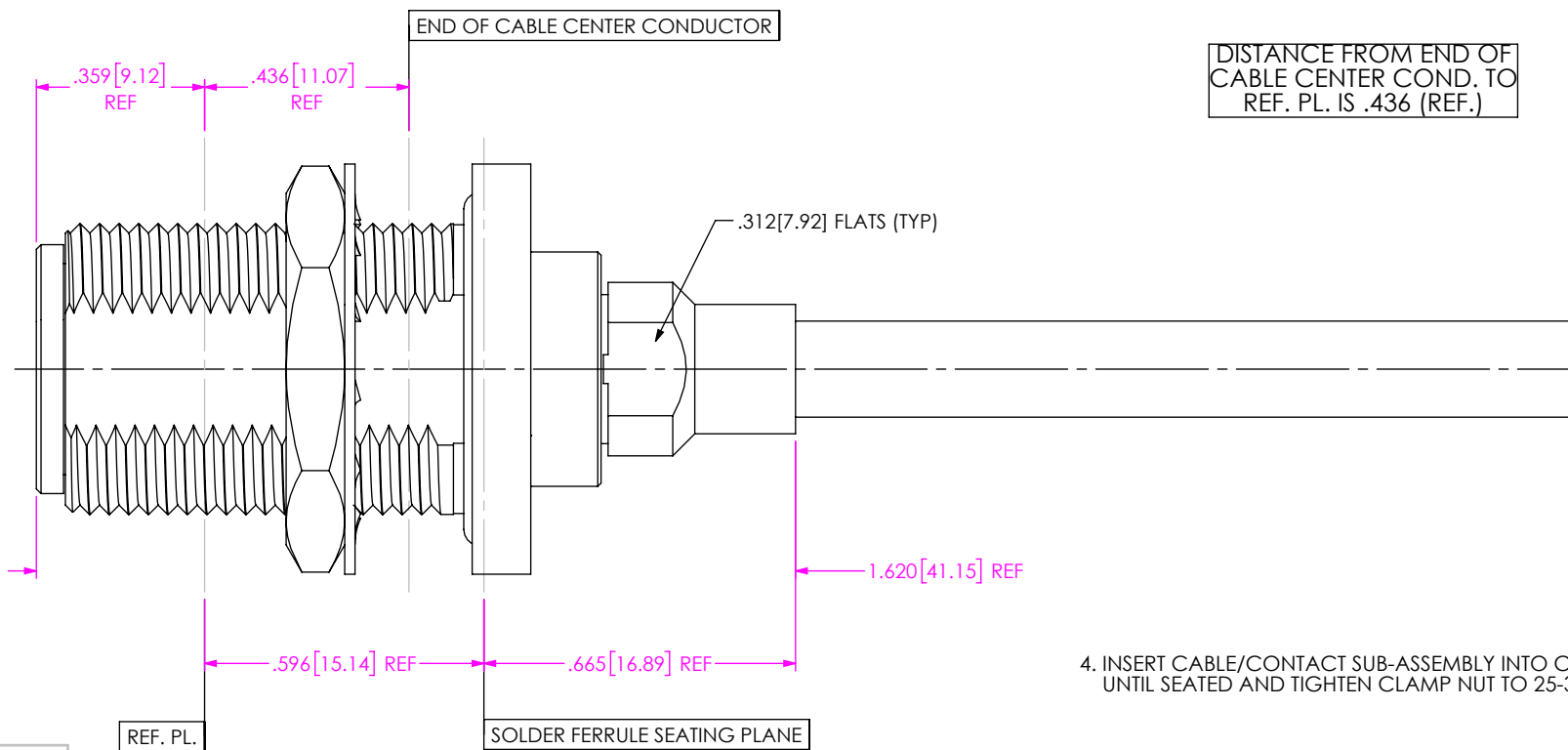

4. INSERT CABLE/CONTACT SUB-ASSEMBLY INTO CONNECTOR UNTIL SEATED AND TIGHTEN CLAMP NUT TO 25-35 IN.-LBS.

IN-PROCESS VIEW 4

• PROPRIETARY NOTE •
THIS DOCUMENT CONTAINS CONFIDENTIAL AND PROPRIETARY INFORMATION AND ALL DESIGN, MANUFACTURING, REPRODUCTION, USE, PATENT RIGHTS AND SALES RIGHTS ARE EXPRESSLY RESERVED BY SAMTEC, INC. THIS DOCUMENT SHALL NOT BE DISCLOSED, IN WHOLE OR PART, TO ANY UNAUTHORIZED PERSON OR ENTITY NOR REPRODUCED, TRANSFERRED OR INCORPORATED IN ANY OTHER PROJECT IN ANY MANNER WITHOUT THE EXPRESS WRITTEN CONSENT OF SAMTEC, INC.

DO NOT SCALE DRAWING

SHEET SCALE: 2.5:1

samtec

520 PARK EAST BLVD, NEW ALBANY, IN 47150
PHONE: 812-944-6733 FAX: 812-948-5047
e-Mail: info@SAMTEC.com code 55322

DESCRIPTION: N BULKHEAD JACK, SOLDER CLAMP FOR SEMFLEX HP190 CABLE

DWG. NO. PRF06-J-C-EP-190-BS

BY: CANDY W 05/13/2019 SHEET 3 OF 3