

DO NOT  
SCALE FROM  
THIS PRINT

TABLE 1

| TABLE 1 |               |                      |                |      |
|---------|---------------|----------------------|----------------|------|
| ITEM    | COMPONENT     | -HN                  | -GN            | *-MN |
| 1       | HEX NUT       | BTNC-NUT-001-N       |                |      |
| 2       | LOCK WASHER   | BTNC-LWAS-001-N      |                |      |
| 3       | GASKET        | BTNC-GKT-001         |                |      |
| 4       | SUB ASSEMBLY  | SUB-TNC-J-C-N-ST-BH1 |                |      |
| 5       | SKT           | BTNC-SKT-003-H       | BTNC-SKT-003-G |      |
| 6       | INSULATOR     | BTNC-INS-003         |                |      |
| 7       | INNER FERRULE | BTNC-FER-002-N       |                |      |
| 8       | OUTER FERRULE | BNC-FER-002-N        |                |      |

TNC-J-C-XX-ST-BH1

GENDER  
-J: JACK

TYPE  
-C: CABLE

TERMINATION  
-BH1: BULKHEAD 1  
(RG174 OR RG316)

ORIENTATION  
-ST: STRAIGHT

PLATING SPECIFICATION

-HN: 30μ" GOLD CENTER CONTACT,  
100μ" NICKEL OUTER CONTACT  
-GN: 10μ" GOLD CENTER CONTACT,  
100μ" NICKEL OUTER CONTACT  
\*-MN: 10μ" GOLD CENTER CONTACT,  
100μ" NICKEL OUTER CONTACT  
(SEE TABLE 1)

\*=FOR EXISTING CUSTOMERS ONLY

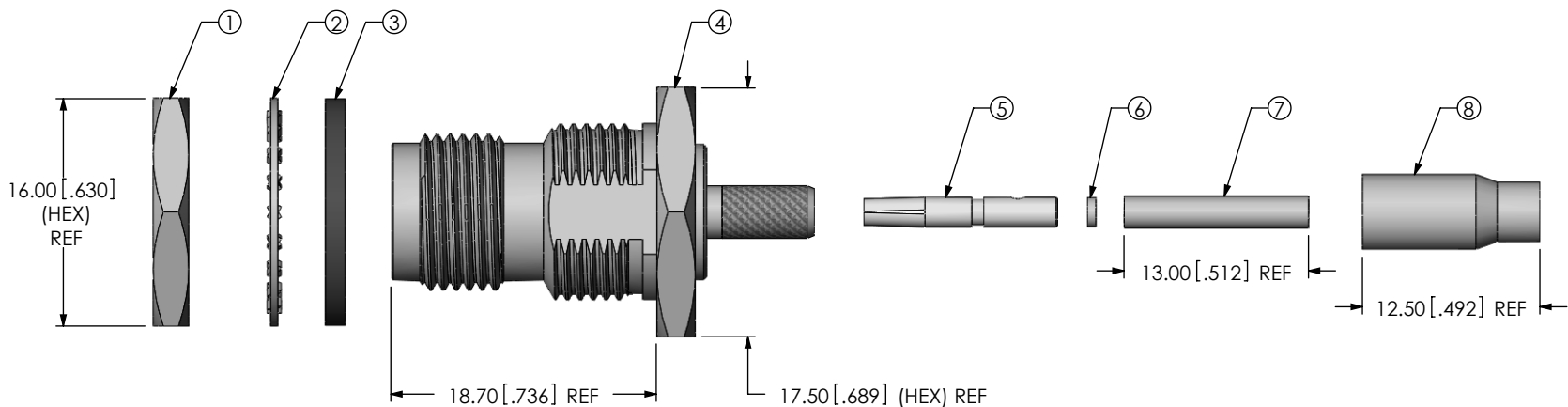

RECOMMENDED MOUNTING HOLE  
4.00 [.157] MAX PANEL THICKNESS

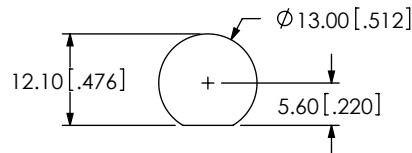

NOTES:

1. Ⓢ REPRESENTS A CRITICAL DIMENSION.
2. NOTE DELETED.
3. NOTE DELETED.
4. NOTE DELETED.
5. TO PRODUCT TO BE PACKAGED PER PACKAGING STANDARD CO-HD-WI-3040-M.
6. NOTE DELETED.
7. NOTE DELETED.
8. NOTE DELETED.
9. NOTE DELETED.

UNLESS OTHERWISE SPECIFIED  
DIMENSIONS ARE IN MILLIMETERS [INCHES]

TOLERANCES ARE:

DECIMALS ANGLES  
.X: ±0.3 [.01] 5°  
.XX: ±0.13 [.005]  
.XXX: ±0.051 [.0020]

PROPRIETARY NOTE

THIS DOCUMENT CONTAINS INFORMATION  
CONFIDENTIAL AND PROPRIETARY TO  
SAMTEC, INC. AND SHALL NOT BE REPRODUCED  
OR TRANSFERRED TO OTHER DOCUMENTS OR  
DISCLOSED TO OTHERS OR USED FOR ANY  
PURPOSE OTHER THAN THAT WHICH IT WAS  
OBTAINED WITHOUT THE EXPRESSED WRITTEN  
CONSENT OF SAMTEC, INC.

MATERIAL:

DO NOT SCALE DRAWING SHEET SCALE: 2:1  
SHELL, FERRULE, NUT, WASHER: BRASS  
CONTACT: COPPER ALLOY  
DIELECTRIC: PTFE  
GASKET: SILICON

**samtec**

520 PARK EAST BLVD., NEW ALBANY, IN 47150  
PHONE: 812-944-6733 FAX: 812-948-5047  
e-Mail: info@SAMTEC.com code 55322

DESCRIPTION:

TNC STRAIGHT CABLE JACK, RG174 & RG316 - 50 OHM

DWG. NO.

TNC-J-C-XX-ST-BH1

BY: R MUSSER

09-09-2010

SHEET 1 OF 2

# REVISION N

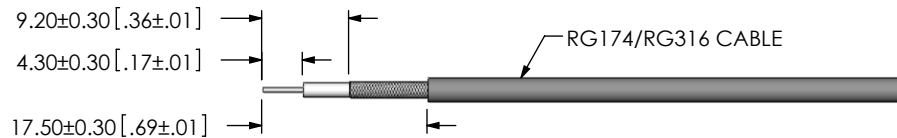

IN PROCESS 1  
STRIP AND TIN INNER  
CONDUCTOR

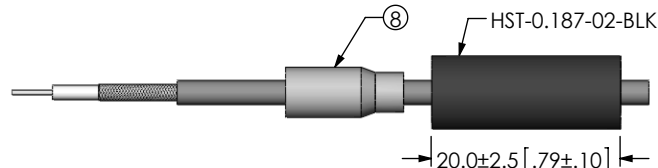

IN PROCESS 2  
ADD HEAT SHRINK  
TUBE AND FERRULE

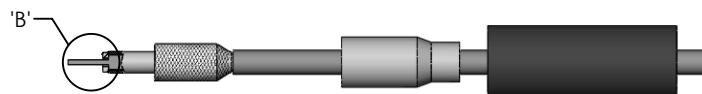

IN PROCESS 3  
FLARE SHIELD, ADD INNER  
FERRULE AND INSULATOR

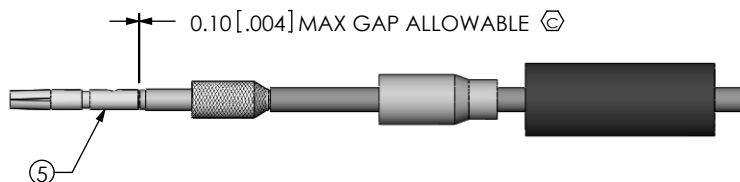

IN PROCESS 4  
SOLDER SIGNAL SOCKET

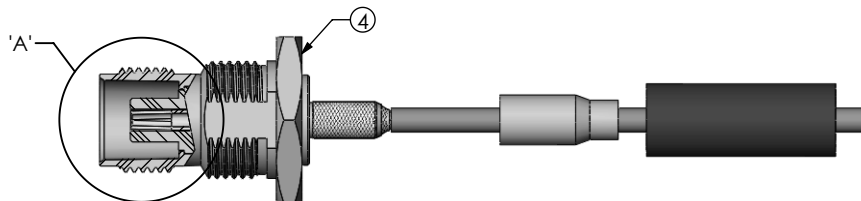

IN PROCESS 5  
ADD SUB ASSEMBLY

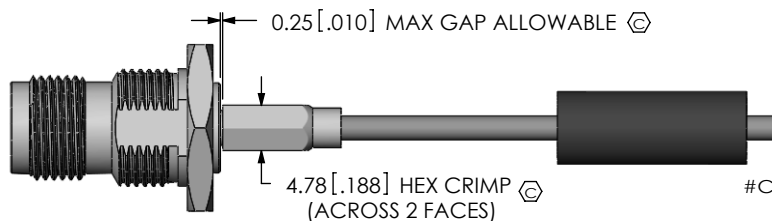

IN PROCESS 6  
CRIMP FERRULE  
(USE RF CRIMP HAND TOOL  
#CAT-HT-126667-21 OR EQUIVALENT)  
(USE .178 HEX DIE)

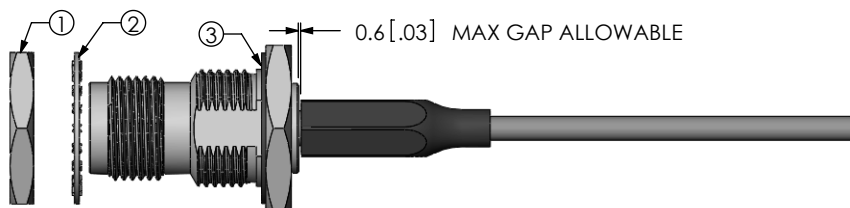

IN PROCESS 7  
APPLY HEAT SHRINK TUBE  
& ADD GASKET

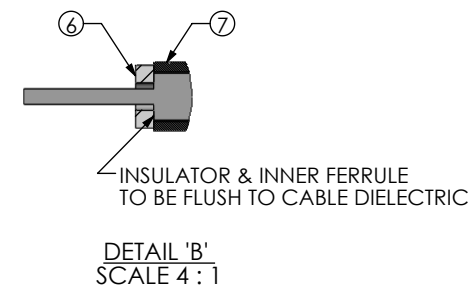
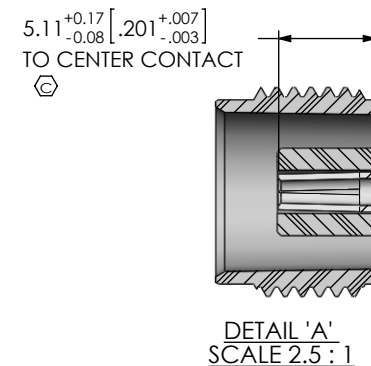

C:\EnterpriseVault\DWG\MISC\MKTG\TNC-J-C-XX-ST-BH1-MKT.SLDDRW

## PROPRIETARY NOTE

THIS DOCUMENT CONTAINS INFORMATION  
CONFIDENTIAL AND PROPRIETARY TO  
SAMTEC, INC. AND SHALL NOT BE REPRODUCED  
OR TRANSFERRED TO OTHER DOCUMENTS OR  
DISCLOSED TO OTHERS OR USED FOR ANY  
PURPOSE OTHER THAN THAT WHICH IT WAS  
OBTAINED WITHOUT THE EXPRESSED WRITTEN  
CONSENT OF SAMTEC, INC.

DO NOT SCALE DRAWING

SHEET SCALE: 5:4

**samtec**

520 PARK EAST BLVD, NEW ALBANY, IN 47150  
PHONE: 812-944-6733 FAX: 812-948-5047  
e-Mail: info@SAMTEC.com code 55322

DESCRIPTION:  
TNC STRAIGHT CABLE JACK, RG174 & RG316 - 50 OHM

DWG. NO.  
TNC-J-C-XX-ST-BH1

BY: R MUSSER 09-09-2010 SHEET 2 OF 2